



Southdown Marina | Millbrook | Torpoint | PL10 1HG

In Region Of £80,000

An outstanding conversion from fishing trawler to house boat.

This sea going vessel has been beautifully converted and restored into a fully functional house boat, offering a bright and airy wheelhouse / galley kitchen, cosy living area with log burning stove, shower room and double bedroom.

The over all presentation of this interesting home is delightful and needs to be seen to be fully appreciated.

Edna Ma is currently berthed at Southdown Marina, Millbrook, which offers all the usual marina facilities that you'd expect.

Situated within the Rame Peninsular and being within an easy commute to Plymouth City Centre.

- House Boat
- Sea Going Vessel
- One Bedroom
- Living Room With Log Burner
- Fitted Kitchen To Galley
- Recent Restoration
- Outstanding Condition

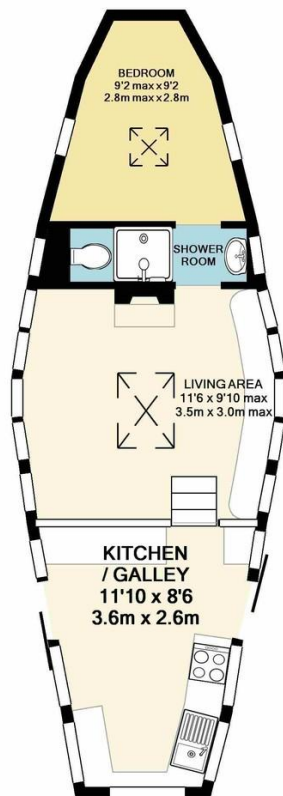
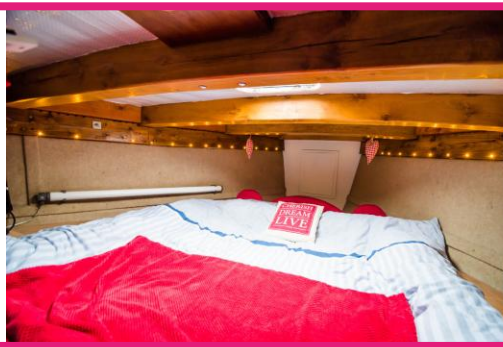

TOTAL APPROX. FLOOR AREA 290 SQ.FT. (27.0 SQ.M.)

Whilst every attempt has been made to ensure the accuracy of the floor plan contained here, measurements of doors, windows, rooms and any other items are approximate and no responsibility is taken for any error, omission, or mis-statement. This plan is for illustrative purposes only and should be used as such by any prospective purchaser. The services, systems and appliances shown have not been tested and no guarantee as to their operability or efficiency can be given
Made with Metropix ©2019

Contact Details

48 Ebrington Street
Plymouth
Devon
PL4 9AD

www.athomelettings.com
info@athomeproperty.co.uk
01752 777070



Agents Note: Whilst every care has been taken to prepare these sales particulars, they are for guidance purposes only. All measurements are approximate are for general guidance purposes only and whilst every care has been taken to ensure their accuracy, they should not be relied upon and potential buyers are advised to recheck the measurements