



Jordan Fishwick

FALLOWFIELD
Copper Place

Copper Place, Fallowfield
M14 7FZ
£140,000

The Property

NO CHAIN

A large first floor apartment set within this highly regarded gated development. Conveniently located for local amenities, Fallowfield village, Manchester City centre and Platt lane park. Comprises: secure communal entrance with lift to all floors, private hallway, open plan lounge, dining area and kitchen with French door leading to a large private balcony, master bedroom with en-suite shower room and further double bedroom and bathroom with white three piece suite and chrome fittings, attractive communal gardens. Double glazing and central heating are both installed. Secure allocated parking. Suitable for a variety of purchases including the first time buyer, professional couple or the buy to let landlord.

EPC C

Directions

- A two bedroom first floor apartment
- Secure gated development
- Private balcony
- Allocated parking
- Gas central heating and double glazing are both installed
- Ideal first time purchase or investment
- No chain

Postcode - M14 7FZ

EPC Rating - C

Floor Area - 678 sq ft

Local Authority - Manchester City Council

Council Tax - Band B

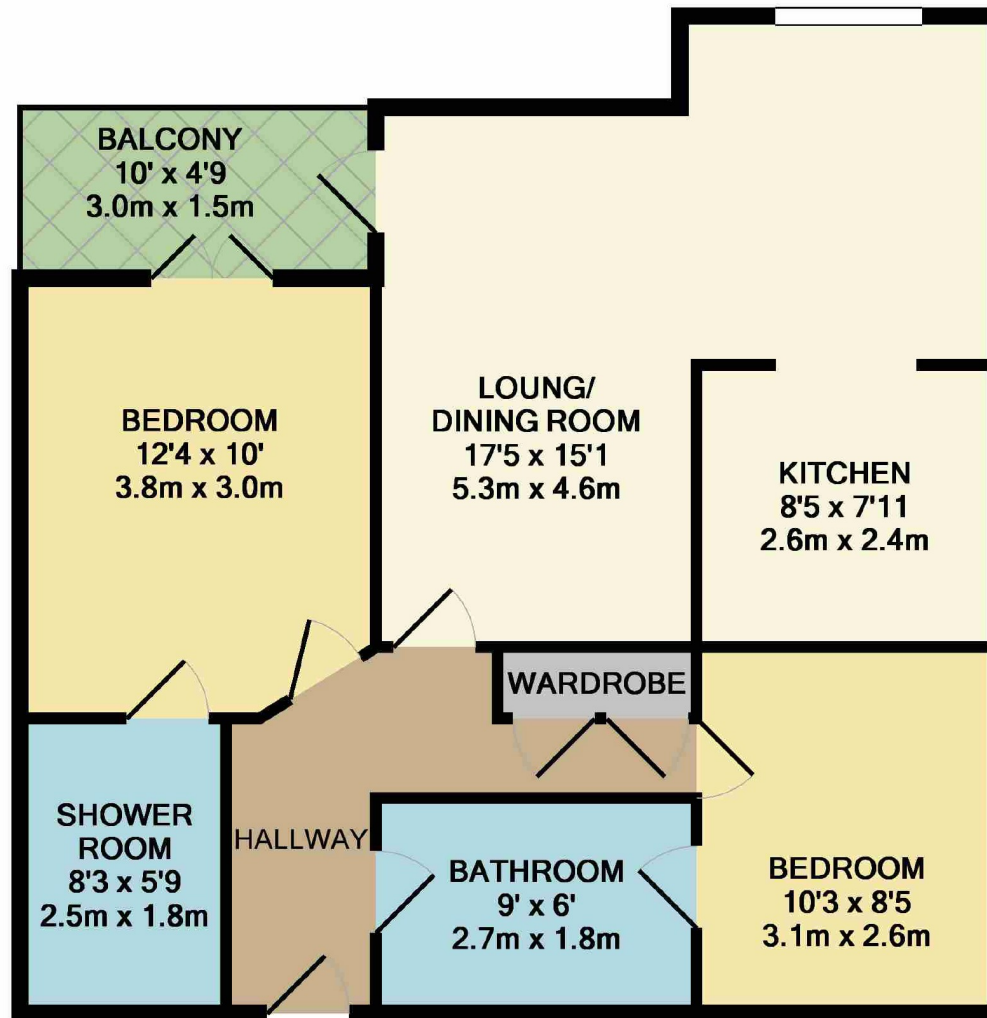

TOTAL APPROX. FLOOR AREA 670 SQ.FT. (62.2 SQ.M.)
 Measurements are approximate. Not to scale. Illustrative purposes only
 Made with Metropix ©2019



These particulars are believed to be accurate but they are not guaranteed and do not form a contract. Neither Jordan Fishwick nor the vendor or lessor accept any responsibility in respect of these particulars, which are not intended to be statements or representations of fact and any intending purchaser or lessee must satisfy himself by inspection or otherwise as to the correctness of each of the statements contained in these particulars. Any floorplans on this brochure are for illustrative purposes only and are not necessarily to scale.

Offices also at: Wilmslow, Macclesfield, Hale, Sale, Chorlton, Glossop, Manchester & Salford

757-759 Wilmslow Road, Didsbury Village, Manchester

0161 445 4480

didsbury@jordanfishwick.co.uk
 www.jordanfishwick.co.uk