



45 NIGHTINGALE AVENUE, CAMBRIDGE, CB1 8SG

Offers In Region Of £1,100,000

[TYLERS.NET](https://www.tylers.net)

EXCELLENT ACCESS TO ADDENBROOKES - A versatile four bedroom detached residence with self contained annex and generous garden facing open recreation grounds.



NIGHTINGALE AVENUE is a distinguished South City address located between Banbaham Road and Queen Ediths Way only a short stroll from Addenbrookes Hospital. Nearby Schooling is at The Perse and either Long Road or Hills Road Sixth Form Colleges. Facing onto the expansive Nightingale recreation ground, this is arguable one of the finest locations in the city.

- * Four good bedrooms
- * Cloakroom with 2nd WC
- * Sitting room with Bay Window
- * Versatile Family Room with feature fireplace
- * Conservatory
- * Kitchen/Diner
- * Utility & Study

THE PROPERTY offers four bedrooms and three/four reception rooms with the benefit of a self contained annexe and a total of 189 sq m (2039 sq foot), plus a conservatory. An ideal family home with separate living accommodation for a relative or let separately for a home with an income.

ANNEXE

Comprising a long bed/sitting rom, shower, WC, and kitchen/diner with own personal access at the front of the property.

PLANNING PERMISSION has been obtained (granted Jan 2018) to demolish the existing home and replace it with two three-storey properties each of approx. 212 sq m (2290 sq foot) - full details can be found via the Cambridge City Council planning portal ref: 17/2261/FUL

OUTSIDE

A broad front block paved garden measures approx 16m wide (52') x 13m (42') max depth providing ample off road parking. A long rear garden measures approx 17.5m (57') wide x 22m (73') deep offering further potential to become a fantastic family space.

Council tax band F - £2,469.00 for 2018/2019

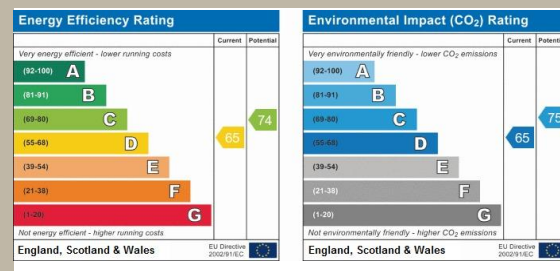

Cambridge
104 Cherry Hinton Road
Cambridge CB1 7AJ
01223 214400

Histon
19 High Street, Histon
Cambridge CB24 9JD
01223 235111

Willingham
Stocks Corner, High Street
Willingham, Cambs CB24 5ES
01954 260952

Newmarket
16a High Street
Newmarket, Suffolk CB8 8LB
01638 660303

hello@tylers.net | **TYLERS.NET**

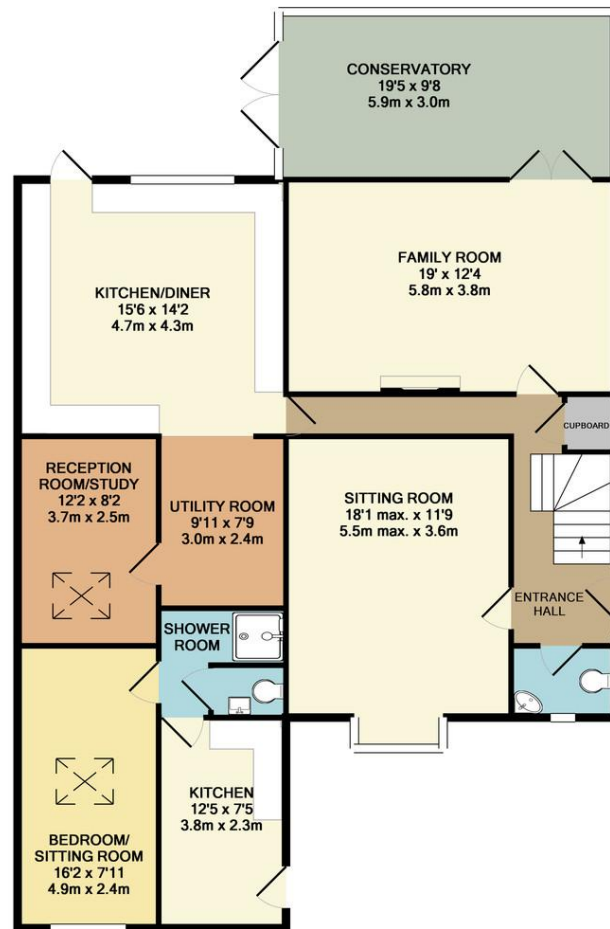

GROUND FLOOR

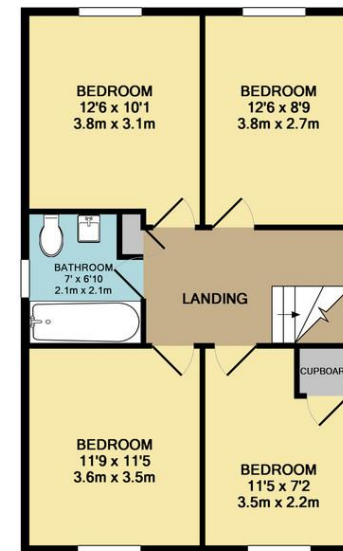

1ST FLOOR



Whilst every attempt has been made to ensure the accuracy of the floor plan contained here, measurements of doors, windows, rooms and any other items are approximate and no responsibility is taken for any error, omission or mis-statement. This plan is for illustrative purposes only and should be used as such by any prospective purchaser. The services, systems and appliances shown have not been tested and no guarantee as to their operability or efficiency can be given.

As the sellers agent we are not surveyors or conveyancing experts and as such we cannot and do not comment on the condition of the property, or issues relating to title or other legal issues that may affect this property, unless we have been made aware of such matters. Interested parties should employ their own professionals to make such enquiries before making any transactional decisions. Tylers for themselves and for the Vendors or Lessors of this property declare that these particulars are given as a general outline and whilst intended to be accurate do not constitute nor form any part of an offer or contract. Intending purchasers or tenants must satisfy themselves by personal inspection or otherwise as to the correctness of each statement. Fixtures, fittings and appliances have not been tested by Tylers. No person in the employment of Tylers has the authority to make or give any representation or warranty whatsoever in relation to this property. All measurements are approximate.



Tylers Independent Estate Agents is a trading name of Tylers Property Partnership Ltd
Registered address; Salisbury House, Station Road, Cambridge, CB1 2LA Company Number 7535939 VAT Number 934 673 206

