



Hathaway, 8a Cherry Hill Road, Barnt Green, B45 8LH | Offers Over £599,000
Spacious Three Bedroom Detached Bungalow

Summary:

Generously sized three bedroom bungalow with south facing garden and scope to create extra bedrooms within spacious loft of approximately 839 sq. ft (subject to planning permission), located on one of Barnt Green's most prestigious roads.

Description:

The accommodation features: Covered porch, entrance vestibule, inner hall, kitchen diner and laundry room, bedroom three/office with access to shower room, dining room, lounge with feature electric fire, further hall leading to master bedroom suite with dressing area and en suite shower room, further double bedroom and house bathroom.

The property also benefits from a well-proportioned boarded loft space (currently accessed via a pull down ladder) which has the potential to create further accommodation (subject to planning permission).

Outside:

Externally, the property features a south facing rear garden with patio area, lawn and hedged boundaries. Parking includes a good sized driveway and double garage (with electric door).

Location:

Barnt Green is a delightful village with local shopping facilities, doctor's surgery, two churches, dentist, local school and train station. There are many sporting facilities including a cricket club, the renowned Blackwell Golf Club, sailing and many other clubs and societies. There is easy access to M5/M42 motorway links, Birmingham Airport and Birmingham City Centre is approximately twelve miles away.



Room Dimensions:

Lounge:

17' 8" x 13' 10" (5.39m x 4.24m)

Dining Room:

16' 7" x 10' 7" (5.08m x 3.24m)

Breakfast Kitchen:

19' 9" (max) x 16' 1" (max) (6.03m x 4.92m)

Laundry Room:

7' 10" x 5' 11" (2.39m x 1.82m)

Master Bedroom:

14' 6" x 11' 3" (4.42m x 3.43m)

En Suite:

8' 8" x 6' 8" (2.65m x 2.04m)

Bedroom Two:

11' 2" (into bay) x 15' 0" (3.41m x 4.58m)

Bedroom Three:

9' 9" x 12' 0" (2.98m x 3.68m)

Shower Room:

4' 9" x 11' 5" (1.47m x 3.50m)

Double Garage:

19' 3" x 18' 4" (5.89m x 5.61m)

Loft:

16' 5" x 53' 2" (5.02m x 16.21m)



EPC: D

Council Tax Band: G

Tenure: Freehold

For more information on Cherry Hill Road or to arrange a viewing, please call the Barnt Green Office on 0121 447 8300

Cherry Hill Road, Barnt Green Loft Space



Cherry Hill Road, Barnt Green Loft Space



Bungalow

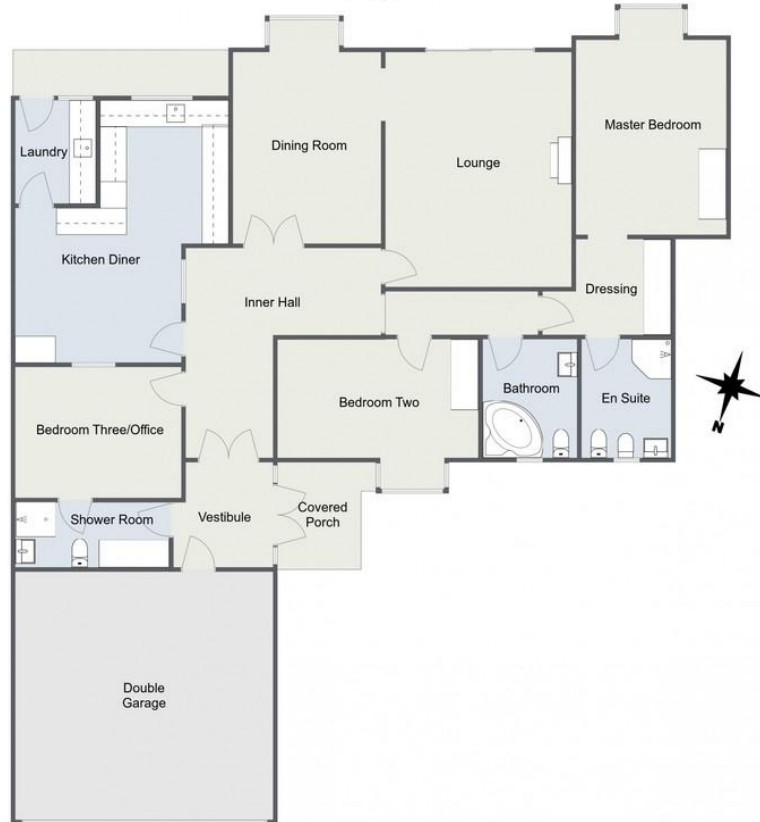

Total Approximate Area (Excluding Loft Space): 201 sq. m (2,163.55 sq. ft)

For illustrative purposes only. Decorative finishes, fixtures & fittings do not represent the current state of the property. Measurements are approximate & not to scale.
Floor Plans made using RoomSketcher.

Bungalow



Total Approximate Area (Excluding Loft Space): 201 sq. m (2,163.55 sq. ft)

For illustrative purposes only. Decorative finishes, fixtures & fittings do not represent the current state of the property. Measurements are approximate & not to scale.
Floor Plans made using RoomSketcher.

Please read the following: These particulars are for general guidance only and are based on information supplied and approved by the seller. Complete accuracy cannot be guaranteed and may be subject to errors and/or omissions. They do not constitute a contract or part of a contract in any way. We are not surveyors or conveyancing experts therefore we cannot and do not comment on the condition, issues relating to title or other legal issues that may affect this property. Interested parties should employ their own professionals to make enquiries before carrying out any transactional decisions. Photographs are provided for illustrative purposes only and the items shown in these are not necessarily included in the sale, unless specifically stated. The mention of any fixtures, fittings and/or appliances does not imply that they are in full efficient working order and they have not been tested. All dimensions are approximate. We are not liable for any loss arising from the use of these details.