



## Royal Quay, Harefield UB9 6FG

---

**Guide price £1,475 per month** (Fees Apply)

Available 04/04/2019: Unfurnished





## Guide Price: £1,475 per month

(Fees apply)

### Royal Quay Harefield UB9 6FG

---

- Two double bedrooms
  - Modern kitchen with appliances
  - Living room
  - Bathroom suite with separate shower cubicle
  - Features fitted wardrobes
  - Allocated parking space
  - Part furnished
  - EPC Rating = B
- 

This superbly presented and finished to the highest of specification, two double bedroom, luxury apartment is located in a picturesque setting overlooking the Grand Union Canal. Accommodation comprises of entrance hall leading to open plan kitchen / living space with appliance included, two double bedrooms with fitted wardrobes and a modern bathroom suite featuring a separate shower cubicle, bath, hand basin and w/c. The property also benefits from an allocated parking space outside the property. The property is located on Royal Quay, just off of Summerhouse Lane in Harefield, overlooking the Grand Union Canal. Further Details Local authority: London Borough of Hillingdon Council Tax: £1460.15 per year (Band D)



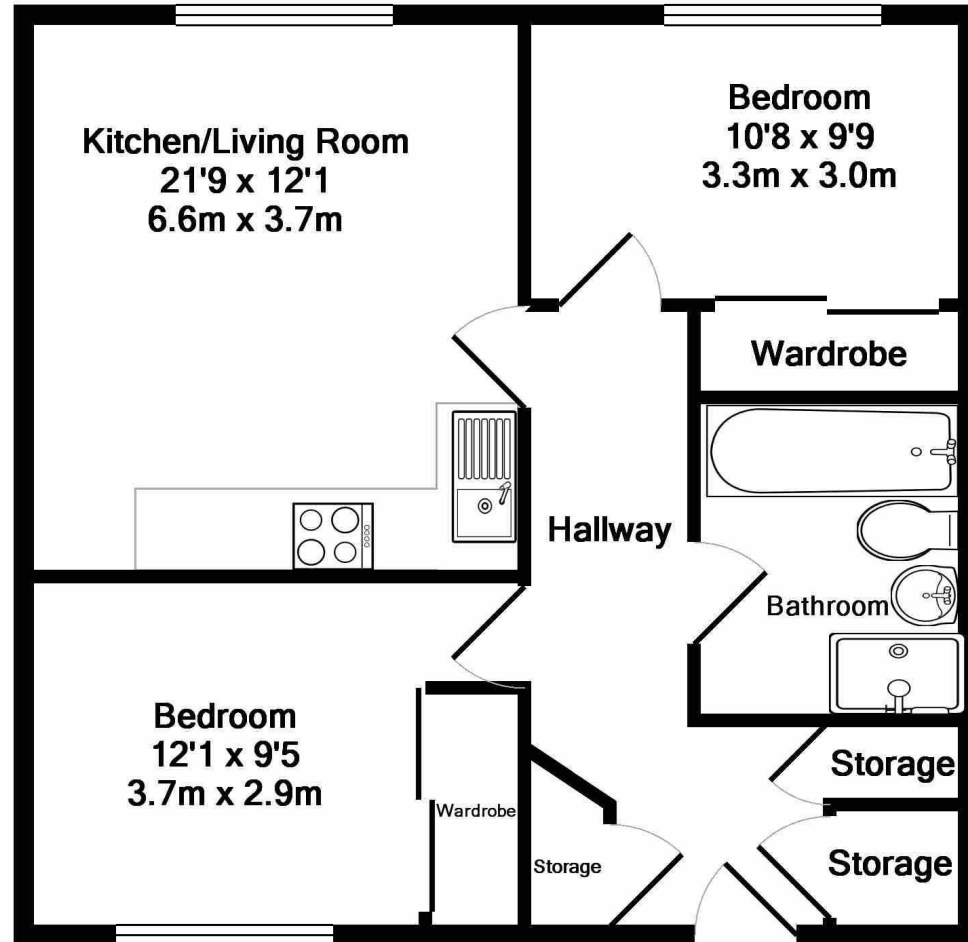

**TOTAL APPROX. FLOOR AREA 508 SQ.FT. (47.2 SQ.M.)**

Whilst every attempt has been made to ensure the accuracy of the floor plan contained here, measurements of doors, windows, rooms and any other items are approximate and no responsibility is taken for any error, omission, or mis-statement. This plan is for illustrative purposes only and should be used as such by any prospective purchaser. The services, systems and appliances shown have not been tested and no guarantee as to their operability or efficiency can be given

Made with Metropix ©2019



## Ruislip Lettings

90 High Street  
Ruislip  
London  
HA4 8LT

T: 01895 622884

[ruisliplettings@gibbs-gillespie.co.uk](mailto:ruisliplettings@gibbs-gillespie.co.uk)

[gibbs-gillespie.co.uk](http://gibbs-gillespie.co.uk)



### Important Notice

We have prepared these property particulars as a general guide to a broad description of the property. They are not intended to constitute part of an offer or contract. We have not carried out a structural survey and the services, appliances and specific fittings have not been tested. All photographs, measurements, floorplans and distances referred to are given as a guide only and should not be relied upon for the purchase of carpets or any other fixtures and fittings. Lease details, service charges and ground rent (where applicable) and council tax are given as a guide only and should be checked and confirmed by your Solicitor prior to exchange of contracts. The copyright of all details, photographs and floorplans remain exclusive to Gibbs Gillespie.