



- Detached Bungalow
- Flat South Facing Garden
- Set Back Away from the Road
- Quiet Location
- Garage & Driveway
- Two Double Bedrooms
- Lounge Diner & Kitchen
- Family Bathroom
- Close to Local Transport Routes
- Two Lean-to Storage Rooms

Property Summary

This is a rare opportunity to purchase this two bedroom detached bungalow in the Hemerdon Heights area of Plympton and it is a must view. The property accommodation offers two double bedrooms, a lounge diner with doors out to the garden, kitchen, a family bathroom, and two lean-to storage rooms which are attached to the bungalow.

Many of the bungalows in the row have been extended with conservatories or sun rooms, this property would also see the benefit should you wish to add one as the south facing garden makes the most of having sun throughout the day. On the road there is a garage and driveway at the front of the property. The bungalow itself is slightly set back giving you a really quiet location.



Ground Floor

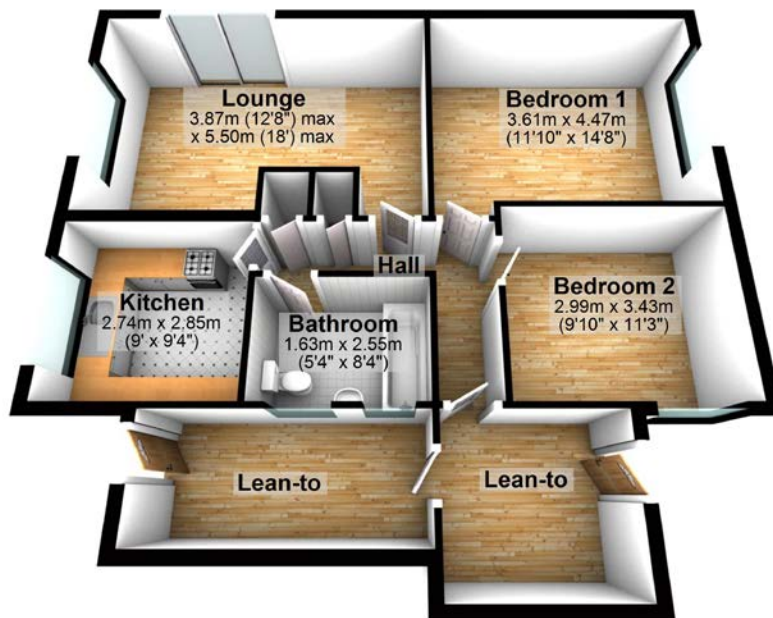

Directions

From the Maitlands Plympton office, take the first exit off the first roundabout, and the second off the next onto Glen Road. Go straight across the next two roundabouts, then take the second left into Westfield. Follow the road around to the left and you will arrive at Hemerdon Heights. As you enter Hemerdon Heights take the first turning on the right, and the bungalow is on the right hand side.

EPC Rating: D Tenure: Freehold

Available for viewing 7 days a week.

Contact us today.

Maitlands Plympton

t: 01752 344322

e: plympton@maitlands.biz

3 Plymouth Road, Plympton, PL7 4JP

www.maitlands.biz

The vendor has advised us that the information contained within these particulars is correct to the best of the vendors knowledge. With regard to appliances and electrical installations, we have not tested any items detailed in these particulars and any prospective purchaser should satisfy themselves with regard to their condition. All fixtures and fittings as mentioned in our sales particulars are included; all others are expressly excluded. All measurements are approximate. All floor plans of properties are not drawn to scale and are for information only.



Want to know more?

We recognise that buying a property is a big commitment and therefore recommend that you visit the following websites for further information about the property and local area.

www.environment-agency.gov.uk

www.landregistry.gov.uk

www.plymouth.gov.uk or www.southhams.gov.uk