



High Street | Lavenham | CO10 9PT

£950 pcm

Available January is this charming terraced cottage situated in the heart of Lavenham. The property benefits from a living room and kitchen/dining room on the ground floor, two bedrooms and bathroom and bathroom on the first floor and a further bedroom on the second floor. Private rear garden and on-road parking available. Call now to secure a viewing!

- Available January
- Three Bedrooms
- Kitchen/Dining Room
- Rear Garden
- Popular Village Location
- On Road Parking

ENTRANCE/HALLWAY Front door opening to hallway. Door into living room and stairs to the first floor.

LIVING ROOM 11' 2" x 12' 8" (4.06m x 5.87m)
Window to front aspect. Door leading to kitchen and a second door to entrance hall/stairs. Brick chimney breast with feature fireplace. Radiator.

KITCHEN 14' 1" x 11' 7" (4.57m x 5.36m)
Matching wall and base units with work surface over. Integrated oven and hob. Sink with half bowl and drainer. Built in fridge, freezer and washing machine. Stable door leading to back garden and door to under stairs cupboard. Tiled floor.

BEDROOM ONE 12' 9" x 11' 3" (6.15m x 3.43m)
Window to front. Stairs to third bedroom/study. Feature fireplace.

BEDROOM TWO 11' 7" x 7' 7" (5.28m x 3.99m)
Window to rear with radiator below. Feature fireplace. Integrated wardrobe.

BEDROOM THREE/STUDY 13' 6" x 12' 7" (5.66m x 5.56m) Large velux window. Three storage cupboards. Brick chimney breast feature.

BATHROOM 8' 4" x 6' 0" (3.63m x 2.06m)
Pedestal sink with single taps over. Toilet with wooden seat. Wood panelled bath with taps over. Electric shower over with hose and shower head attachment. Window to rear.

GARDEN Fencing surround. Pathway leading to shed at rear of the garden. Laid to shingle.

Local Authority – Babergh District Council
Council Tax Band – C
Post Code – CO10 9PT

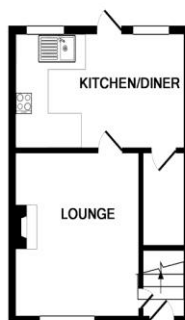

GROUND FLOOR



1ST FLOOR



2ND FLOOR



Contact Details

6 King Street, Sudbury, Suffolk, CO10 2EB

Tel: 01787 468400

Email: sudbury@bychoice.co.uk

Agents Note: Whilst every care has been taken to prepare these sales particulars, they are for guidance purposes only. All measurements are approximate and for general guidance purposes only and whilst every care has been taken to ensure their accuracy, they should not be relied upon and potential buyers are advised to recheck the measurements

