



LLOYDS
PROPERTY GROUP

3A TURKS LANE
Whitecliff • Poole • Dorset

LLOYDS
PROPERTY GROUP



**3A Turks Lane
Whitecliff, Poole, Dorset BH14 8EW**

Price Guide £925,000

A striking four double bedroom, contemporary family home comprising of over 1,900 sq ft of spacious accommodation set over two floors.

Accommodation

Four double bedrooms • Three bathrooms (two en-suite)
Open plan high quality kitchen/dining room • Living room • Large reception hall
Integral garage • WC/lobby



Welcome to 3A Turks Lane ...

The property is beautifully presented and enjoys a perfect position with views spanning across Whitecliff Harbourside Park – perfect for walks along the harbour.

3A Turks Lane lends itself perfectly to family living with all living quarters set out over two floors. The driveway has ample space for numerous vehicles. The private rear garden is tastefully decked with a patio area and artificial grass has been laid for ease of maintenance.

The Area

Nestled between Poole and the Sandbanks Peninsula the area boasts Blue Flag sandy beaches several yacht clubs offering all classes of sailing and racing, marinas with stunning super yachts and an array of water sports. The shallow harbour lends itself perfectly to kitesurfing and windsurfing. The local area offers an exceptional cafe culture, excellent restaurants and boutique shopping.

Lilliput amenities are a short walk away and Ashley Cross is close by offering a variety of coffee shops, restaurants, bars and hair & beauty salons with Bournemouth and Poole town centres also within easy reach with a wider range of high street shops and entertainment facilities. The nearby Parkstone Bay marina is a modern and spacious marina, alongside a variety of berthing options. Services include boat lifting, fuel facilities, boat sales, membership boating schemes, RYA training, marine services and the popular waterside brasserie South Deep Café.

South Deep Café offers spectacular sea views, al fresco dining and an elegant cosy restaurant with fire-side dining. The talented chefs create locally sourced dishes with a Mediterranean influence, perfect for every occasion - all within a couple of minutes walk from the property.



Whitecliff Park opposite property



Whitecliff Park opposite property

3a Turks Lane, Whitecliff

Approximate Gross Internal Area :- 180 sq m / 1941 sq ft

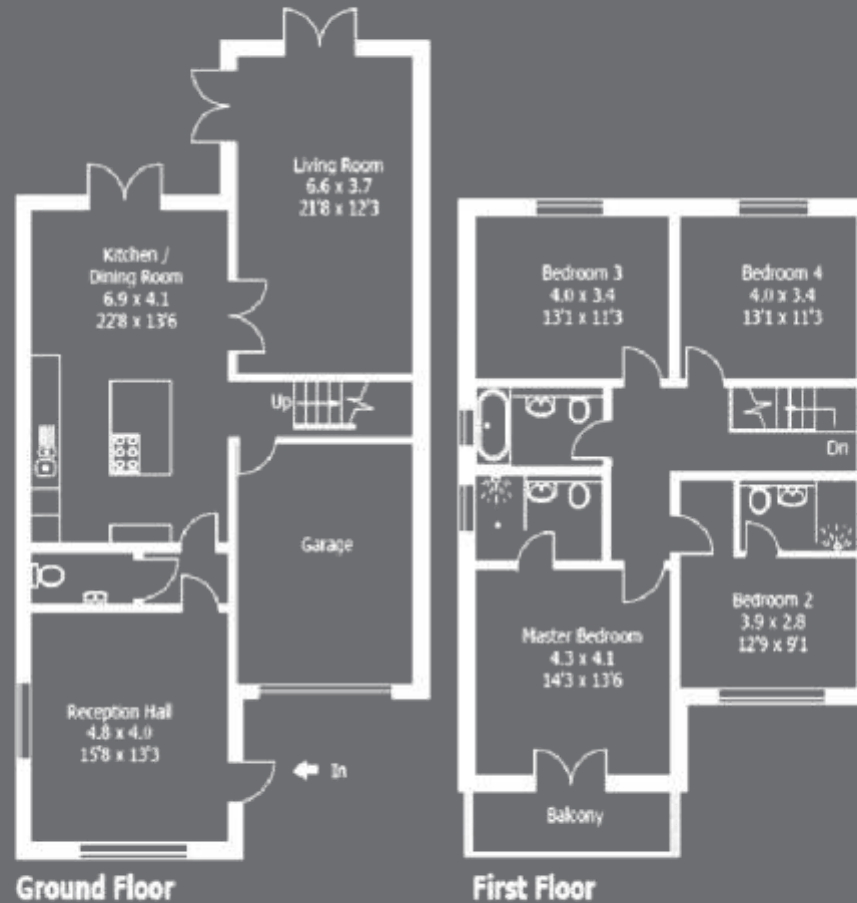

For identification purposes only, not to scale
Created using existing drawings and dimensions

Viewing: Strictly by prior appointment through sole selling agents Lloyds
VIEWING 7 DAYS A WEEK. Ref: 3217

Important Notice

Lloyds, their clients and any joint agents give notice that:

1. They have no authority to make or give any representation or warranties in relation to the property. These particulars do not form part of an offer or contract and must not be relied upon as statements or representations of fact.
2. Any areas, measurements or distances are approximate. The text, photographs and plans are for guidance only and are not necessarily comprehensive. It should not be assumed that the property has all necessary planning, building regulation or other consents and Lloyds have not tested any services, equipment or facilities. Purchasers must satisfy themselves by inspection or otherwise.



LLOYDS
PROPERTY GROUP