



30 Wadsley Lane, Wadsley, Sheffield, S6 4EB  
Price £220,000

## 30 Wadsley Lane

Wadsley

Price £220,000

**\*\* FREEHOLD\*\* NO CHAIN \*\*** A stunning five bedroom semi-detached family home benefiting from gas fired central heating and uPVC double glazing throughout. The accommodation briefly comprises: lounge with period fire surround, tiled insert, hearth and electric coal effect fire, dining room with period fire surround, cellar head and cellar, breakfasting kitchen with a range of units and integrated oven, utility room and a downstairs WC. Upstairs on two floors: Five excellent bedrooms, the master benefiting from an en-suite shower room with shower cubicle, electric shower, WC and wash basin. Family bathroom in addition with panelled bath, shower attachment, WC and wash basin.

- FIVE BEDROOM SEMI DETACHED PROPERTY
- TWO BATHROOMS
- DOUBLE GARAGE
- OFF ROAD PARKING
- EASILY MAINTAINED GARDEN
- POPULAR RESIDENTIAL AREA







Outside: To the front there is a vehicular driveway for parking several cars which leads alongside the house to the garage. There is a patio to the side. To the rear is an easily maintained garden, mainly patio with limestone area. Outside security lighting. Double garage.

Located in this popular residential area of Wadsley with excellent amenities close-by. Regular public transport. Local park. Easy access to hospitals., universities and Sheffield City Centre. EPC Rating: F.

Whilst we endeavour to make our sales particulars fair, accurate and reliable, they are only a general guide to the property. If there is any point which is of particular importance to you, please contact the relevant office. The Agents have not tested any apparatus, equipment, fittings or services and so cannot verify they are in working order. The buyer is advised to obtain verification. All plans, floor plans and maps are for guidance purposes only and are not to scale. Please note all measurements are approximate and should not be relied upon as exact. Under no circumstances should they be relied upon as exact or for use in planning carpets and other such fixtures, fittings or furnishings. YOUR HOME IS AT RISK IF YOU DO NOT KEEP UP REPAYMENTS ON A MORTGAGE OR OTHER LOAN SECURED ON IT.

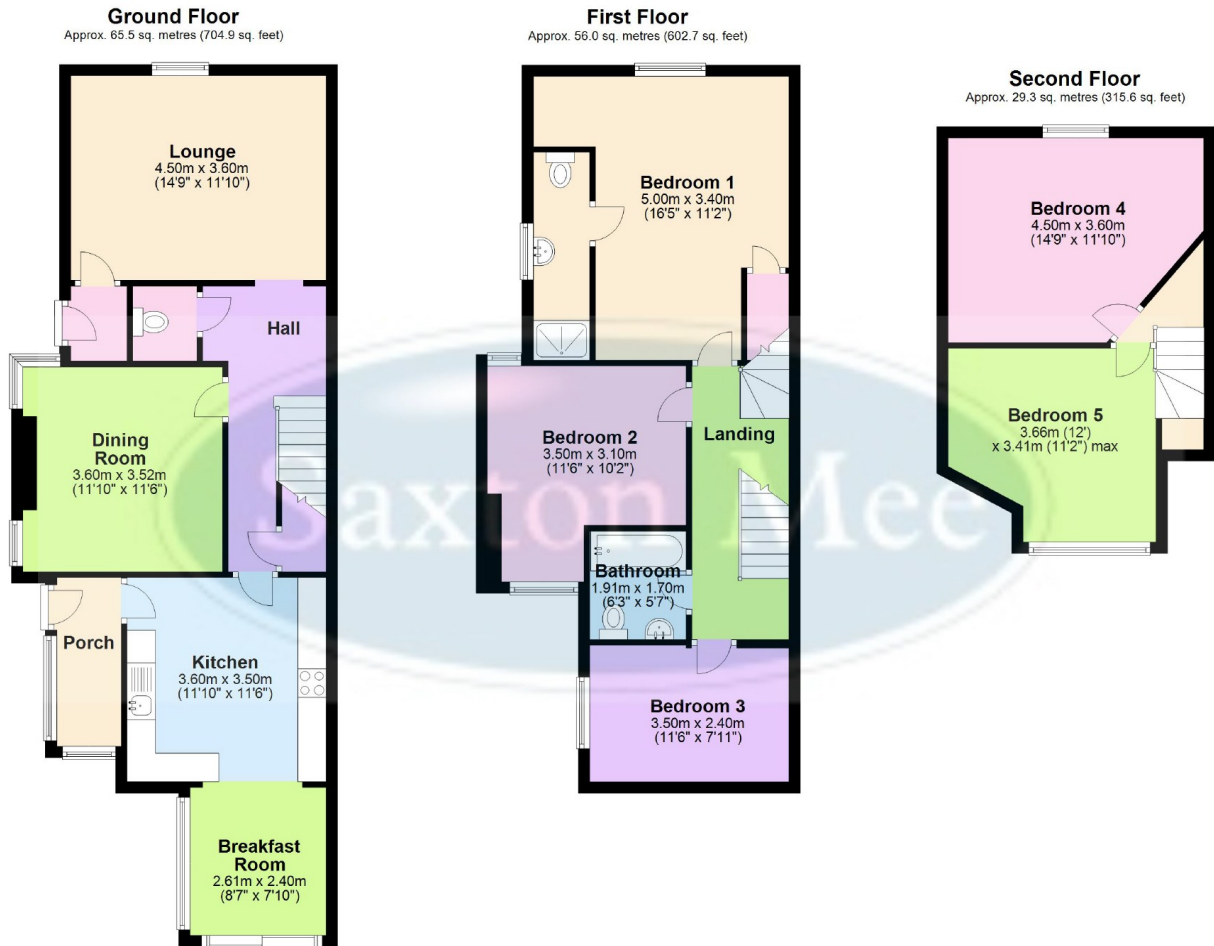

Total area: approx. 150.8 sq. metres (1623.3 sq. feet)

Floor plans are for guidance purposes only and under no circumstances should they be relied upon for use in planning carpets and other such fixtures fittings or furnishings All measurements are approximate.  
Plan produced using PlanUp.

**Crookes  
Hillsborough  
Stocksbridge**

245 Crookes, Sheffield S10 1TF  
82 Middlewood Road, Sheffield S6 4HA  
462 Manchester Road, Sheffield S36 2DU

T: 0114 266 8365  
T: 0114 231 6055  
T: 0114 287 0112

[www.saxtonmee.co.uk](http://www.saxtonmee.co.uk)

