

Saxton Mee



**Hawthorne House, 250 High Greave, Ecclesfield,
Sheffield, S5 9GR**

Offers around £325,000 to £350,000

St Luke's
Sheffield's Hospice

250 High Greave

Ecclesfield

Offers around £325,000 to £350,000

PRICE GUIDE £325,000-£350,000 ****FREEHOLD**** ****TRULY DESERVING AN INTERNAL INSPECTION**** SET IN STUNNING GROUNDS IS THIS DETACHED FOUR/FIFTH OCCASIONAL BEDROOM STONE FARMHOUSE DATING BACK TO THE 1800's. The accommodation includes three reception rooms, breakfasting kitchen with oven, hob and extractor hood. Cellar. A central staircase rises to two floors with master bedroom and bathroom with Victorian style bath and claw bath, WC and washbasin set on a plinth. Walk in shower. Two further bedrooms. Second floor: further bedroom and occasional bedroom 5 perfect for study etc.

- STONE FARMHOUSE
- 4/5 BEDROOMS
- STUNNING LARGE GARDENS
- DATING BACK TO THE 1800'S
- SPACIOUS FOUR PIECE BATHROOM





Set in stunning large gardens. To the front is a large lawned garden and mature hedging and trees. Turning circle with cobbles and a natural stone path. Large rear lawned garden with a large stone flagged patio area and beautiful planted borders which give a good degree of privacy. Further sitting out patio and a large lawn. Large garage with stable style door to the side.

With excellent shopping facilities close by including a large Morrisons. Close to all facilities at Ecclesfield. Local schools. Excellent public transport links. Easy access to Sheffield City Centre, central Hospitals and Universities. EPC rating D.

Whilst we endeavour to make our sales particulars fair, accurate and reliable, they are only a general guide to the property. If there is any point which is of particular importance to you, please contact the relevant office. The Agents have not tested any apparatus, equipment, fittings or services and so cannot verify they are in working order. The buyer is advised to obtain verification. All plans, floor plans and maps are for guidance purposes only and are not to scale. Please note all measurements are approximate and should not be relied upon as exact. Under no circumstances should they be relied upon as exact or for use in planning carpets and other such fixtures, fittings or furnishings. YOUR HOME IS AT RISK IF YOU DO NOT KEEP UP REPAYMENTS ON A MORTGAGE OR OTHER LOAN SECURED ON IT.

Ground Floor
Approx. 69.5 sq. metres (747.7 sq. feet)

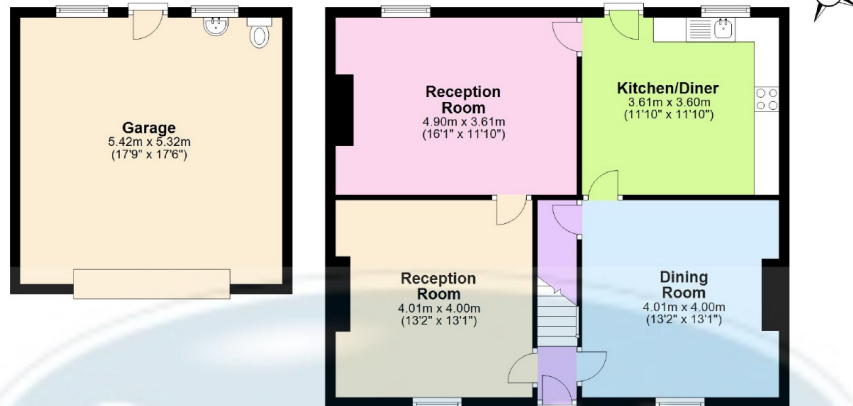

First Floor
Approx. 69.4 sq. metres (747.5 sq. feet)



Second Floor
Approx. 41.6 sq. metres (447.8 sq. feet)

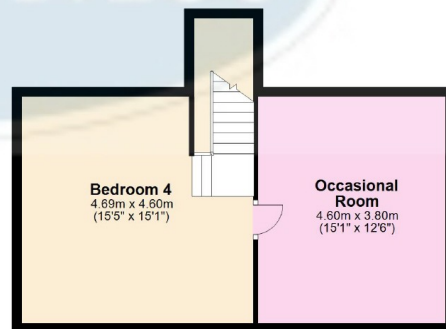

Total area: approx. 180.5 sq. metres (1943.0 sq. feet)

Floor plans are for guidance purposes only and under no circumstances should they be relied upon for use in planning carpets and other such fixtures fittings or furnishings. All measurements are approximate.
Plan produced using PlanUp.

Crookes
Hillsborough
Stocksbridge

245 Crookes, Sheffield S10 1TF
82 Middlewood Road, Sheffield S6 4HA
462 Manchester Road, Sheffield S36 2DU

T: 0114 266 8365
T: 0114 231 6055
T: 0114 287 0112

www.saxtonmee.co.uk

