



Abito, Greengate, Salford
Offers In The Region Of £115,000

Ascend
Built on higher standards

Abito, Greengate, Salford

Abito is a striking building right in the heart of Manchester. with only an 8 minute walk - 0.4 Miles to some of the greatest shops and restaurants, everything you need is on your door step.

Take a step inside and you're immediately presented with a bright open space with floor to ceiling windows, flooding the apartment with natural light and presenting cracking waterside views over The Quay. You'll benefit from a contemporary design throughout along with a fully integrated kitchen, ultra-modern bathroom and a nifty pull-down bed.

Living at Abito, you really are right in the thick of all the action. The development is perfectly placed just along the River Irwell and is right beside Manchester city centre; where there are that many bars, cafes, restaurants, shops and cultural attractions you'll be spoilt for choice!

Northern Quarter is also just a stone's throw away and is renowned for its suburban vibe and rustic charm. It has an independent nightlife that rivals the city centre big players and a great social scene with a huge range of bars & restaurants right on the doorstep.

If you're interested in having a closer look, or have any questions, do get in touch. And just so you know, the pictures for this apartment are for marketing purposes only. The internal fixtures, fittings and furnishings may vary.

We have been advised that the ground rent is £50 PA, with the service charge approx. £900 PA.



Please note that we have not tested any apparatus, equipment, fixtures, fittings or services, and so cannot verify they are in working order or fit for their purpose. Furthermore solicitors should confirm moveable items described in the sales particulars are, in fact, included in the sale since circumstances do change during marketing or negotiations. A final inspection prior to exchange of contracts is also recommended. Although we try to ensure accuracy, measurements used in this brochure may be approximate. Therefore if intending purchasers need accurate measurements to order carpeting or to ensure existing furniture will fit, they should take such measurements themselves.

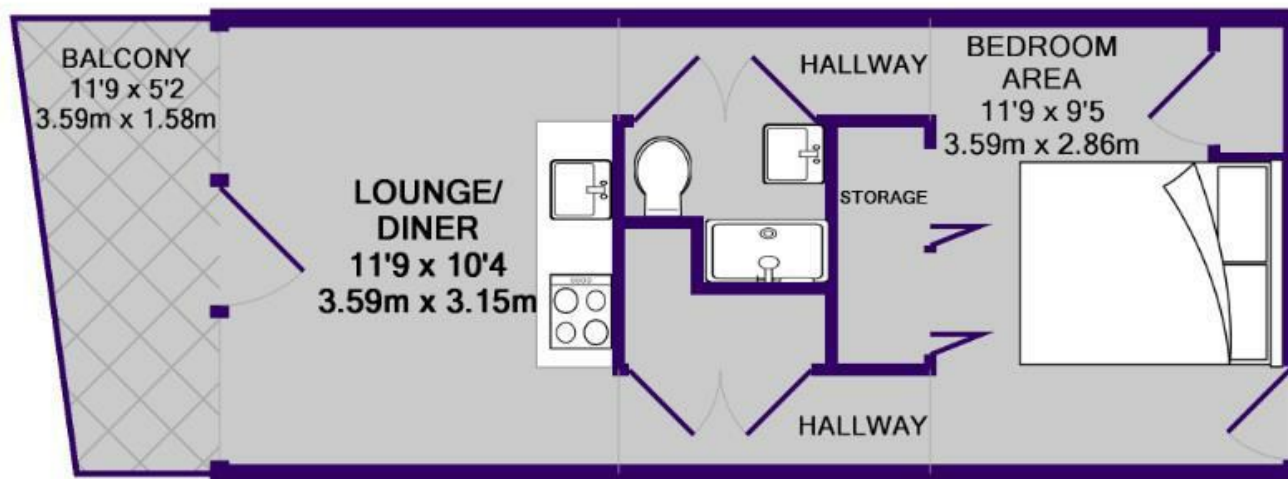

TOTAL APPROX. FLOOR AREA 327 SQ.FT. (30.4 SQ.M.)

Whilst every attempt has been made to ensure the accuracy of the floor plan contained here, measurements of doors, windows, rooms and any other items are approximate and no responsibility is taken for any error, omission, or mis-statement. This plan is for illustrative purposes only and should be used as such by any prospective purchaser. The services, systems and appliances shown have not been tested and no guarantee as to their operability or efficiency can be given

Made with Metropix ©2019

