



PLOT 2, CRICKETERS
VIEW, KILLINGHALL,
HG3 2DJ

£299,950

3 Bedroom House

EPC Rating:

LINLEY &
SIMPSON

Linley and Simpson are delighted to offer to the market Cricketers View, the latest development by Linden Homes, at Killinghall, Harrogate. A mix of 2, 3, 4 & 5 bedroom homes, the properties echo the traditional feel of this new neighbourhood. Enjoying interiors that feature designer bathrooms and kitchens, state-of-the-art wiring for connectivity and, of course, the peace of mind that's synonymous with a Linden Home.

The local area also offers excellent educational and recreational facilities, but being just a short hop from Harrogate means you are never far from some fantastic shopping choices, wide selection of restaurants and traditional tea rooms, and of course a location steeped in history. And with the North York Moors National Park around a 45-minute drive away, there is the chance to enjoy the best of both worlds. The village of Killinghall is nestled on the outskirts of Harrogate, just three miles north of the Spa town, and a mile from the neighbouring village of Ripley.

Part-Exchange & Help to Buy AVAILABLE! This attractive 3 bedroom semi-detached home offers a large living room to the rear with glazed doors onto the garden, a good-sized open plan kitchen diner, under-stairs storage cupboard and WC. Upstairs are 3 bedrooms - 2 of which are doubles - with bedroom 1 benefitting from an ensuite. Outside, you'll find 2 allocated parking spaces.

Room Dimensions

Ground Floor

Living Room - 4.98m x 3.20m 16'4" x 10'6"

Kitchen/Dining Area - 4.78m x 2.80m 15'8" x 9'2"

First Floor

Bedroom 1 - 2.78m x 2.72m 9'1" x 8'11"

Bedroom 2 - 2.90m x 2.78m 9'6" x 9'1"

Bedroom 3 - 3.20m x 2.12m 10'6" x 6'11"



PLOT 2

Approx Gross Floor Area = 882 Sq. Feet
= 81.94 Sq. Metres

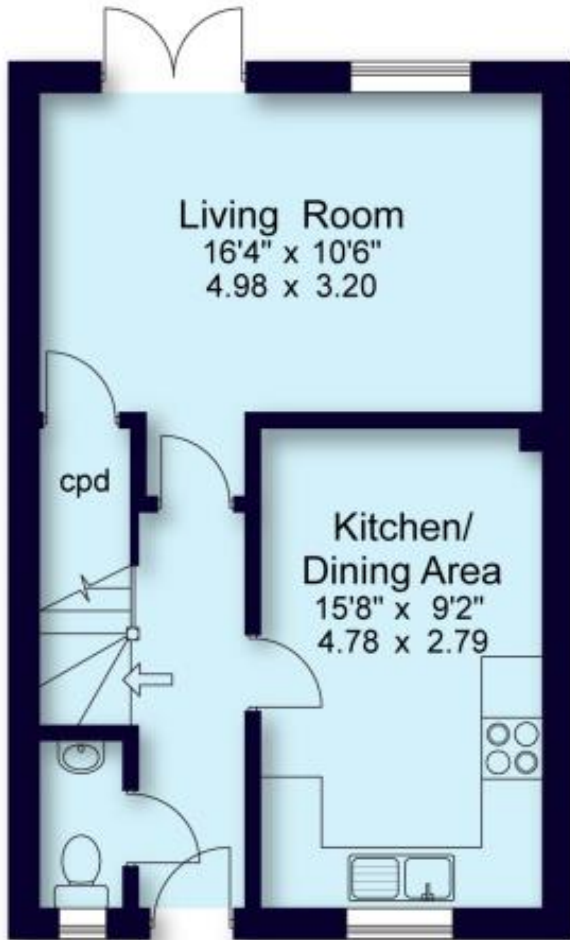

Ground Floor

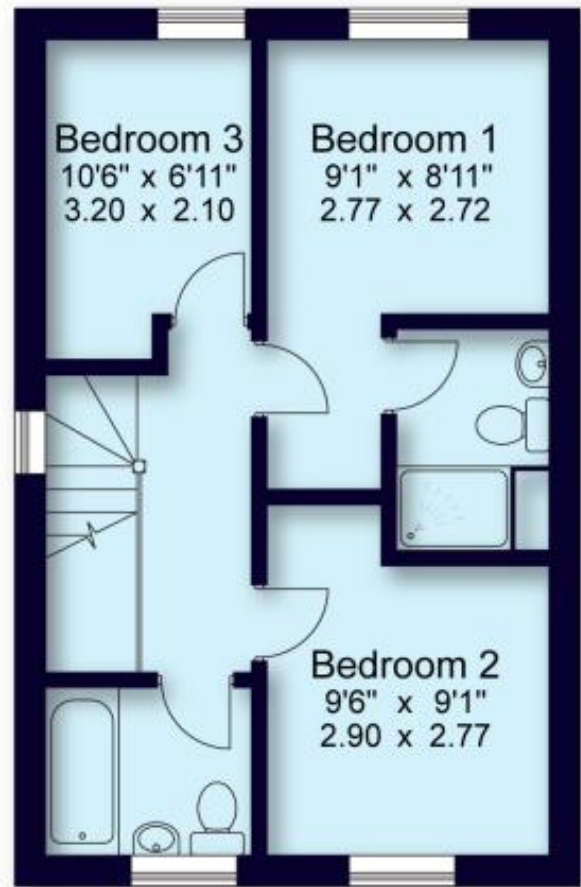

First Floor

For illustrative purposes only. Not to scale.

AGENTS NOTES:

These brochure particulars, including photographic displays, have been prepared by Linley & Simpson Sales Ltd. No implication is made that any item is to be included in the sale by virtue of its inclusion within the photographic display. All fixtures and fittings are excluded from the sale unless included separately within the legal 'fixtures & fittings' details. All measurements are taken in imperial and are approximate. We endeavour to make all the details contained therein accurate and reliable, but they should not be relied upon as statements or representations of fact. Descriptions of appliances, services, systems, fittings and equipment should not be taken as guarantee that they are in working order, they have not been tested (unless stated) and no warranty can be given as to their condition. These particulars do not constitute any part of an offer or contract and we strongly recommend the details should be verified by any prospective purchaser or their advisors, by inspection of the property.