



Valley Road, Sompting, West Sussex  
Offers over £380,000 - £410,000



middletton  
estates





Entrance Hallway

Lounge / Dining  
Room  
23'3 x 12'10

Kitchen  
10'4 x 10'

Bedroom 2  
11'2 x 10'

Bedroom 3  
10' x 10'

Family Bathroom  
Landing

Master Bedroom  
15'8 x 11'3

Shower Room  
Private Rear Garden



# BEAUTIFUL 3 BEDROOM SEMI-DETACHED CHALET BUNGALOW WITH VIEWS ACROSS PADDOCK

LOUNGE / DINER, KITCHEN, 3 DOUBLE BEDROOMS, FAMILY BATHROOM, SHOWER ROOM, SOUTH FACING GARDEN AND OFF ROAD PARKING

Middleton Estates are delighted to be able to offer to the market this delightful 3 double bedroom chalet bungalow, located in the sought after North Sompting area.

Set at the foot of the South Downs and providing unspoilt Southward views across a paddock, this property is not to be missed.

Approaching the property from the front, there is off road parking for at least 3 vehicles, and shared driveway leading to the side gate for rear access to the garden.

Entering the property into the light and airy hallway, with 2 doubles bedrooms either side and at the front of the property. Further along the hallway are the stairs leading to the first floor and generous 4 piece family bathroom. The rear of the property offers a bright, open plan flow with kitchen, lounge and

dining area with double doors out onto the South facing garden. Stepping out to the garden, there is composite decking area finished with stylish glass barriers which provides a stunning area to enjoy the later summer evenings with friends and family. The rest of the garden is laid to lawn, with a second decking area in the bottom corner and views across the paddocks.

The first floor offers a large master bedroom with views from the front and rear of the property as well as wet room.

The property has a gentle balance of the rural life while at the same time having excellent transport links with the A27 within easy reach. A local parade of shops and pubs are within walking distance, and Sainsbury's approximately 2 minutes away by car and Lancing Train Station 1.7 miles away





Ground Floor

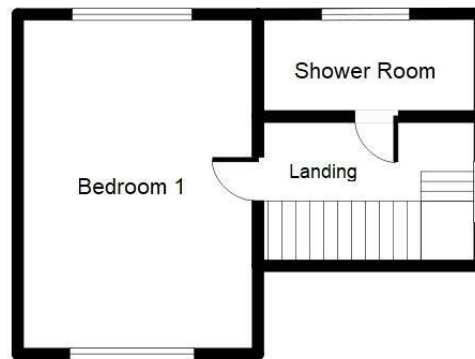

First Floor

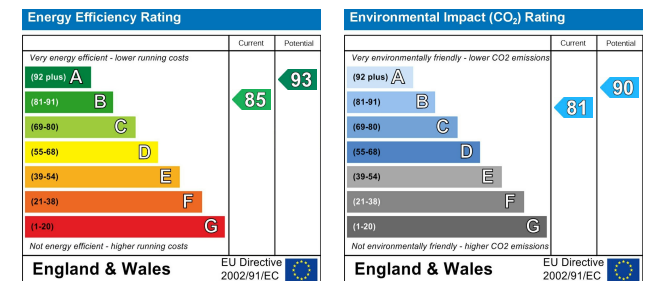

"Call us for your free valuation."