



**Belmont Park Holymoore Road**  
Holymoorside, Chesterfield, S42 7DS

**£190,000**





## Belmont Park Holymoore

Holymoorside, Chesterfield, S42 7GG

••3D TOUR•• £190,000 - £200,000 (Guide price) A modern and well presented 2 bedroom ground floor apartment, located within the highly desirable development of Belmont Park, benefitting from a large, open plan living area, modern kitchen with high specification integrated appliances, family bathroom and two well-sized bedrooms.

Belmont Park, located in the highly desirable village of Holymoorside, benefits from its close proximity to the Peak District and Chesterfield Town Centre, local amenities and transport links. The development is set in stunning grounds with a communal garden and surrounded by beautiful countryside.







Floor Plan

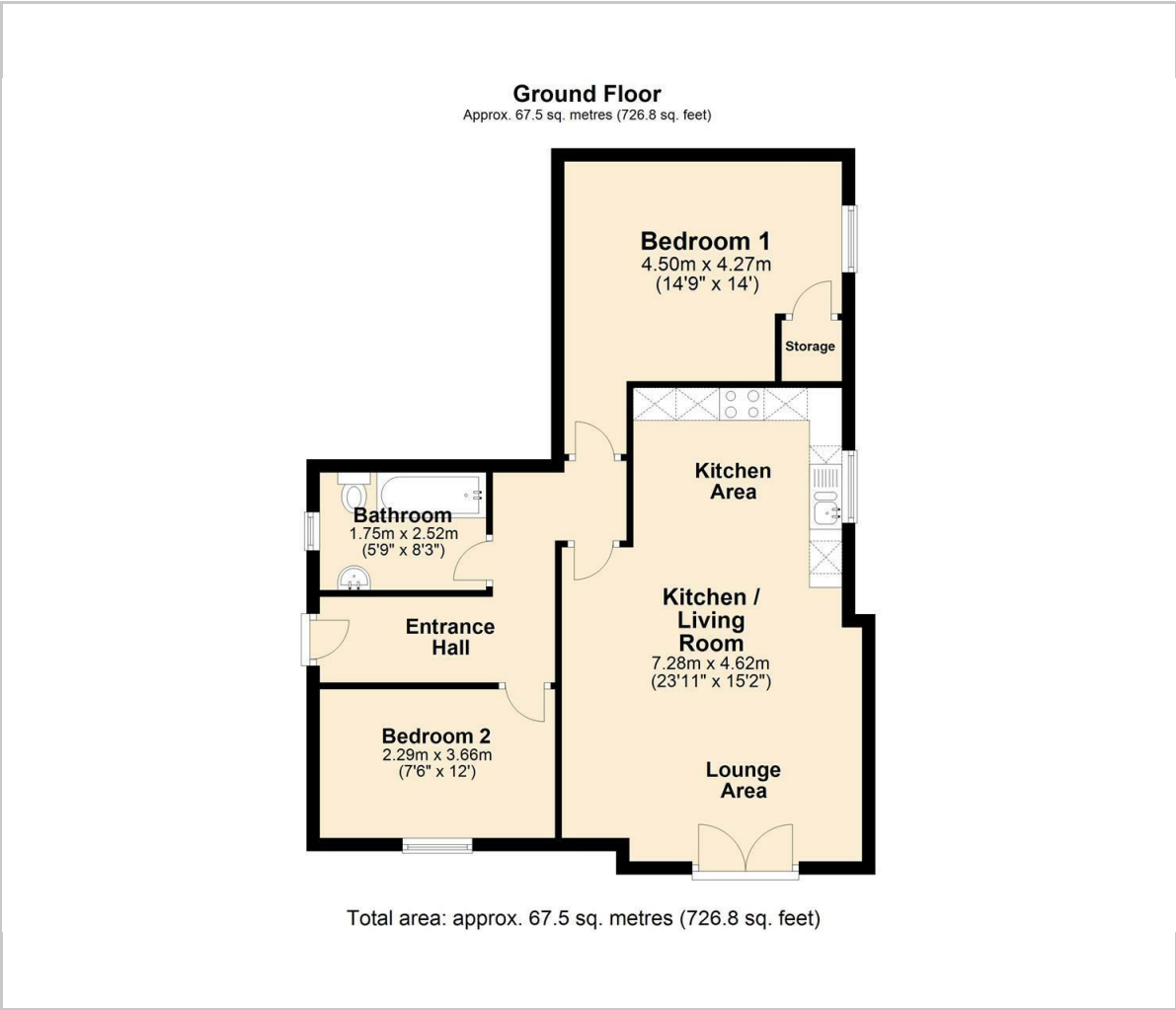

Viewing

Please contact our Dales and Peaks Office on 01246 567540 if you wish to arrange a viewing appointment for this property or require further information.

These particulars, whilst believed to be accurate are set out as a general outline only for guidance and do not constitute any part of an offer or contract. Intending purchasers should not rely on them as statements of representation of fact, but must satisfy themselves by inspection or otherwise as to their accuracy. No person in this firms employment has the authority to make or give any representation or warranty in respect of the property.

Area Map



Energy Efficiency Graph

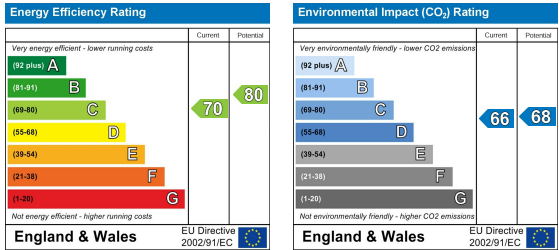

T: 01246 567540

E: [info@dalesandpeaks.co.uk](mailto:info@dalesandpeaks.co.uk)  
[www.dalesandpeaks.co.uk](http://www.dalesandpeaks.co.uk)