

Toddington Office:

**01525 877 300**



**HOUSEHOLD**  
estate agents

Residential Sales • Property Management • Lettings

**88 Luton Road, Toddington, Bedfordshire, LU5 6DG**

**£750 Per Month**



**TWO BED COTTAGE.**

Available March 2020. A spacious two bedroom unfurnished house in the village of Toddington. The cottage has many benefits, including gas central heating, large rear garden, with decked area and storage sheds and is close to all the village amenities. The house offers two bedrooms, lounge, fitted kitchen, downstairs bathroom/wc. The property will have new pvc windows and doors prior to the tenancy commencing. Please call today to arrange your viewing.

- AVAILABLE MARCH
- Fitted Kitchen
- Large Rear Garden
- Two Bedrooms
- Unfurnished
- New Double Glazing

For details on all of our properties for sale and for rent visit [www.house-hold.co.uk](http://www.house-hold.co.uk)

**PRS** Property  
Redress  
Scheme

**Zoopla.co.uk**

movewithus  
recommended agent

**nTheMarket.com**

**rightmove**  
find your happy

**The Property Experts with the Personal Touch**

# Floor Plan

## Ground Floor

Approx. 28.2 sq. metres (304.0 sq. feet)

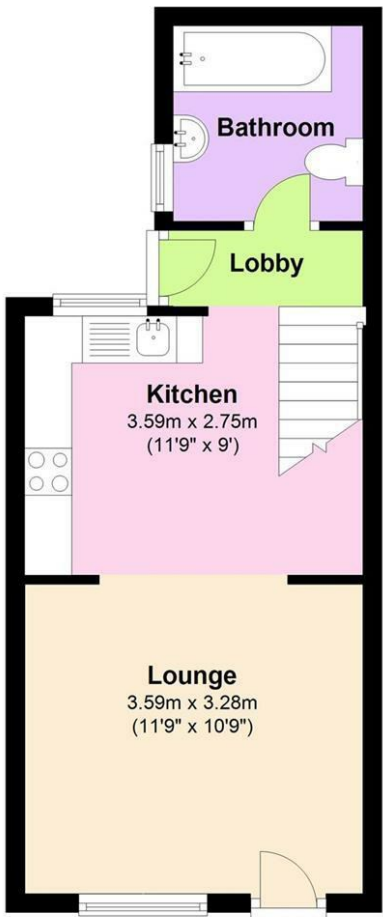

## First Floor

Approx. 22.3 sq. metres (240.1 sq. feet)



## EPC

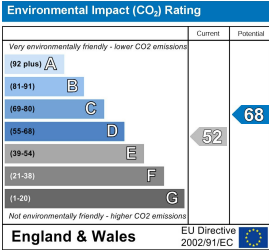
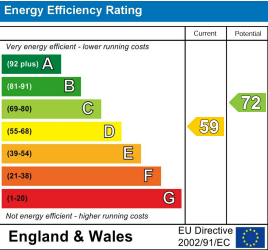

address: 2-4 High Street, Toddington,  
Bedfordshire LU5 6BY  
telephone: 01525 877 300  
email: [lettings@house-hold.co.uk](mailto:lettings@house-hold.co.uk)  
website: [www.house-hold.co.uk](http://www.house-hold.co.uk)

Additional Office: Dunstable: 15b High Street  
North - 01582 608 911

## The Property Experts with the Personal Touch

**MISDESCRIPTIIONS ACT:** Household Estate Agents Ltd. For themselves and for the vendors of this property, whose agents they are, give notice that the particulars are set out as a general outline only for the guidance of intended purchasers and do not constitute or constitute part of any offer or contract. All descriptions, dimensions reference to condition and necessary permissions for use and occupation and other details are given without responsibility, and any intending purchasers should not rely upon them as statements or representations of fact but must satisfy themselves by inspection or otherwise as to their correctness. No person in the employment of Household Estate Agents Limited has any authority to give or make any representation or warranty whatsoever in relation to this property.