



jordanfishwick

WEST DIDSBURY
Houseman Crescent



Houseman Crescent, West Didsbury M20 2JD
 Guide price £375,000



The Property

A stylish town house forming part of a popular purpose built development in West Didsbury with a driveway to the front and landscaped garden at the rear. Warmed by gas fired central heating which is further complemented by uPVC double glazing, the tastefully presented living space is laid out over three floors with numerous noteworthy features including a good sized lounge with laminate floor, comprehensively fitted breakfast kitchen with integrated appliances, four double bedrooms, the master with en-suite shower room and fitted robes, and a family bathroom with modern suite.

Directions

Leaving the office along Wilmslow Road in a northerly direction take a left at the lights into Barlow Moor Road and continue through the next set of lights at the junction with Palatine Road. After approx 500 yards turn right into Burton Road and then the second left into Nell Lane, Houseman Crescent can then be found on the right hand side, opposite Elizabeth Slinger Road. Following the road round, the property can be found on the left hand side. (SAT NAV: M20

- Stylish town house
- West Didsbury location
- Gas central heating
- PVCu double glazing
- Fitted kitchen with integrated appliances
- Four double bedrooms
- En-suite shower room
- Fitted wardrobes

Postcode - M20 2JD

EPC Rating - B

Floor Area - 1228 sq ft

Local Authority - Manchester City Council

Council Tax - Band E



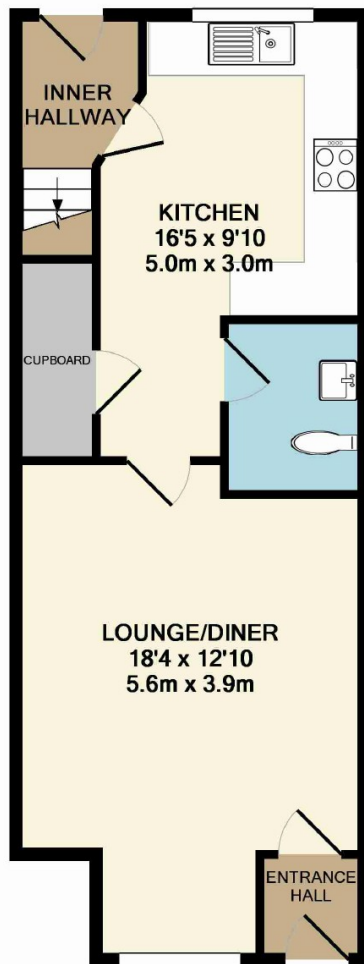

GROUND FLOOR
APPROX. FLOOR
AREA 435 SQ.FT.
(40.4 SQ.M.)

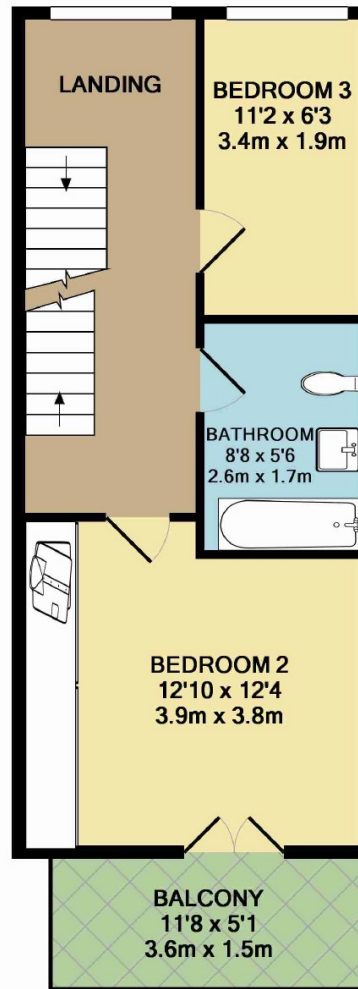

1ST FLOOR
APPROX. FLOOR
AREA 396 SQ.FT.
(36.8 SQ.M.)

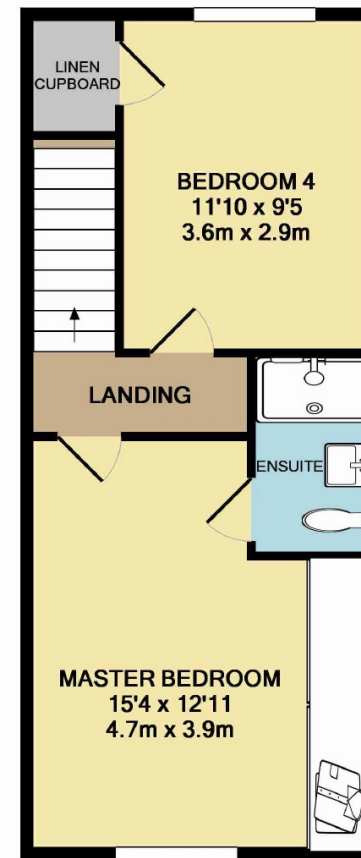

2ND FLOOR
APPROX. FLOOR
AREA 396 SQ.FT.
(36.8 SQ.M.)

TOTAL APPROX. FLOOR AREA 1228 SQ.FT. (114.0 SQ.M.)
Measurements are approximate. Not to scale. Illustrative purposes only
Made with Metropix ©2015

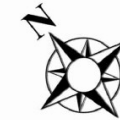

These particulars are believed to be accurate but they are not guaranteed and do not form a contract. Neither Jordan Fishwick nor the vendor or lessor accept any responsibility in respect of these particulars, which are not intended to be statements or representations of fact and any intending purchaser or lessee must satisfy himself by inspection or otherwise as to the correctness of each of the statements contained in these particulars. Any floorplans on this brochure are for illustrative purposes only and are not necessarily to scale.

Offices also at: Wilmslow, Macclesfield, Hale, Sale, Chorlton, Glossop, Manchester & Salford

757-759 Wilmslow Road, Didsbury Village, Manchester

0161 445 4480

didsbury@jordanfishwick.co.uk
www.jordanfishwick.co.uk