



Landmere Gardens, Nottingham, NG3 3BG

£550 Per Calendar Month



A well presented mid townhouse close to both Mapperley and Nottingham City Centre. The property has a lounge with laminate flooring, modern dining kitchen with appliances, two bedrooms and a modern bathroom with white suite and mains shower. Outside is a low maintenance rear garden and an allocated parking space situated within an adjacent parking area.

- Well presented end townhouse
- Entrance hall, lounge with laminate flooring
- Bathroom/Wc with white suite and mains shower
- Lawned front and low maintenance paved rear garden
- Perfect for a single person or professional couple
- Two bedrooms, both with laminate flooring
- Modern dining kitchen with integrated appliances
- Combination GCH, UPVC double glazing
- Parking space situated within a communal area
- Close to Nottingham City Centre

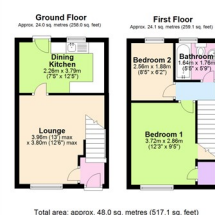

45b Plains Road, Mapperley, Nottingham, NG3 5JU
Tel: 0115 962 4213 Email: lettings@david-james.com www.david-james.com