



Long Terrace Close, Chaddlewood, Plympton



42 Long Terrace Close, Chaddlewood, Plympton, PL7 2GS

Property Description

A very well presented modern property with the benefits of having gas central heating, uPVC framed double glazing, an enclosed garden and allocated parking. Accommodation over two floors comprises of lounge, kitchen/diner, 2 double bedrooms and a modern contemporary bathroom. Offered with no onward chain, an early viewing is highly recommended.



PRICE £164,950

ENTRANCE: uPVC door into:

LOUNGE: 15' 9" x 11' 9" (4.82m x 3.59m) Stairs to first floor with cupboard below. Radiator and window to the front. Door to:

KITCHEN/DINER: 11' 9" x 8' 9" (3.59m x 2.69m) Modern range of white gloss front base and wall units with roll edge work surfaces over and underlighting. Stainless steel sink unit, built in oven and hob and spaces for washing machine and fridge/freezer. Radiator, wall mounted combi boiler and window and door to the rear.

LANDING: Doors off to:

BEDROOM 1; 11' 9" x 8' 9" (3.59m x 2.69m) Radiator and window to the rear.

BEDROOM 2: 11' 9" x 7' 6" (3.59m x 2.29m) Radiator and window to the front elevation

BATHROOM: Modern contemporary bathroom comprising of panelled bath with tiled surround, glazed screen and 'rain' shower over. vanity wash hand basin with storage below and low level wc with recessed cistem. Towel radiator and overstairs cupboard.

OUTSIDE: To the rear of the property is a walled and fenced low maintenance garden with patio, small decked area and gravelled area. There is a small timber built shed.

PARKING: There is an allocated parking space plus



Ground Floor

Approx. 27.3 sq. metres (294.0 sq. feet)

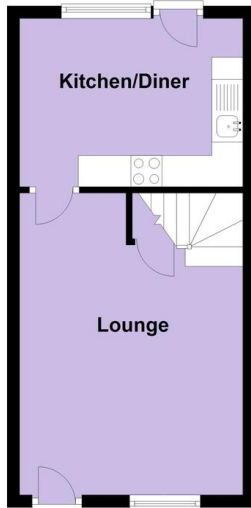

First Floor

Approx. 27.3 sq. metres (294.0 sq. feet)

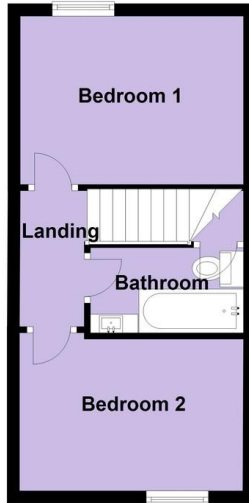

Total area: approx. 54.6 sq. metres (588.0 sq. feet)

EPC Rating - C
Council Tax Band - B

Viewing Arrangements:
Contact Moving On
01752 340666

For more information
on this property
please visit our
website

www.movingonestateagents.co.uk

Important Note: These details have been produced for prospective purchasers as a guide only. This includes floorplans that may not be to scale but are provided as a guide to layout only. They are not part of a contract or offer and should not be relied upon as a statement of fact. No appliances, central heating or electrical systems have been tested. Prospective purchasers should make their own enquiries.



Zoopla.co.uk



01752 340666

145 Ridgeway, Plympton, Plymouth, PL7 2HJ
www.movingonestateagents.co.uk

