



Gloucester Terrace, Westminster, Paddington, W2 £650 Per Week* Fees Apply

Situated on the first floor of a beautiful period building is this recently refurbished two bedroom apartment. Consisting of two bathrooms, large reception room with open plan kitchen and dining area. Further benefitting from beautiful carpets throughout and real wood flooring in reception room.

The closest tube station is Paddington which is a five minute walk from the property. Hyde Park is also within a short walk and the local amenities of Oxford Street are also within reach.

- ZERO DEPOSIT AVAILABLE
- Newly refurbished throughout
- Two double bedrooms
- Two bathrooms
- Large open plan kitchen lounge
- Lots of natural light
- Beautiful carpets
- Located just moments from Paddington Station

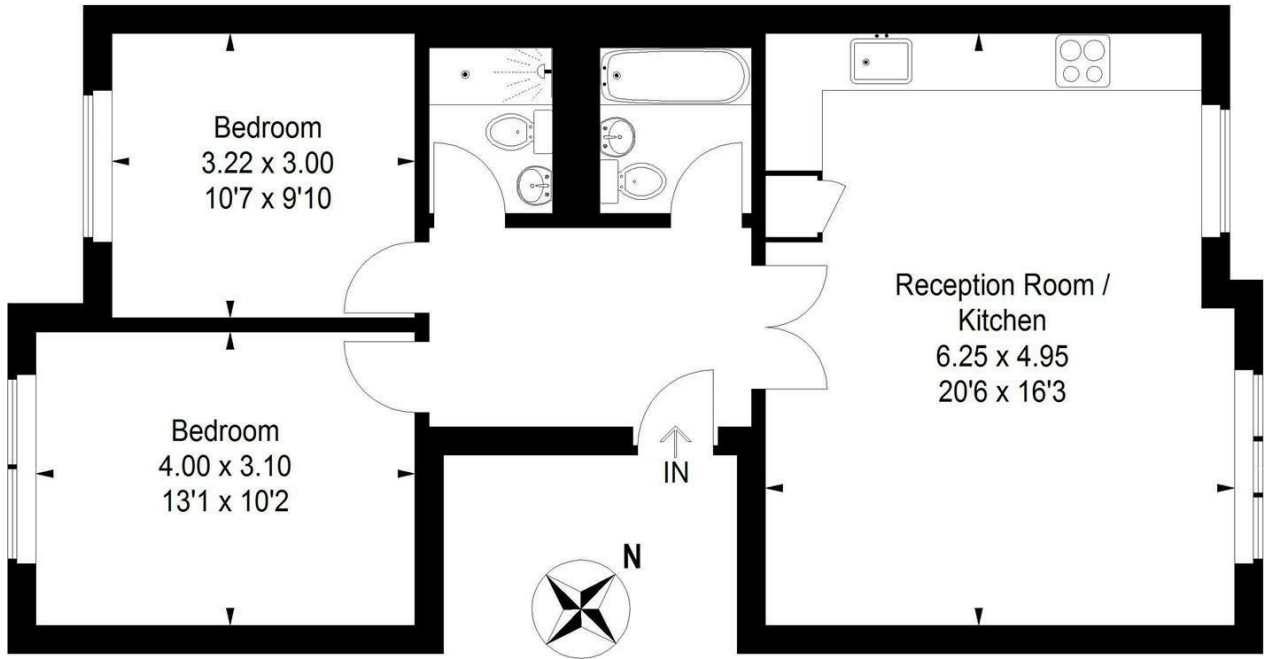

First Floor

Approximate Gross Internal Area
67.9 sq m / 731 sq ft

This plan is for layout guidance only. Not drawn to scale unless stated. Windows and door openings are approximate. Whilst every care is taken in the preparation of this plan, please check all dimensions, shapes and compass bearings before making any decisions reliant upon them. (ID 436369)

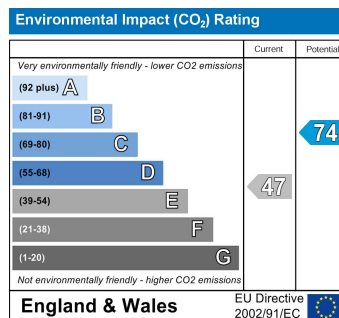
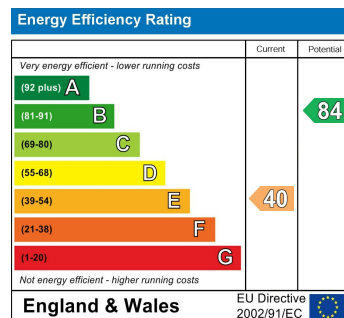

Admin fee: £ inclusive of VAT | Reference Fee: £ inclusive of VAT per application | Inventory Fee may also apply