



Portsea Place

HYDE PARK, W2



Portsea Place

HYDE PARK, W2

A beautifully renovated two bedroom two bathroom apartment to let. The property boasts wooden floors throughout, ample built in storage and stylish contemporary bathrooms. The well equipped kitchen opens onto a large reception room allowing ample room to dine.

The property is located within walking distance to the open spaces of Hyde Park and within close proximity to the fantastic array of shops on Oxford Street. The nearest Underground Station is Marble Arch on the Central line.

2 bedrooms, 2 bathrooms, reception room, kitchen, porter. EPC rating C.

LONG LET: £990 PER WEEK (FEES APPLY)
LOCAL AUTHORITY: City of Westminster
ENERGY RATING: C

CONSUMER PROTECTION FROM UNFAIR TRADING REGULATIONS 2008. THIS BROCHURE AND THE DESCRIPTIONS AND MEASUREMENTS HEREIN DO NOT CONSTITUTE REPRESENTATION AND WHILST EVERY EFFORT HAS BEEN MADE TO ENSURE ACCURACY, THIS CANNOT BE GUARANTEED.

NOTTING HILL OFFICE

T 020 7221 5388

205 WESTBOURNE GROVE, LONDON, W11 2SB

E NOTTINGHILL@BECTIVE.CO.UK

WWW.BECTIVE.CO.UK

Portsea Hall, W2

Approximate Gross Internal Area
73.8 sq m / 794 sq ft

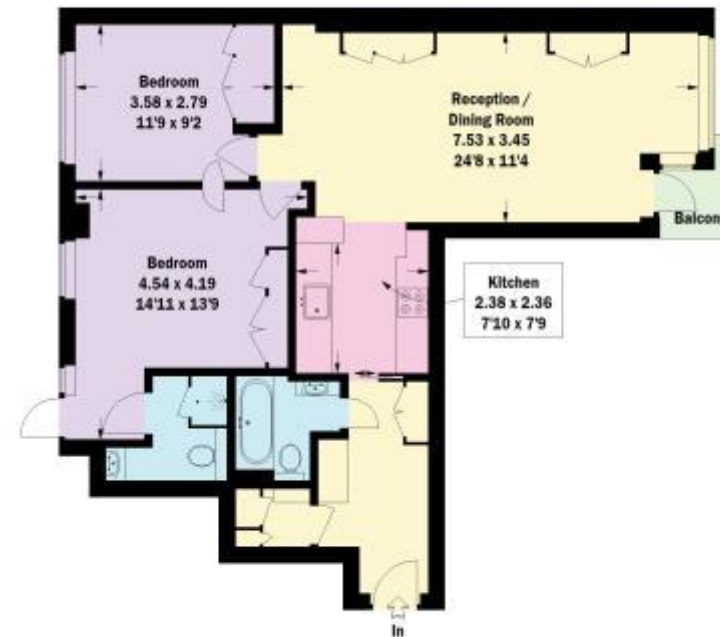

Third Floor

Whilst every attempt has been made to ensure the accuracy of the floor plan, measurements are approximate and not to scale. No guarantee is given on the total square footage of the property quoted on the plan. Figures given are for guidance. Plan is for illustration purposes only, not to be used for valuations.

BECTIVE
- LESLIE MARSH -