



MILES ESTATE AGENTS

**4 Grove Gate Staplegrove
Taunton TA2 6DF**



****SHARED OWNERSHIP**** A rare opportunity to purchase a 50% share of this well presented and spacious modern terraced house with tiered garden and off road parking in this popular development north west of the town centre. 2 double bedrooms and good size lounge/dining room - early viewing recommended.





Features:

- Entrance Hall
- Good Size Lounge/ Dining Room
- Spacious, Modern Kitchen
- Cloakroom
- 2 Generous Double Bedrooms
- Family Bathroom
- Tiered Enclosed Garden To The Rear
- Allocated Off Road Parking
- Council Tax Band C
- Leasehold for 99 Years From 1st July 2012
- Rent payable of £231pcm to LiveWest



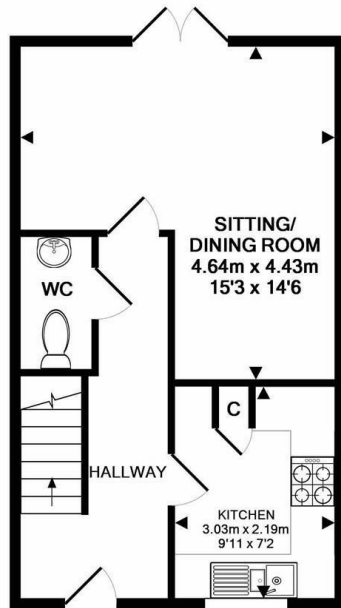

GROUND FLOOR
APPROX. FLOOR
AREA 34.0 SQ.M.
(366 SQ.FT.)

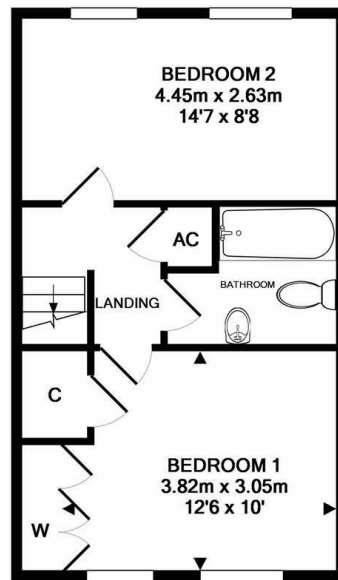

1ST FLOOR
APPROX. FLOOR
AREA 34.0 SQ.M.
(366 SQ.FT.)

TOTAL APPROX. FLOOR AREA 68.0 SQ.M. (731 SQ.FT.)
Made with Metropix ©2019

Energy Efficiency Rating		
	Current	Potential
Very energy efficient - lower running costs		
(92 plus) A		97
(81-91) B	85	
(69-80) C		
(55-68) D		
(39-54) E		
(21-38) F		
(1-20) G		
Not energy efficient - higher running costs		
England & Wales	EU Directive 2002/91/EC	



Viewings strictly through the selling agents:

Miles Estate Agents

2 Piffin Lane, Bishops Lydeard, Taunton, Somerset, TA4 3AS

Tel: 01823 470 500

lydeard@milesestateagents.co.uk

www.milesestateagents.co.uk

rightmove

Zoopla.co.uk

OnTheMarket.com

MILES ESTATE AGENTS

