

Gosforth
0191 236 2070
Newcastle
0191 284 4050
Forest Hall
0191 605 3134
High Heaton
0191 270 1122
Low Fell
0191 487 0800
Tynemouth
0191 257 2000
Whitley Bay
0191 251 3000
Property Management Centre
0191 236 2680

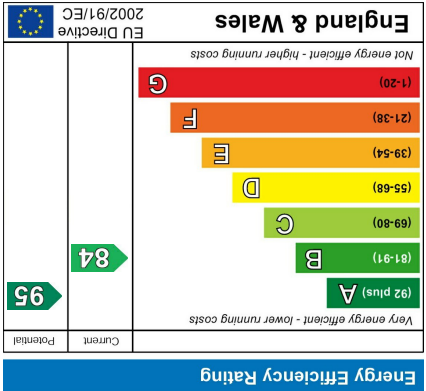

You may download, store and use the material for your own personal use and research. You may not republish, retransmit, redistribute or otherwise make the material available to any party or make the same available in any other online service or bulletin board of your own or of any other party or make the same available in hard copy or in any other media without the website owner's express prior written consent. The website owner's copyright must remain on all reproductions of material taken from this website.

The difference between house and home

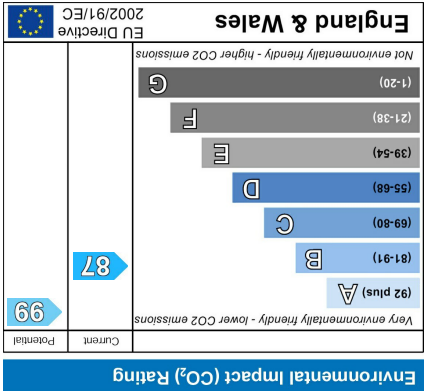
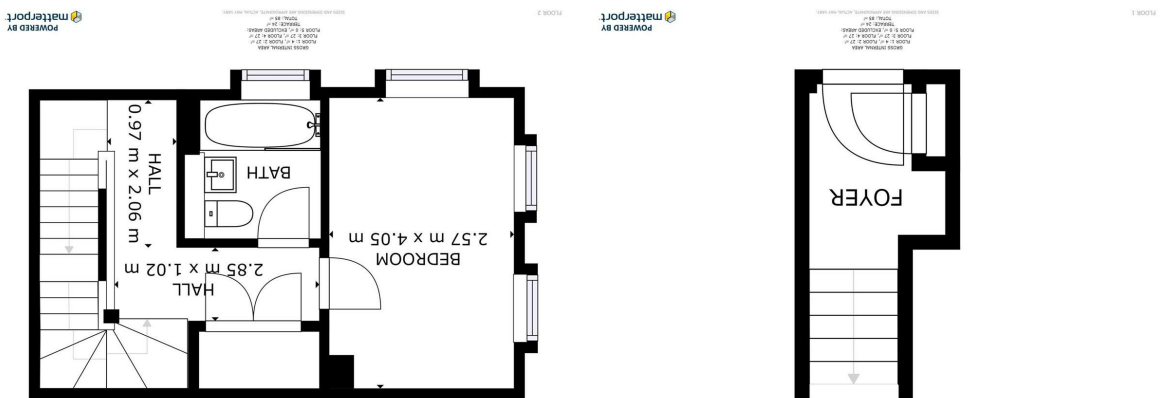
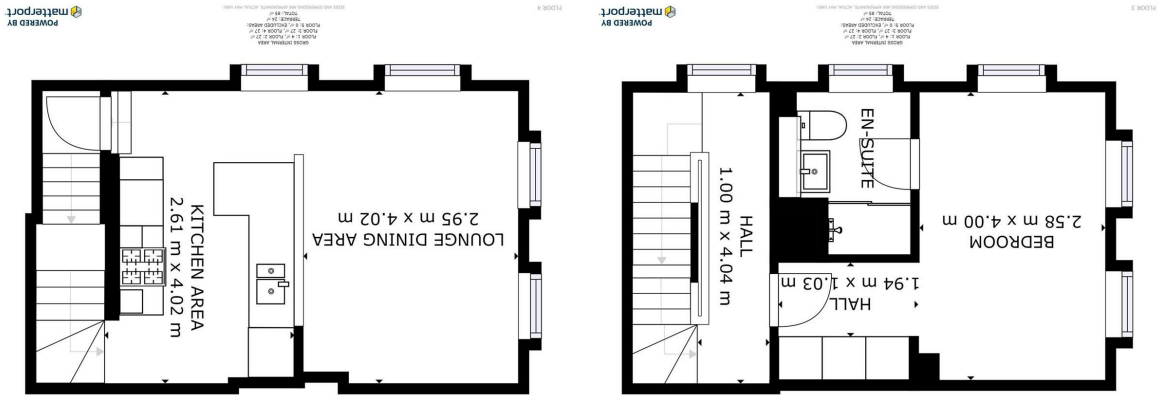

Lounge Dining Room 9'8" x 13'2" (2.95 x 4.02)

Kitchen 8'6" x 13'2" (2.61 x 4.02)

Bedroom One 8'5" x 13'1" (2.58 x 4.00)

Bedroom Two 8'5" x 13'3" (2.57 x 4.05)





- Beautifully Presented
- Highly Sought After Location
- Roof Terrace
- Off Road Parking
- Secure Entry System
- Laundry Room
- Master En-Suite
- Stunning Views
- Close To City Centre
- Must Be Viewed



360° VIRTUAL REALITY TOUR AVAILABLE ON THIS PROPERTY...IT'S AMAZING..IT'S LIKE HAVING AN OPEN HOUSE 24/7!

What the owner says ... "We have absolutely loved living in this multi award winning development, which was voted in the Top 10 most fashionable places to live in the UK (The Times, March 2015) due to the fantastic community spirit, and amazing location. The house has a unique design, making it perfect for days and evenings spent with friends and family on the roof terrace, eating, drinking and taking in the spectacular views of the Ouseburn Valley and Quayside. Its eco-friendly design, built to the highest energy standards has saved us a fortune in bills and helped reduce our carbon footprint."

Beautifully presented and situated on the highly sought after award winning development of The Mailings on the very edge of the Quayside. This characteristic two bedroom terraced house within the highly sought after Ouseburn Valley is truly a home to be proud of.

The property has stunning views and is within close proximity to Newcastle city centre, excellent transport, restaurants and local shops.

The property boasts substantial accommodation over four floors and briefly comprises:- hallway with stairs rising to the first floor which in turn provides access to a double bedroom, family bathroom and laundry room, then up the stairs to the second floor lies a further bedroom and en-suite shower room. The third floor features a sizeable living room, well-equipped kitchen/diner and a staircase providing access to the roof terrace which benefits from amazing views over the River Tyne. The property also boasts a secure entry system, off street parking and ample storage.

We anticipate an extremely high level of viewings on this completely unique home. To arrange yours please call 0191 270 1122.