

Chiswick High Road, London, W4 1TS

£550,000

WHITMAN & CO.

SALES · LETTINGS · COMMERCIAL

- Central Chiswick Location
- 2nd floor flat
- No chain
- Spacious reception room
- Close to Stamford Brook Station

Tenure - Leasehold (143 year lease)
Ground Rent and Service Charge - £1967.24 pa
Local Authority - Hounslow
Council Tax - Band D

THE PROPERTY

A spacious (854 sqft) 2nd floor apartment offered to the market with no onward chain located on Chiswick High Road close to numerous amenities. The flat comprises; two double bedrooms, bathroom with separate shower, fitted kitchen, huge reception room, long lease. The flat is located within a short walk of the numerous shops, cafes and restaurants on Chiswick High Road. Transport links include Stamford Brook Station, local bus routes and the A4/M4 for routes in and out of London. No chain.

Ross House, Chiswick High Road W4 1TS

Approximate Gross Internal Area = 79.3 sq m / 854 sq ft

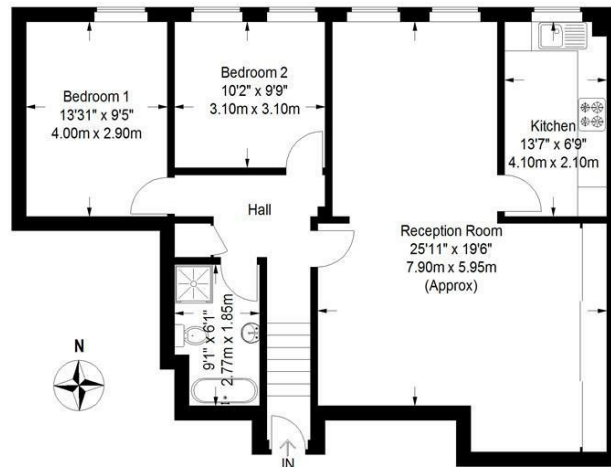

Measured in accordance with RICS guidelines. To be used for identification and guidance purposes only. Not to scale.
© Photos Plans and EPCs | Tel: 07774 688 771 | info@photosplansandepcs.com | www.photosplansandepcs.com

SITUATION



5-7 Turnham Green Terrace, Chiswick, London, W4 1RG

Tel 020 8747 8800

E-mail sales@whitmanandco.com

Website www.whitmanandco.com