



**TOWN & COUNTRY**

18 Chester Road West, Queensferry, CH5 1SA  
£135,000



---

# Chester Road West

## Deeside

---

ATTENTION FIRST TIME BUYERS AND INVESTORS!

A SPACIOUS END OF ROW HOUSE boasting TWO RECEPTION ROOMS, a LARGE KITCHEN/DINER with BREAKFAST BAR and appliances including an INTEGRATED OVEN AND HOB, INTEGRATED FRIDGE, INTEGRATED FREEZER and (if required), SPACE FOR AN AMERICAN STYLE FRIDGE/FREEZER.

Upstairs are THREE LARGE BEDROOMS and a LOVELY BATHROOM with a WHITE SUITE and SEPERATE SHOWER CUBICLE. The loft space has a ROOF WINDOW.

The property also benefits from PVCu DOUBLE GLAZING, gas central heating with a WORCESTER COMBI BOILER and a SECURITY SYSTEM.

Outside, the front is LOW MAINTENANCE and to the rear there is a low maintenance PATIO GARDEN with access to a LARGE ATTACHED GARAGE with a PITCHED ROOF as well as POWER AND LIGHTING.

The current owners have indicated that they are prepared to leave some contents if required by the buyer.

The house would probably be SUITABLE FOR CONVERSION TO AN HMO (subject to the usual permissions). VIEWING IS HIGHLY RECOMMENDED!

- 
- Mid Row House
  - Three Good Size Bedrooms
  - Two Reception Rooms
  - Fabulous, Large Kitchen
  - Lovely Bathroom
  - Gas CH With Combi
- 







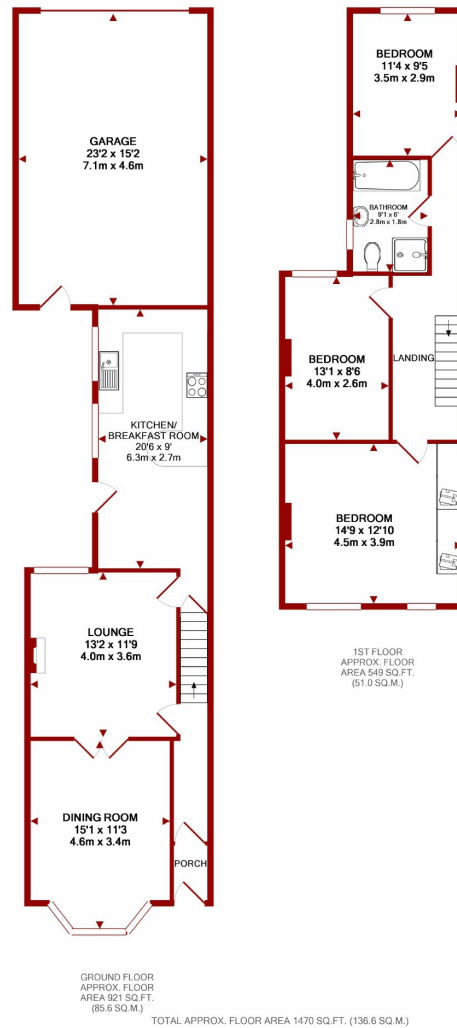

Floor Plan created by planstosell.co.uk - Measurements are approximate. Not to scale.  
Illustrative purposes only.  
Made with Metropix ©2019



**TOWN & COUNTRY**

**TandCDeeside**

**townandcountrydeeside**

01244 830000

homes@tandcdeeside.co.uk

22 Chester Road West, Deeside, CH5 1BX

[www.townandcountryproperty.co.uk](http://www.townandcountryproperty.co.uk)

These particulars were prepared following initial inspection of the property and the descriptive comments are based upon information supplied by the owner to Town & Country Property Services at the time. These particulars, whilst believed to be accurate, are set out as a general outline for guidance only and do not constitute any part of an offer or contract. Intending purchasers should not rely upon them as statements or representation of fact, but must satisfy themselves, by inspection or otherwise, as to their accuracy. Neither Town & Country nor any person in their employ has the authority to make or give any representation or warranty whatsoever in relation to the property and these particulars are not to be construed as containing any representation of fact upon which any person is entitled to rely. None of the appliances or fixtures mentioned in these particulars have been tested by Town & Country Property Services. All measurements provided are approximate and cannot be relied upon. Floor plans if provided, are not to scale, are for guidance only and cannot be relied upon.