

Mapleton Road, Coundon, Coventry, CV6 2AY

newman
property experts



Mapleton Road | Coundon | CV6 2AY

Offers Over £235,000



A fantastic four bedroom mid-terrace property which sits in the popular residential area of Coundon. The property has an entrance hall, separate reception rooms, small conservatory, and a downstairs W.C. To the first floor there are three bedrooms, family bathroom, and stairs leading to a fourth bedroom. Outside there are mature front/rear garden, and a garage. A real cracker of a house, and offers no upper chain.



Call me
to book a
viewing



Stephen Rice
02476 500006

- SEPARATE RECEPTION ROOMS
- FITTED KITCHEN
- DOWNSTAIRS WC
- CONSERVATORY
- 4 BEDROOMS
- FAMILY BATHROOM
- GARAGE
- FRONT & REAR GARDENS
- COUNDON COURT CATCHMENT
- ENERGY RATING E

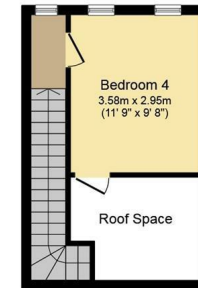
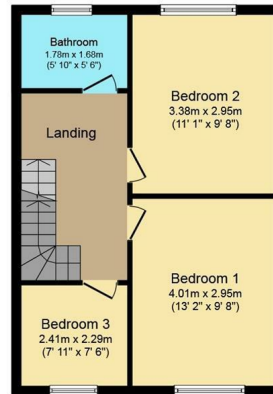
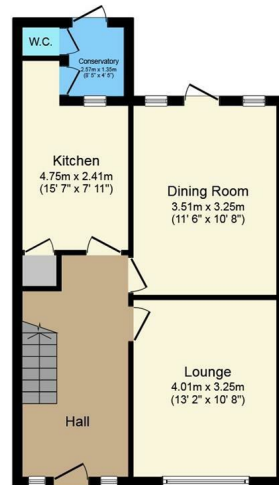

Total floor area 117.0 sq. m. (1,259 sq. ft.) approx

ry. The position and size of doors, windows

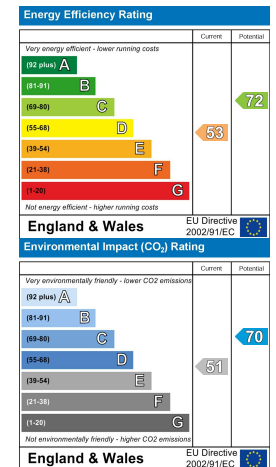

02476 500006

stephen.rice@newman.uk.com

newman.uk.com

Friars House, Manor House Drive, Coventry
CV1 2TE

Agents note: All measurements are approximate and whilst every attempt has been made to ensure accuracy they are for general guidance only and must not be relied on. The fixture and fittings referred to have not been tested and therefore no guarantee can be given that they are in working order. Internal photographs are reproduced for general information and it must not be inferred that any item shown is included with the property. Newman Property Services Ltd. Registered Office: 1 Regent Street, Rugby, CV21 2PE. Registered in England & Wales: 4018410. VAT Registration No. 754 0628 33

newman
property experts