



*Jordan fishwick*

MANCHESTER  
High Ash Grove



## High Ash Grove, Manchester M34 5NH

Offers in excess of £160,000



### The Property

Jordan Fishwick are delighted to offer to the market a chance to purchase this immaculately presented three bedroom semi detached house in a popular location and within close distance to all local amenities, schools and transport links. This property is an ideal family home or equally will appeal to FTB looking to get their foot on the property ladder. Accommodation comprises of Entrance hall, south facing lounge, modern fully fitted Kitchen/diner and large conservatory. To the first floor there are two double bedrooms, third single bedroom and a fully tiled family bathroom. To the rear aspect lies a generous size enclosed garden laid to patio artificial grass. This property benefits from the integration of UPVC double glazing and gas central

heating throughout. Priced to sell! Early Viewing Is Strongly Recommended!

### Directions

Situated close to a selection of shops, schools and transport links.

- Semi Detached House
- Three Bedrooms
- Driveway
- Immaculate Condition Throughout
- Large Conservatory
- Modern Kitchen/Diner
- Priced To Sell!
- Popular Location
- Landscaped Rear Garden
- UPVC D/G Throughout

**Postcode** - M34 5NH

**EPC Rating** -

**Floor Area** - sq ft

**Local Authority** - Tameside Council

**Council Tax** - Band B



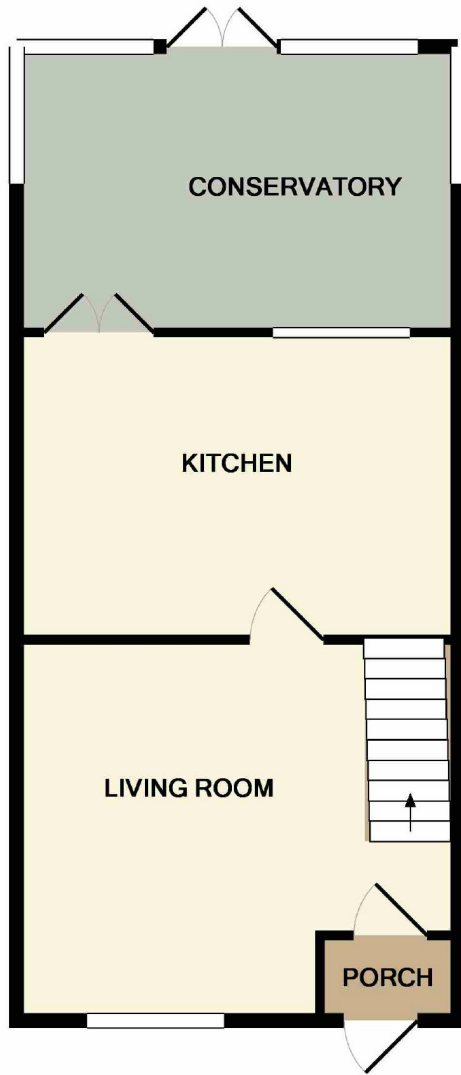

GROUND FLOOR

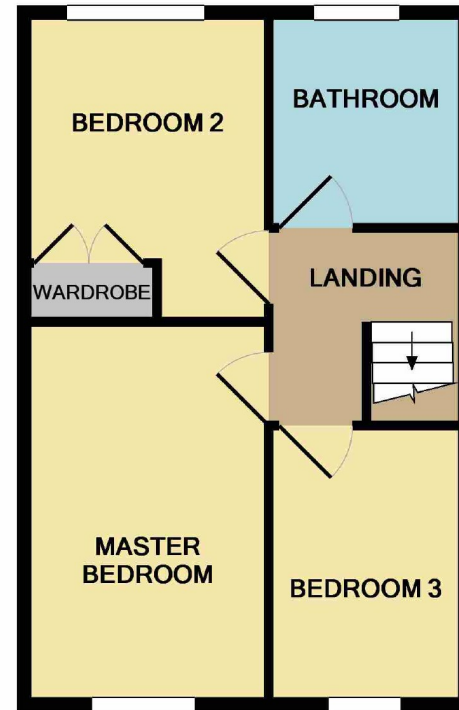

1ST FLOOR

Measurements are approximate. Not to scale. Illustrative purposes only  
Made with Metropix ©2019