



**7 GOLDCREST
WATERMEAD**





REGENCY STYLE GRANDEUR LOCATED WITHIN AN EXCLUSIVE, WATERSIDE DEVELOPMENT

Aylesbury c. 2 miles, Haddenham & Thame Parkway c. 8 miles, Bicester c. 17 miles, Oxford City Centre c. 23 miles

An elegant, regency style town house over three storeys, offering: Entrance hall, dining Room, kitchen diner opening into the private courtyard garden, utility room, sitting room, master bedroom with en-suite, 3 further bedrooms, family bathroom, garage and car port accessed via secure, private electric gates.

GUIDE PRICE: £450,000

Nikki Hemsley
(t) 01865 510000 (e) nikki@west-tpc.co.uk

DIRECTIONS: Upon proceeding into Aylesbury via the Oxford Road, A418, and carry straight on over the double roundabout to follow Ford Road, A413 until you reach the cross roads, signposted to Watermead. Turn right into Watermead at the traffic lights and follow the road passing over the lake. At the mini-roundabout, turn left and then immediately right into Fieldfare. Turn left into Goldcrest, and number 7 will be found on the left hand side.

7 Goldcrest, Aylesbury, HP19 0GB
 Approximate Gross Internal Area
 Main House = 1868 Sq Ft/173 Sq M
 Garage = 155 Sq Ft/14 Sq M
 Covered Carport external area = 190 Sq Ft/18 Sq M

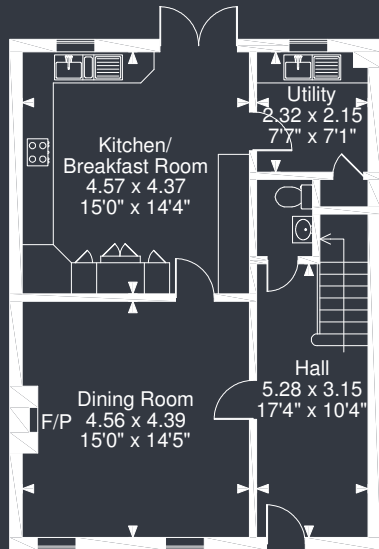

Ground Floor

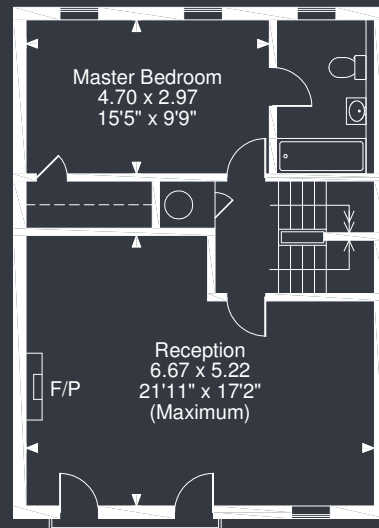

First Floor

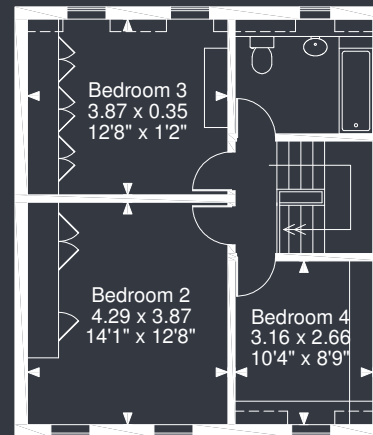

Second Floor

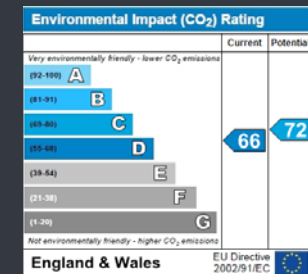
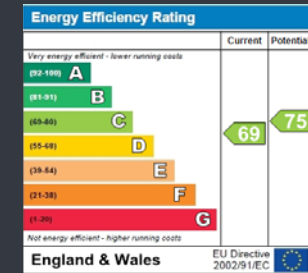
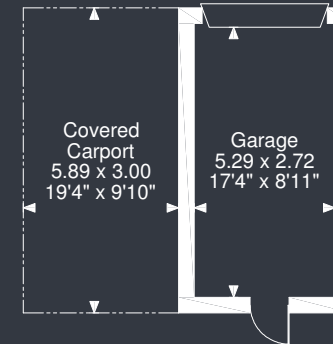

west
 THE PROPERTY CONSULTANCY

216 Banbury Road
 Summertown
 Oxford
 OX2 7BY

T: 01865 510000
F: 01865 558877
E: oxford@west-tpc.co.uk
west-tpc.co.uk

FOR ILLUSTRATIVE PURPOSES ONLY - NOT TO SCALE

The position & size of doors, windows, appliances and other features are approximate only.

□ □ □ □ Denotes restricted head height

© ehouse. Unauthorised reproduction prohibited. Drawing ref. dig/8395008/PJS