



Village Properties

5 Eighth Avenue
Tilehurst, RG31 4TN

£100,000



VillageProperties.co.uk

5 Eighth Avenue

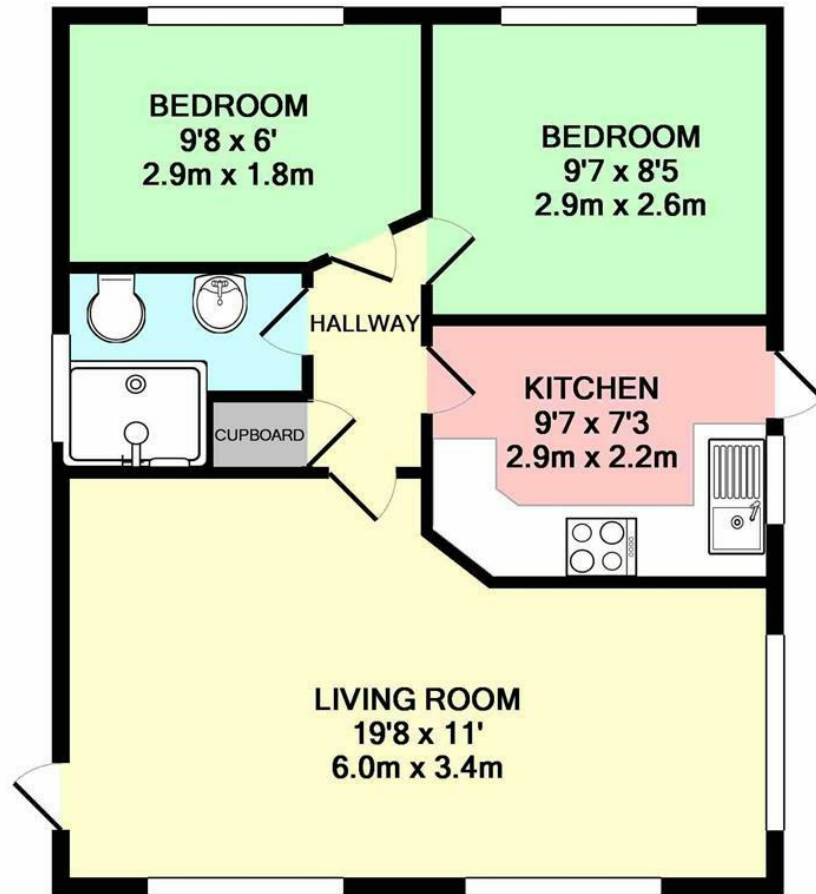

TOTAL APPROX. FLOOR AREA 471 SQ.FT. (43.7 SQ.M.)

Whilst every attempt has been made to ensure the accuracy of the floor plan contained here, measurements of doors, windows, rooms and any other items are approximate and no responsibility is taken for any error, omission, or mis-statement. This plan is for illustrative purposes only and should be used as such by any prospective purchaser. The services, systems and appliances shown have not been tested and no guarantee as to their operability or efficiency can be given
Made with Metropix ©2019

DESCRIPTION:

VP - Presented to the market is this spacious 2 bedroom park home situated on the ever popular Garston Park in Tilehurst. The property's accommodation includes a large lounge/dining room, fitted kitchen, refitted shower room and 2 bedrooms. Other benefits include driveway parking and a private garden.

SUMMARY OF ACCOMMODATION:

- 2 BEDROOMS
- 19' LOUNGE/DINING ROOM
- OVER 45's
- VACANT
- DRIVEWAY PARKING

ADDITIONAL INFO:

Approx.net floor area: 43.7 sq.m/ 471 sq.ft

Local Authority: West Berkshire Council Tax

Band: A

Ground rent £49pw

Approx. Distances:

Distance to Tilehurst Railway Station: 2.6 Miles

Distance to M4 motorway (J12): 2.5 miles

VIEWING STRICTLY BY APPOINTMENT:

T: 0118 941 5607

E: sales@villageproperties.org

W: www.villageproperties.co.uk

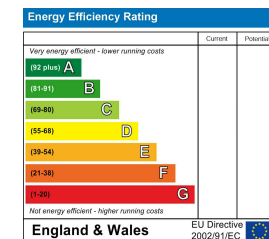

92 School Road
Reading
RG31 5AU