



HEARNES

WHERE SERVICE COUNTS

Canford Magna, Wimborne, Dorset, BH21 3AG

Canford Magna, Wimborne, BH21 3AG

FREEHOLD PRICE GUIDE £1,250,000

A unique opportunity to acquire a character Victorian-Gothic style four double bedroom, four reception room detached residence set in delightful gardens, woodland and paddocks approximately 4.6 acres.

Garden Coppice was constructed in 1959 from the original stone of Bridge House, South Petherton which was the family home of William Blake JP, Deputy Lieutenant in the County of Somerset and ancestor of Jane Seymour. When Bridge House was demolished a buyer was found for the complete façade, including the mullioned windows, in the form of a Dorset bank manager, Mr Taylor, whose hobby was the propagation of acid-loving plants.

Much of the character of the house stems from the honey-coloured stone which was quarried in nearby Ham Hill as was Montacute, Mr Taylor had Garden Coppice built to his own design and created the formal gardens and propagation of the azaleas, rhododendrons and camellias, as well as a wide range of specimen trees which landscape the grounds.

The property affords many noteworthy character features such as panelled walls, oak parquet flooring to the majority of the grounds floor rooms, Gothic style windows, a superb grand oak staircase, a range of custom made walnut and sycamore wardrobes and a stained glass window from Bridge House.

The ground floor accommodation includes an impressive reception hall, sitting room with separate dining room, superb billiard room and Master bedroom with en suite bathroom, study, kitchen/breakfast room and utility with a further three bedrooms and two en suites.

Externally, there is a SUBSTANTIAL GARAGE COMPLEX with two electrically operated roller doors, light and power points, providing space for four vehicles plus a secure store room. The grounds are an important feature of the property, arranged with two paddocks and formal gardens (with extensive lawned areas interspersed with a selection of specimen trees and shrubs, primarily rhododendrons, camellias and azaleas). There is an ornamental fish pond and there are footpaths leading through to hidden gardens and seating areas. LOWER PADDOCK: There is a stable block with four loose boxes, covered workshop, field shelter (built from seasoned English Oak). UPPER PADDOCK: There is a field shelter and woodland garden, leading through to a bluebell wood where there are a variety of wild flowers and meandering footpaths which return to the main house.

EPC RATNG: E

AGENTS NOTE: The heating system, mains and appliances have not been tested by Hearnese Estate Agents. Any areas, measurements or distances are approximate. The text, photographs and plans are for guidance only and are not necessarily comprehensive.





Note: Measurements were not taken by LJT Surveying and we cannot guarantee their accuracy.

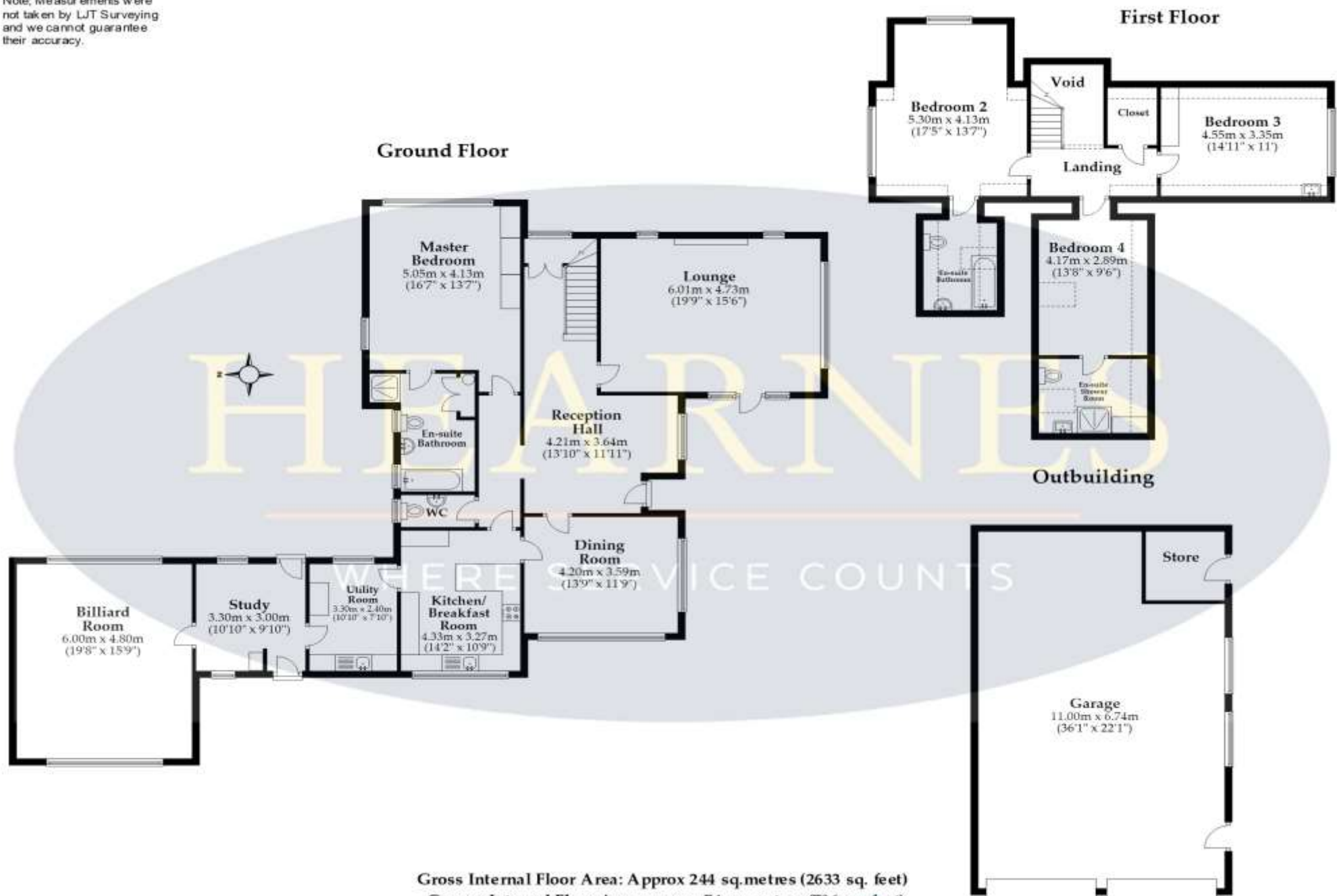

Gross Internal Floor Area: Approx 244 sq.metres (2633 sq. feet)

Garage Internal Floor Area: approx 74 sq.metres (796 sq. feet)

This plan is not to scale and it is for general guidance only. LJT Surveying Ringwood







www.hearnes.com

6 Cook Row, Wimborne, Dorset BH21 1LB

Tel: 01202 842922 Email: Wimborne@hearnes.com

OFFICES ALSO AT: BOURNEMOUTH, FERNDOWN, POOLE & RINGWOOD