



## The Mardle Griston Road, Thetford, IP25 6DN

**£130,000**

**\*\*HELP-TO-BUY AVAILABLE\*\*** Plot 7, The Mardle is a lovely one bedroom apartment with approximately 645 square feet of space. The entrance hall leads through to a spacious kitchen/dining area, with a general room also accessible via the entrance hall with the option of using the general room as a second bedroom if required. Also on offer is a three-piece bathroom suite.

The accommodation is complete with one allocated parking space.

**\*AVAILABLE WITH HELP-TO-BUY\***

With a Help to Buy: Equity Loan the Government lends you up to 20% of the cost of your newly built home, so you'll only need a 5% cash deposit and a 75% mortgage to make up the rest.

You won't be charged loan fees on the 20% loan for the first five years of owning your home.





Floor Plan

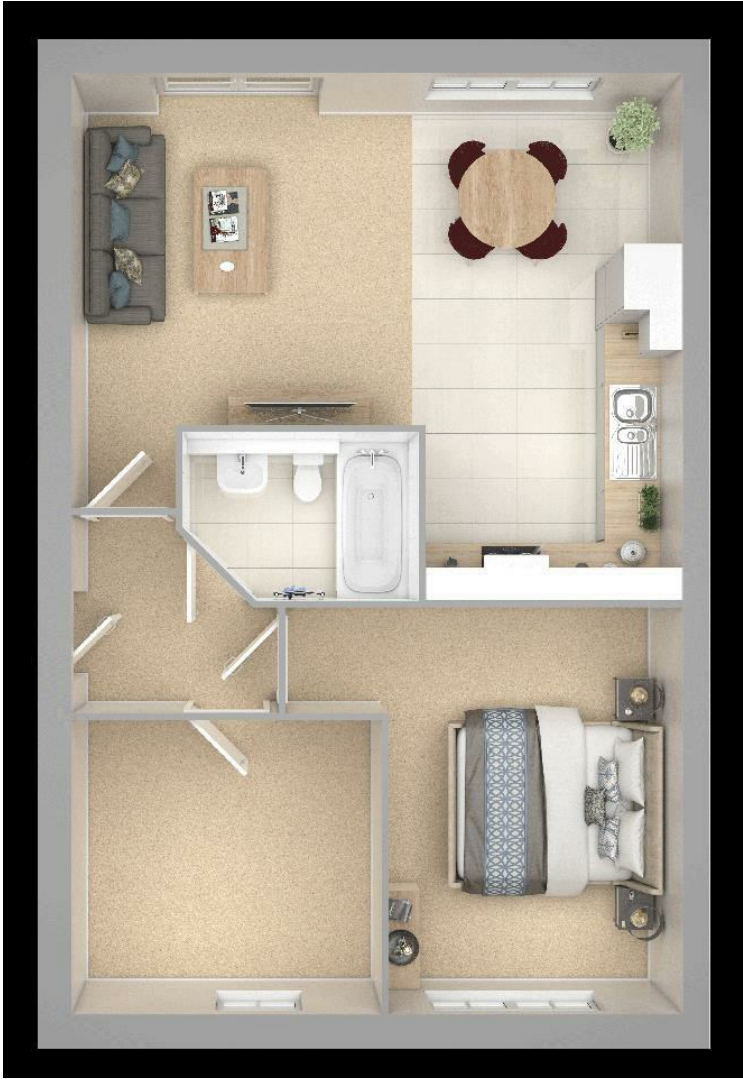

Area Map



Energy Efficiency Graph

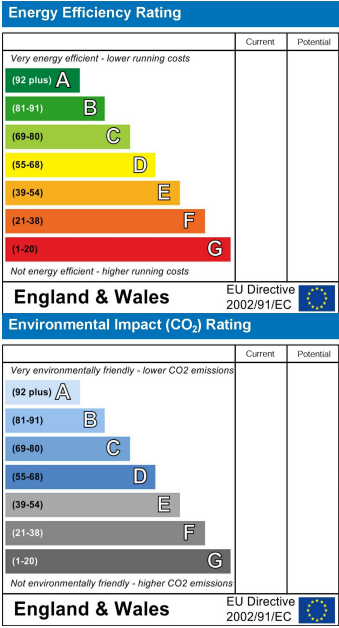

These particulars, whilst believed to be accurate are set out as a general outline only for guidance and do not constitute any part of an offer or contract. Intending purchasers should not rely on them as statements of representation of fact, but must satisfy themselves by inspection or otherwise as to their accuracy. No person in this firm's employment has the authority to make or give any representation or warranty in respect of the property.



T: 01603 558 666  
M: 07435 968375  
E: info@dpsestates.co.uk or maintenance@dpsestates.co.uk  
A: 53 Ber Street, Norwich, Norfolk, NR1 3EU