

SIGNATURE

NORTH EAST

OFFICIALLY RATED THE NO.1 ESTATE AGENT IN THE NORTH EAST





Northbourne Street, Gateshead NE8 4AE

Northbourne Street, Gateshead NE8 4AE

**Offers Over
£54,000**

Positioned within the popular residential area of Gateshead is this two bedroom, ground floor flat. The property is situated close to local transportation links and many local amenities, as well as benefitting from spacious living areas and a private yard.

The property is comprised of an extensive living room with direct access into the kitchen. To the rear of the kitchen there is further access into the bathroom. The property also showcases two generously sized bedrooms with potential for personalisation, creating an ideal home.

Externally there is on street parking to the front with a private rear courtyard.

Gateshead is a popular residential area on the south bank of the River Tyne, directly adjacent to the city of Newcastle upon Tyne which is famous for the modern developments on its quayside, the beautiful Saltwell Park and a modern high street featuring a range of shops, restaurants and bars. The area is also home to the renowned Team Valley Business Park, attracting professionals from all across the North East.



PLEASE NOTE THAT THE VENDOR HAS CERTIFIED THE PROPERTY INFORMATION AND IMAGES.

PROPERTY FLOORPLAN

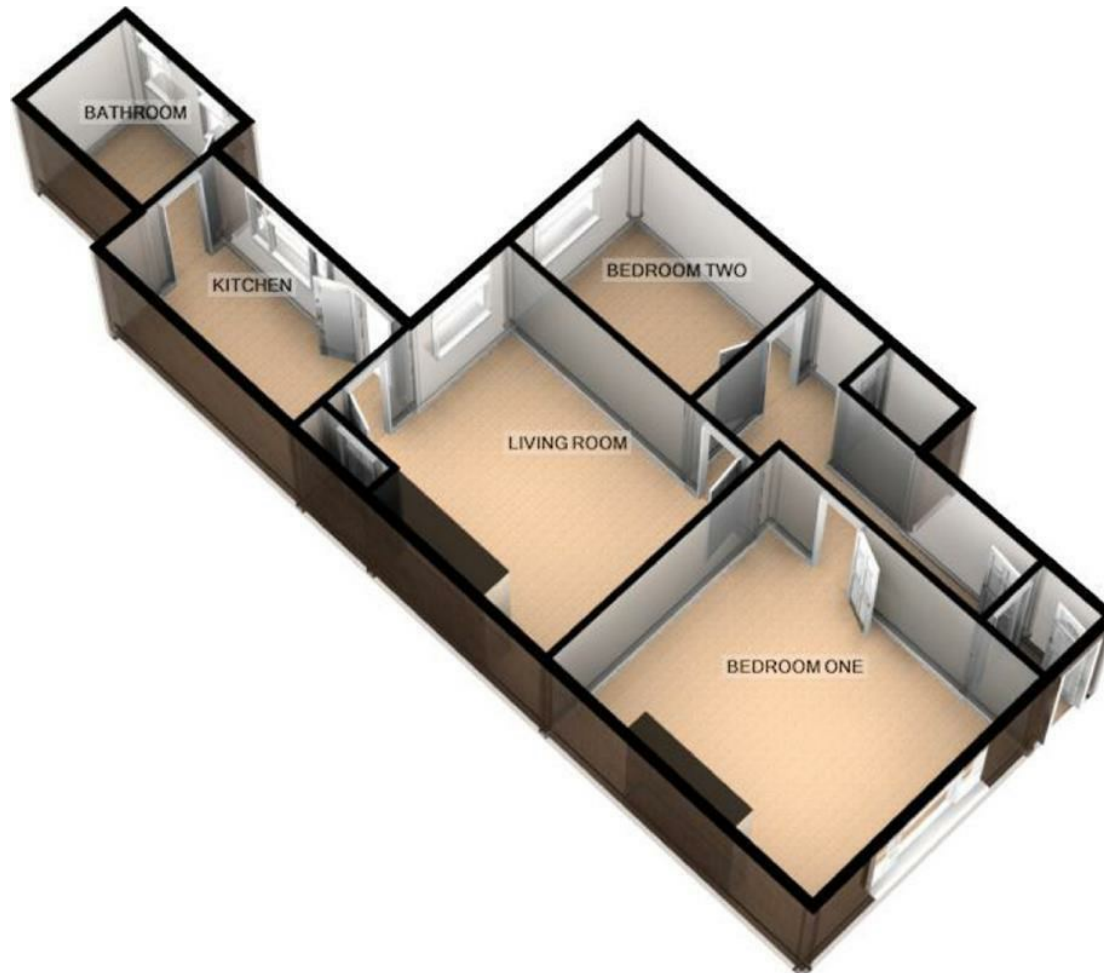

NORTHBOURNE STREET, GATESHEAD

For illustrative purposes only. Decorative finishes, fixtures, fittings and furnishings do not represent the current state of the property. Measurements are approximate. Not to scale
Made with Metropix ©2018

Measurements:

LIVING ROOM
14'4" x 12'2"

KITCHEN
11'7" x 6'7"

BEDROOM ONE
14'4" x 13'3"

BEDROOM TWO
10'5" x 7'8"

BATHROOM
7'7" x 5'9"

Energy Efficiency Rating

	Current	Potential
Very energy efficient - lower running costs		
(92 plus) A		
(81-91) B		
(69-80) C	72	77
(55-68) D		
(39-54) E		
(21-38) F		
(1-20) G		
Not energy efficient - higher running costs		

England & Wales

EU Directive
2002/91/EC







More 5 Star Customer Reviews than any other Agent based in the North East on [allAgents.co.uk](https://allagents.co.uk)

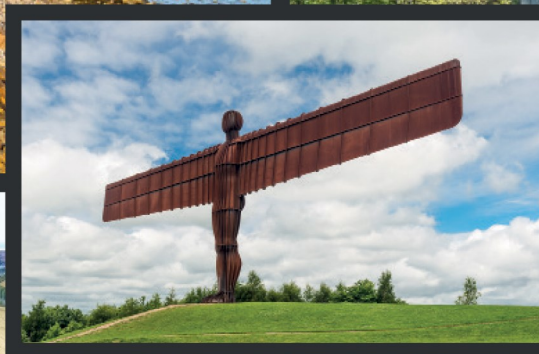

SALES

LETTINGS

FINANCE

LAW

WE COVER THE WHOLE OF THE NORTH EAST

Whitley Bay
0191 251 3344

Cramlington
01670 897 213

Tynemouth
0191 296 6689

Morpeth
01670 897 155

Ponteland
01661 820 082

Wallsend
0191 432 4151

Alnwick
01665 511 800

Heaton
0191 432 4275

Forest Hall
0191 266 9966

Other locations
0191 640 3523

Newcastle
0191 640 2284

Durham
0191 303 8252

Gosforth
0191 640 3523

Sunderland
0191 543 6390

Whickham
0191 432 5102

Gateshead
0191 432 4294

Jesmond
0191 281 1037

Killingworth
0191 640 3602

Ryton
0191 413 9845

Head Office &
Lettings
0191 253 4815

*Highest recommended 5-star reviews than any other Estate Agent based in the North East on [allAgents.co.uk](https://allagents.co.uk) - The UK's Largest Customer Review Website for the Property Industry & Awarded Best Estate Agency 2018 & 2019 - North East England by SME News