



MILES ESTATE AGENTS

**31 Graham Way Cotford St. Luke
Taunton TA4 1JG**



A well presented modern 2 bedroom end terrace house with refitted kitchen and bathroom in this ever popular village north west of Taunton. Lovely enclosed garden, off road parking for 2 cars and immediately available with no onward chain. Early viewing highly recommended.





Features:

- Entrance Hall
- Lounge/Dining Room
- Refitted Kitchen
- 2 Good Size Bedrooms
- Refitted Bathroom
- Lovely Enclosed Garden
- Off Road Parking for 2 Cars
- New Double Glazing
- Immediate Vacant Possession
- No Onward Chain
- Council Tax Band B



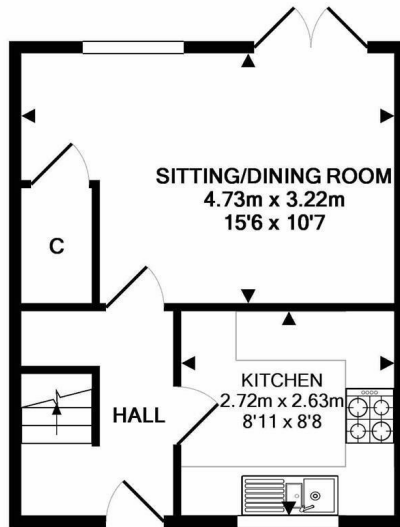

GROUND FLOOR
APPROX. FLOOR
AREA 27.5 SQ.M.
(296 SQ.FT.)

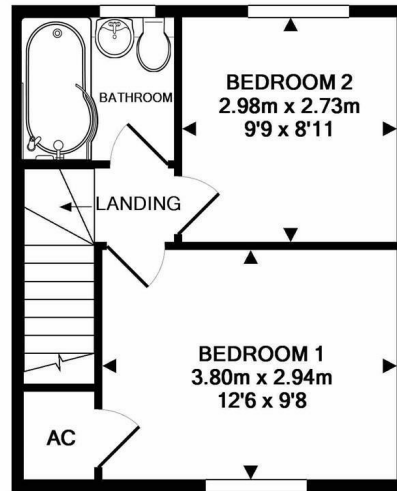

1ST FLOOR
APPROX. FLOOR
AREA 27.5 SQ.M.
(296 SQ.FT.)

TOTAL APPROX. FLOOR AREA 55.1 SQ.M. (593 SQ.FT.)
Made with Metropix ©2019

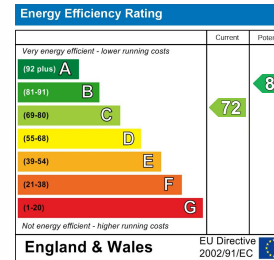

Viewings strictly through the selling agents:

Miles Estate Agents

2 Piffin Lane, Bishops Lydeard, Taunton,
Somerset, TA4 3AS

Tel: 01823 470 500

lydeard@milesestateagents.co.uk

www.milesestateagents.co.uk

rightmove

Zoopla.co.uk

onTheMarket.com

MILES ESTATE AGENTS

