

**Linkfield Road  
Isleworth  
TW7 6QJ**

**£525,000**

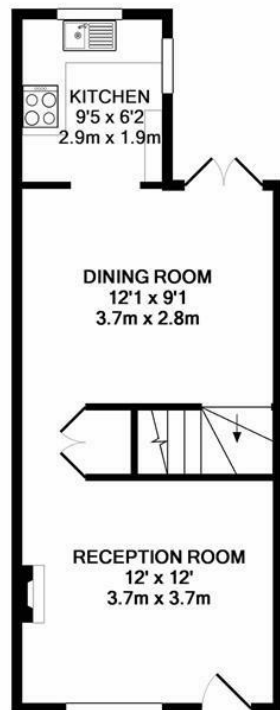

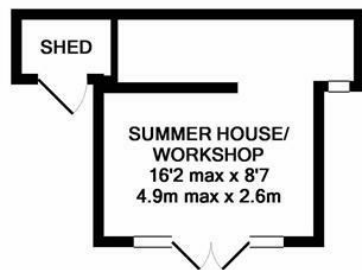

GROUND FLOOR  
APPROX. FLOOR  
AREA 456 SQ.FT.  
(42.3 SQ.M.)



1ST FLOOR  
APPROX. FLOOR  
AREA 341 SQ.FT.  
(31.7 SQ.M.)

TOTAL APPROX. FLOOR AREA 796 SQ.FT. (74.0 SQ.M.)  
Produced solely for Chase Buchanan  
Made with Metropix ©2019

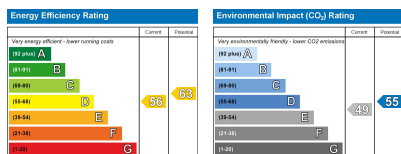

Care has been taken in the preparation of these particulars, however, their accuracy is not guaranteed and they do not form part of any contract. Measurements stated must be considered maximum.

- Viewings accompanied by Chase Buchanan
- Two double bedrooms
- Close to transport links
- Charming Victorian cottage
- Isleworth Village location
- Large rear garden

With views over the pretty St Johns Gardens, Chase Buchanan are pleased to offer to the market a truly charming Victorian cottage situated in one of Isleworth Villages popular roads.

The accommodation comprises a living room, dining room and modern kitchen on the ground floor, whilst the first floor offers the master bedroom with park views, a second bedroom and a family bathroom. Externally the property features a large rear garden with patio area and a summer house/workshop with power and lighting. There is also covered and secure side access providing a perfect area for bike and bin storage. Resident permit parking is readily available on the road.

Situated within a popular school catchment area and within a few minutes walk from Isleworth BR Station as well as the River Thames, with St Margarets and Richmond within easy access.

For more information or to book a viewing, please contact:

**020 8758 1755**

isleworth@chasebuchanan.london

7 Odeon Parade, 480 London Road,  
Isleworth, Middlesex, TW7 4DE

