



PORCHESTER SQUARE, LONDON

£575 Per Week



HYDE PARK AGENCIES LIMITED

Estate agents, valuers, property consultants



PORCHESTER SQUARE, LONDON

A spacious 2 bedroom flat in a popular and secure block facing garden square.

Very close to Bayswater and Queensway stations. Large reception, balcony, separate kitchen, 2 double bedrooms, bathroom. Porter. Lifts. Furnished.

Available from 1st OCTOBER.



£575 PER WEEK

**The Colonnades,
Porchester Square, W2**
Approx. Gross Internal Area *
693 Sq Ft - 64.38 Sq M

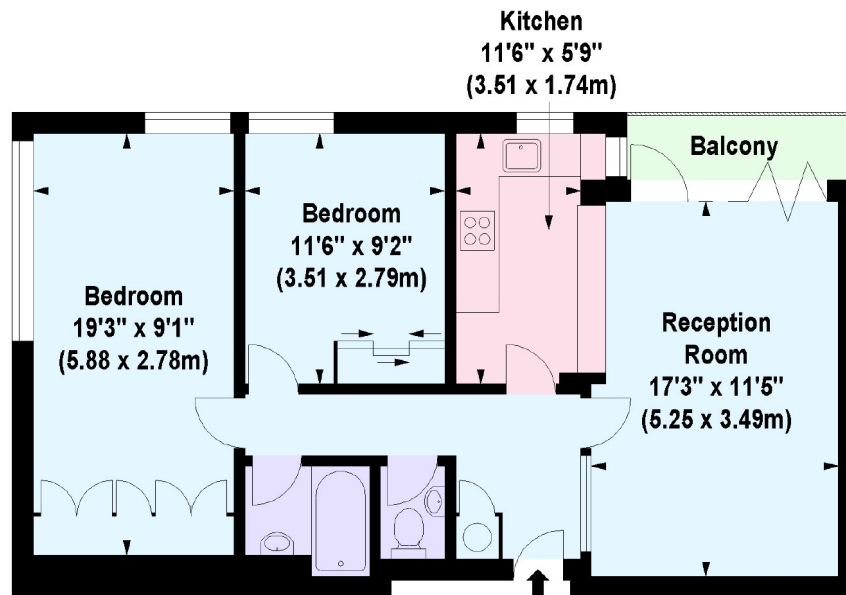

Fourth Floor

Illustration For Identification Purposes Only. Not To Scale
*Floorplan Drawn According To RICS Guidelines
© www.alanaiken.com 2013 (aa)

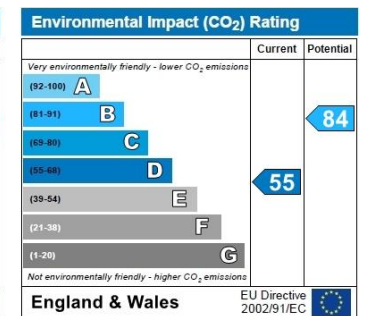
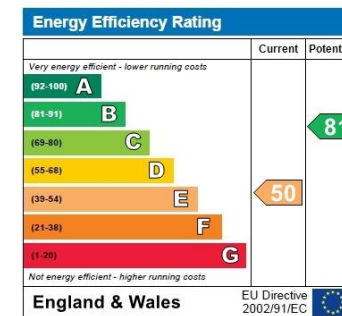

HYDE PARK AGENCIES LIMITED

Estate agents, valuers, property consultants

