



ESTATE AGENTS

ANDREW & CO

IMPORTANT: We would like to inform prospective purchasers that these sales particulars have been prepared as a general guide only, and an illustration purpose which may not be to scale. If there are any important matters likely to affect your decision to buy please contact us before viewing the property. nor the services, appliances and fittings tested. Room sizes should not be relied upon for furnishing purposes and are approximate. If floor plans are included, they are for guidance only and are not drawn to scale, with any doors, windows and other internal features merely intended as a guide.

Astford Office: 2 High Street,
Astford, Kent, TN24 8SQ
E: info@andrewandco.co.uk
01233 632383
www.andrewandco.co.uk

New Romney Office: 24 High Street,
New Romney, Kent, TN28 8BY
E: info@andrewandco.co.uk
01797 362898
www.andrewandco.co.uk

Chertson Office: 30 Chertson High Street,
Folkestone, Kent, CT19 4ET
E: chertson@andrewandco.co.uk
01303 279955
www.andrewandco.co.uk

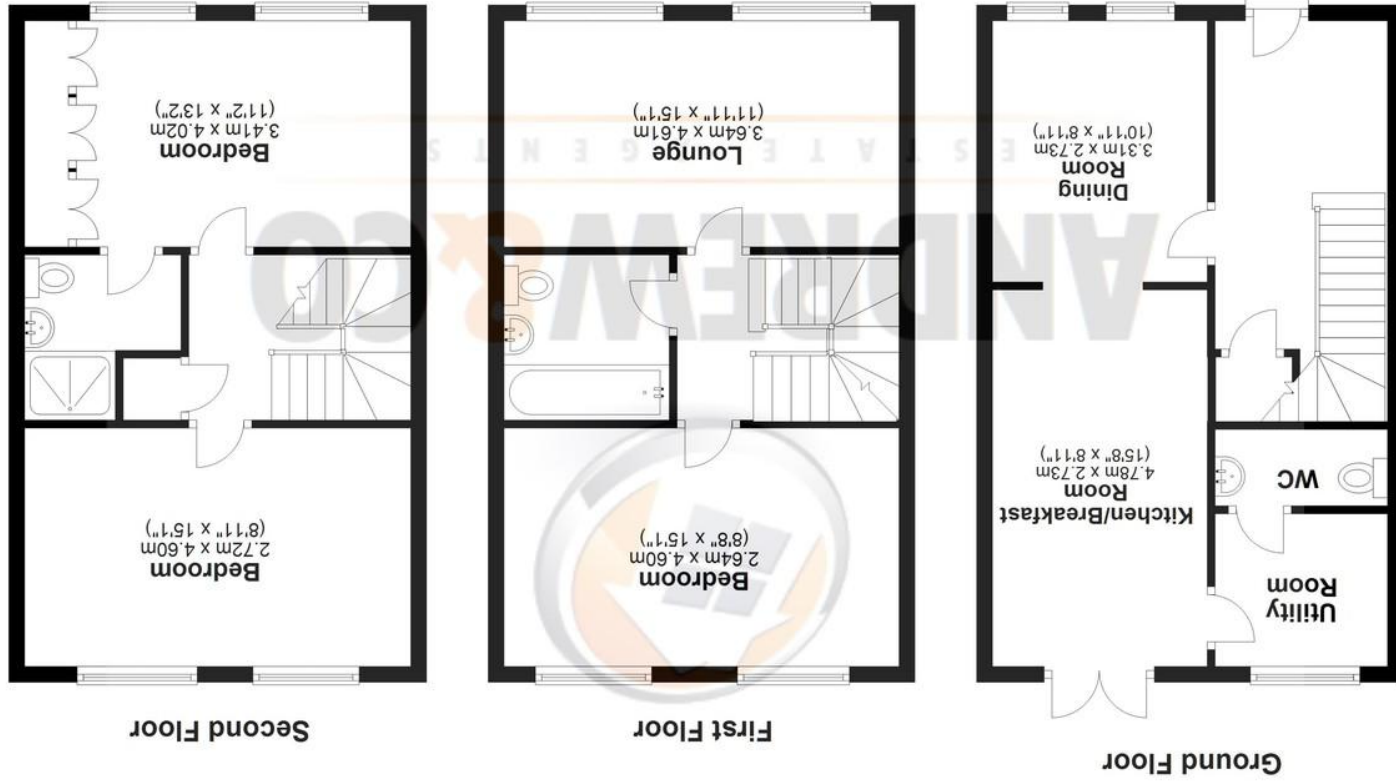

ANDREW & CO

ESTATE AGENTS

38 Royal Star Arcade, High Street, Maidstone, Kent,
ME14 1JL
01622 687698
E: maidstone@andrewandco.co.uk
www.andrewandco.co.uk

17 Melrose Close
Maidstone, ME15 6BD
Asking Price Of £295,000



Located in the very popular area of Loose, within walking distance of schools and local amenities is this bright and airy, modern three bedroom mid terrace family home.

Arranged over three floors, giving that feeling of extra space and the benefit of it being On the ground floor is a spacious hallway, with an under stairs cupboard, dining room or snug and a fabulous sized kitchen breakfast room with patio doors leading to the garden. There is also a very useful utility room and a WC off of there.

On the first floor is the lounge, family bathroom and one of the double bedrooms. Up to the second floor is the master bedroom with en-suite and another double bedroom.

Externally there is a garage, just opposite the property along with a parking space in front.

The property is being offered with no onward chain.

- Three Bedroom Town House
- Large Kitchen/Breakfast Room
- Dining Room
- Lounge To First Floor
- Family Bathroom

For room sizes and layout please refer to the floorplan.

Tenure: Freehold

Local Authority: Maidstone Borough Council

