

Tippett Gardens, Basingstoke, Hampshire RG22 4NT



£230,000 Freehold

BELVOIR! ESTATE AGENTS are pleased to offer to the market this well presented two bedroom property which would make an ideal first time or investment purchase. The ground floor accommodation comprises a traditional entrance hallway, lounge and fitted kitchen. The first floor offers a fitted bathroom and two bedrooms. Further benefits of this property include gas radiator heating, double glazing, driveway parking and an enclosed rear garden

#### LOCATION:

The property is in the popular Old Hatch Warren area and is close to local schools including Hatch Warren Juniors, Asda shopping centre and other local shops. The property is ideally situated for M3 junction 7 and it is also on a regular bus route to the Town Centre with Festival Place shopping centre which has ample shops, restaurants and cinema and main line railway station with fast train to London-Waterloo in approximately 45 minutes

ESTIMATED RENTAL VALUE: Would be in the region of £875 pcm

TENURE: Freehold

LOCAL AUTHORITY: Basingstoke and Deane Borough Council

VIEWING DETAILS: Viewings are strictly by appointment only. Please contact Belvoir Estate Agents





GROUND FLOOR 296 sq. ft.  
(27.5 sq. m.)

1ST FLOOR 296 sq. ft.  
(27.5 sq. m.)

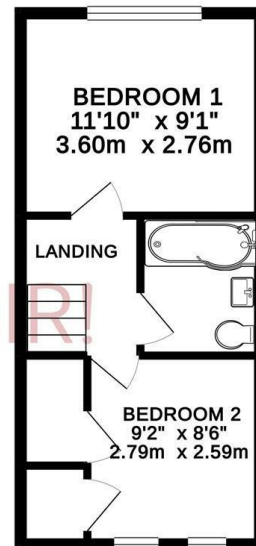
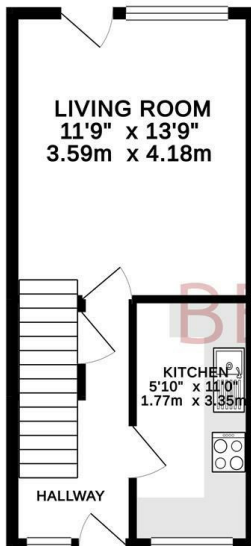
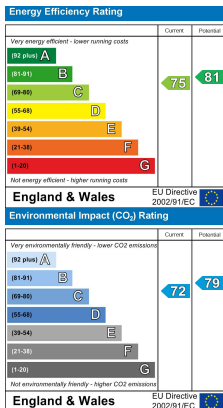

TOTAL FLOOR AREA: 593 sq. ft. (55.1 sq. m.) approx.

Whilst every attempt has been made to ensure the accuracy of the floorplan contained herein, measurements of doors, windows, rooms and any other items are approximate and no responsibility is taken for any error, omission or mis-statement. This plan is for illustrative purposes only and should be used as such by any prospective purchaser. The services, systems and appliances shown have not been tested and no guarantee as to their operability or efficiency can be given.  
Made with Metagame C3D3D

These particulars are intended as a guide and act as information only.  
They give a fair overall description for the guidance of potential purchasers, but do not constitute an offer or part of a contract.  
All details and approximate measurements are given in good faith and are believed to be correct at the time of printing