



Esmond Road, London, W4 1JQ

£199,950

WHITMAN & CO.

SALES · LETTINGS · COMMERCIAL

- Well presented Studio flat
- Top floor
- CASH BUYERS ONLY
- Within the heart of Bedford Park
- No chain

Tenure - Leasehold (150 years)
 Service charge - % of outgoings
 Ground Rent- £250 pa
 Local authority - Ealing
 Council tax - Band C

THE PROPERTY

A well presented top floor studio flat set within this majestic period property ideally located in the heart of the Bedford Park Area. 16'9 Studio Room, fitted kitchen, shower room, new lease. Within a short walk of the extensive shopping and restaurant facilities of Chiswick High Road. Local transport links include Turnham Green (tube) Station, local bus routes and vehicular access via the A4/M4 to central London and Heathrow. No chain. CASH BUYERS ONLY.

Esmond Road, W4

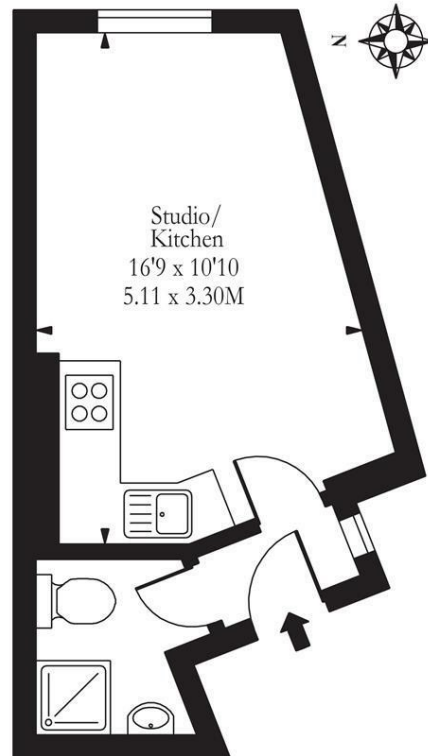

Second Floor

Approx Gross Internal Area 209 Sq Ft - 19.42 Sq M

Illustration Purposes Only

Whilst every attempt has been made to ensure the accuracy of the floor plan contained here, measurements of doors, windows, rooms and any other items are approximate and no responsibility is taken for any errors, omissions or mis-statements. The plan is for illustrative purposes only, is not to scale and should be used as such by any prospective purchaser.

SITUATION



5-7 Turnham Green Terrace, Chiswick, London, W4 1RG

Tel 020 8747 8800

E-mail sales@whitmanandco.com

Website www.whitmanandco.com