



28 Columbell Way
Two Dales, Matlock, DE4 2SA
£240,000

28 Columbell Way

Two Dales, Matlock, DE4 2SA

••3D TOUR•• £240,000 - £250,000 (Guide price) Within walking distance to local shops and amenities on the flat in the highly desirable Peak District town of Darley Dale is this modern and low maintenance 2 bedroom semi detached bungalow, surrounded by similar properties and briefly comprises of an entrance hall, spacious lounge diner, modern kitchen, two good sized bedrooms and a bathroom. Externally the property benefits from two parking spaces and reasonably low maintenance flat gardens.





Floor Plan

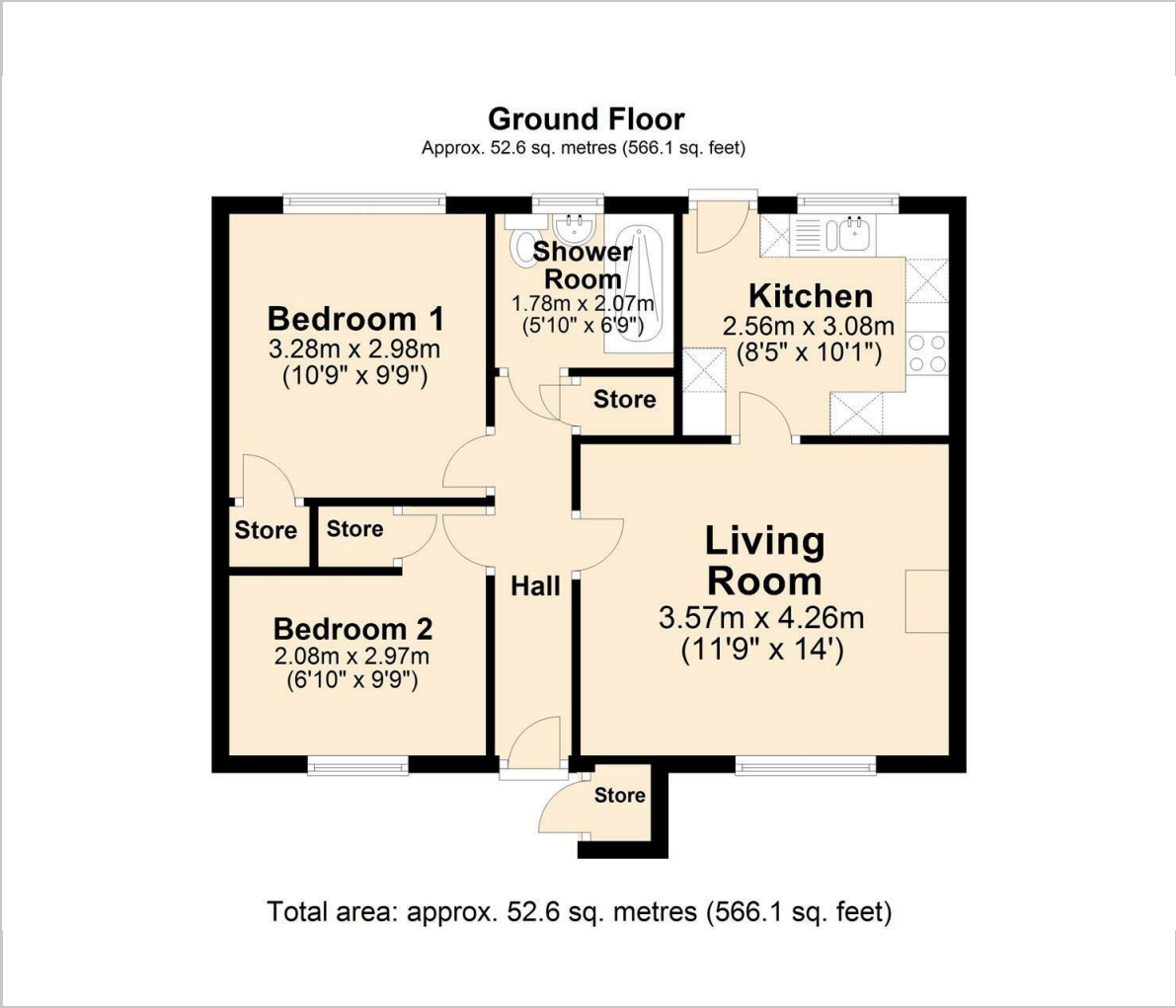

Viewing

Please contact our Dales and Peaks Office on 01246 567540 if you wish to arrange a viewing appointment for this property or require further information.

These particulars, whilst believed to be accurate are set out as a general outline only for guidance and do not constitute any part of an offer or contract. Intending purchasers should not rely on them as statements of representation of fact, but must satisfy themselves by inspection or otherwise as to their accuracy. No person in this firms employment has the authority to make or give any representation or warranty in respect of the property.

Area Map



Energy Efficiency Graph

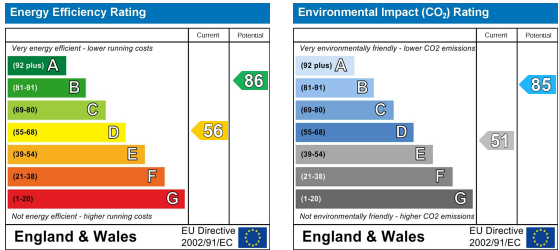

T: 01246 567540



E: info@dalesandpeaks.co.uk
www.dalesandpeaks.co.uk