



ESTATE AGENTS

ANDREW & CO

IMPORTANT: We would like to inform prospective purchasers that these sales particulars have been prepared as a general guide only, and an illustration purpose which may not be to scale. If there are any important matters likely to affect your decision to buy please contact us before viewing the property.

Ashford Office: 2 High Street,
Ashford, Kent, TN24 8SQ
E: info@andrewandco.co.uk
01233 632383
www.andrewandco.co.uk

New Romney Office: 24 High Street,
New Romney, Kent, TN28 8BY
E: info@andrewandco.co.uk
01797 362898
www.andrewandco.co.uk

Chertson Office: 30 Chertson High Street,
Folkestone, Kent, CT19 4ET
E: chertson@andrewandco.co.uk
01303 279955
www.andrewandco.co.uk

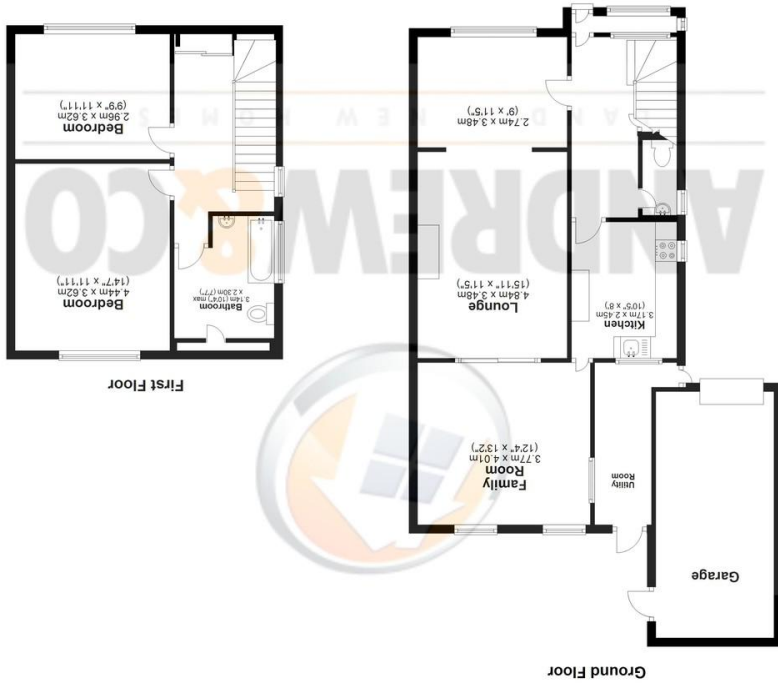

ANDREW & CO

ESTATE AGENTS

24 High Street, New Romney, Kent, TN28 8BY
01797 362898
E: newromney@andrewandco.co.uk
www.andrewandco.co.uk

21 Baldwin Road
New Romney, TN28 8SY
£270,000



If you are looking for a lovely property that has been well maintained but want to put your own stamp on it this is the one for you. Located in a quite position in Greatstone is this deceptively spacious extended Chalet Bungalow with a drive and garage.

The entrance porch will lead you to the spacious entrance hall with a handy ground floor cloakroom. Currently, there is a dining area that in the past has been a ground floor bedroom which could easily be reinstated depending on your requirements. Moving to the bright sunny lounge and through the patio

doors into a third reception room with views over the low maintenance private garden. This property also benefits from a good sized kitchen and a utility room.

On the first floor is the family bathroom, two double bedrooms the master with lovely views benefits from fitted wardrobes and really handy eves storage. This property is nicely presented and well maintained throughout, the vendor has advised us that the boiler was fitted in 2017 so you don't have to be concerned about that. With no onward chain

- Chalet Bungalow
- Two/ Three bedrooms
- Semi Detached
- Quite Location
- Deceptively Spacious

this property is ready for you to move into.

Room Sizes

- Entrance Porch
- Entrance Hall
- Cloakroom
- Lounge Room 15'10 x 11'5 (4.84m x 3.50m) into recess
- Dining Room/Bedroom Three 11'5 x 8'11 (3.48m x 2.74m)
- Family Room 13'5 x 12'4 (4.01m x 3.77m)
- Kitchen 10'4 x 8'0 (3.17m x 2.45m)
- Utility Room

- Bedroom 14'6 x 10'7 (4.44m x 3.25m)
- Bedroom 11'10 x 9'8 (3.62m x 2.96m)
- Family Bathroom

- Garden to the Front
- Garden to the Rear
- Driveway
- Garage

