



3 Fairway Court, Gateshead, NE8 2AY

Offers Over £170,000

Hive Estates presents this stunning 2 bedroom, 2 bathroom corner apartment to the market with dual aspect open plan kitchen, dining and living space featuring a private balcony, a terrace and a second Juliet balcony. It has private parking and is located in a modern development of residential apartments in Ochre Yards, a Bellway development on the Gateshead Quays.

LIVING AND DINING SPACE 17'1" x 21'8" (5.21 x 6.60)

KITCHEN SPACE 9'10" x 6'1" (3.00 x 1.85)

MASTER BEDROOM 12'7" x 9'10" (3.84 x 3.00)

EN-SUITE TO MASTER 8'3" x 6'7" (2.51 x 2.01)

BEDROOM TWO 10'6" x 11'8" (3.20 x 3.56)

MAIN BATHROOM 7'8" x 3'4" (2.34 x 1.02)

Hive Estates presents this stunning 2 bedroom, 2 bathroom corner apartment to the market with dual aspect open plan kitchen, dining and living space featuring a private balcony, a terrace and a second Juliet balcony. It has private parking and is located in a modern development of residential apartments in Ochre Yards, a Bellway development on the Gateshead Quays.

The apartment comprises of a secure entry intercom system, with communal hallway and entrance into the apartment. There's a curved hallway, with spotlighting, and a large storage cupboard to the side. The living space is open into the dining area and kitchen, divided by a glass screen with a unique layout allowing for a large balcony with double French doors, with matching window to the side for natural light. There's laminate flooring and a modern fitted kitchen with ventilation system, integrated appliances that include a dishwasher, washer/dryer, fridge/freezer and oven and hob with extractor hood. The dining space is large enough for a set of table and chairs and has a Juliet balcony and opening French door.

Both bedrooms are doubles, with the master featuring a tiled en-suite shower room with sunken shelving and space for bedroom furniture and a king size bed. The second bedroom has French doors leading to a side terrace, with plenty of space for additional outside seating. The property has electric heating, double glazing and private parking out the front with easy access into the City Centre.

Floor Plan

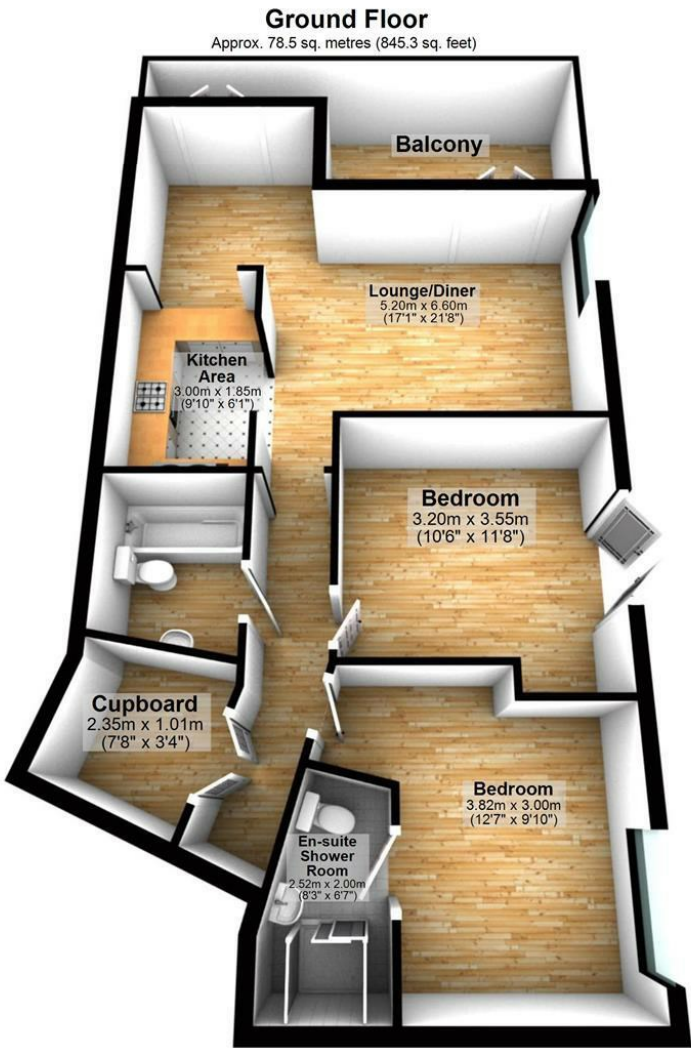

Total area: approx. 78.5 sq. metres (845.3 sq. feet)

Area Map



These particulars, whilst believed to be accurate are set out as a general outline only for guidance and do not constitute any part of an offer or contract. Intending purchasers should not rely on them as statements of representation of fact, but must satisfy themselves by inspection or otherwise as to their accuracy. No person in this firms employment has the authority to make or give any representation or warranty in respect of the property.

Energy Efficiency Graph

