



Station Road, Brough, HU15

£104,950



 1  1  1  C Band: A

- Charming Period Cottage
- Beautifully Presented
- One Double Bedroom
- En-Suite Bathroom
- Majority PVCu D.G. & Gas C.H.
- Private Enclosed Rear Yard
- Highly Convenient Location
- Chain Free!





Offered with no chain, this charming and beautifully presented period cottage is situated on Station Road in Brough, within easy reach of Brough Railway Station, popular local pubs, and the many facilities and amenities on offer in both Brough and Elloughton. The cottage itself is fitted with gas central heating and majority PVCu double-glazing. The ground floor comprises a living room and fitted kitchen, whilst the first floor comprises a landing with a large double bedroom with an en-suite bathroom. To the front of the property is small enclosed garden, whilst to the rear is a private, fully enclosed yard with pedestrian access via a shared side passage. Street parking is available with a resident's parking permit. This is a wonderful little cottage in a highly convenient location, so contact Hudson Property now to book your viewing!

Fixtures & Fittings: Everything in the property is included in the sale.





Ground Floor

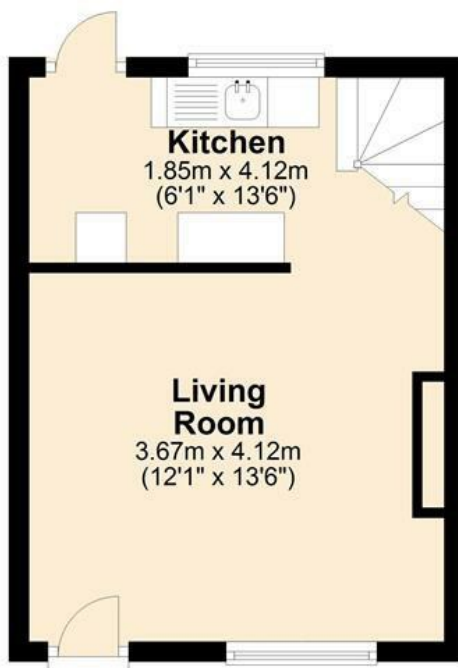

First Floor



MEASUREMENTS: Please note that all measurements are approximate. **STAMP DUTY:** Many property purchases are subject to Stamp Duty Land Tax, and the rules governing stamp duty and the levies imposed are complex. HM Revenue & Customs have an online calculator to assist you in calculating your stamp duty liability (<https://www.gov.uk/stamp-duty-land-tax>) but please always check with your solicitor. **COPYRIGHT:** All photographs and images are the exclusive property of Hudson Property Angels Limited and are protected by copyright law. The images may not be reproduced, copied, transmitted or manipulated without the written consent of a director of Hudson Property Angels Limited.