



- Mid Terrace House
- Four Double Bedrooms
- Two Reception Rooms
- Kitchen
- Family Bathroom
- Two Additional WCs
- Cellar Storage Space
- Rear Courtyard Garden
- Popular Location
- Gas Central Heating & Double Glazing

Property Summary

Maitlands are delighted to offer to the market this spacious mid terrace house which is situated in the popular location of stoke. The property is over three storeys and boasts; four double bedrooms, two reception rooms, a good size kitchen, family bathroom, two additional WCs, cellar storage and a rear courtyard garden.

EPC Rating: D **Tenure:** Freehold



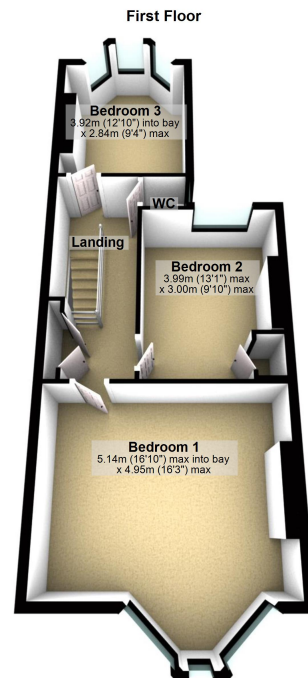
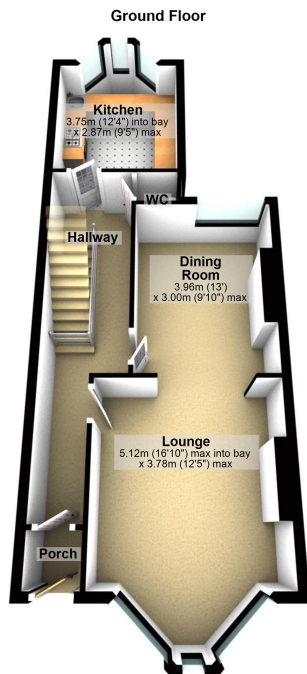
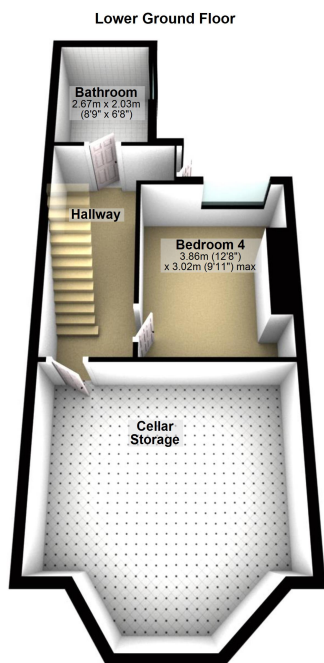

Directions

From the Milehouse junction head down Wolseley Road until you reach the roundabout; take the first exit onto St Levans Road, at the traffic lights turn left on to Ford Hill, turn right on to Pasley Street and the property is on the right hand side.

Available for viewing 7 days a week.

Contact us today.

Maitlands Plymouth

t: 01752 661000

e: plymouth@maitlands.biz

3 Plymouth Road, Plympton, Devon, PL7 4JP

www.maitlands.biz

The vendor has advised us that the information contained within these particulars is correct to the best of the vendors knowledge. With regard to appliances and electrical installations, we have not tested any items detailed in these particulars and any prospective purchaser should satisfy themselves with regard to their condition. All fixtures and fittings as mentioned in our sales particulars are included; all others are expressly excluded. All measurements are approximate. All floor plans of properties are not drawn to scale and are for information only.



Want to know more?

We recognise that buying a property is a big commitment and therefore recommend that you visit the following websites for further information about the property and local area.

www.environment-agency.gov.uk

www.landregistry.gov.uk

www.plymouth.gov.uk