

Toddington Office:

**01525 877 300**



**HOUSEHOLD**  
estate agents

Residential Sales • Property Management • Lettings

**7 Chapel Close, Toddington, Bedfordshire, LU5 6AY**  
**£895 Per Month**



Household Letting Agents are pleased to offer for rent this delightful two bed semi detached bungalow which has just been refurbished throughout to include a brand new kitchen with separate dining room in the popular village of Toddington. Ideally located for the commuter with rail and motorway links both being within a short drive. This property is available now and we would suggest an early viewing.

• Two Bed Bungalow • Village  
Location • Lounge • Dining  
Room • Unfurnished • Available Now • Cul De  
Sac • Excellent Condition

For details on all of our properties for sale and for rent visit [www.house-hold.co.uk](http://www.house-hold.co.uk)

**PRS** Property  
Redress  
Scheme

**Zoopla.co.uk**

movewithus  
recommended agent

**onTheMarket.com**

**rightmove**  
find your happy

**The Property Experts with the Personal Touch**

# Floor Plan

## Ground Floor

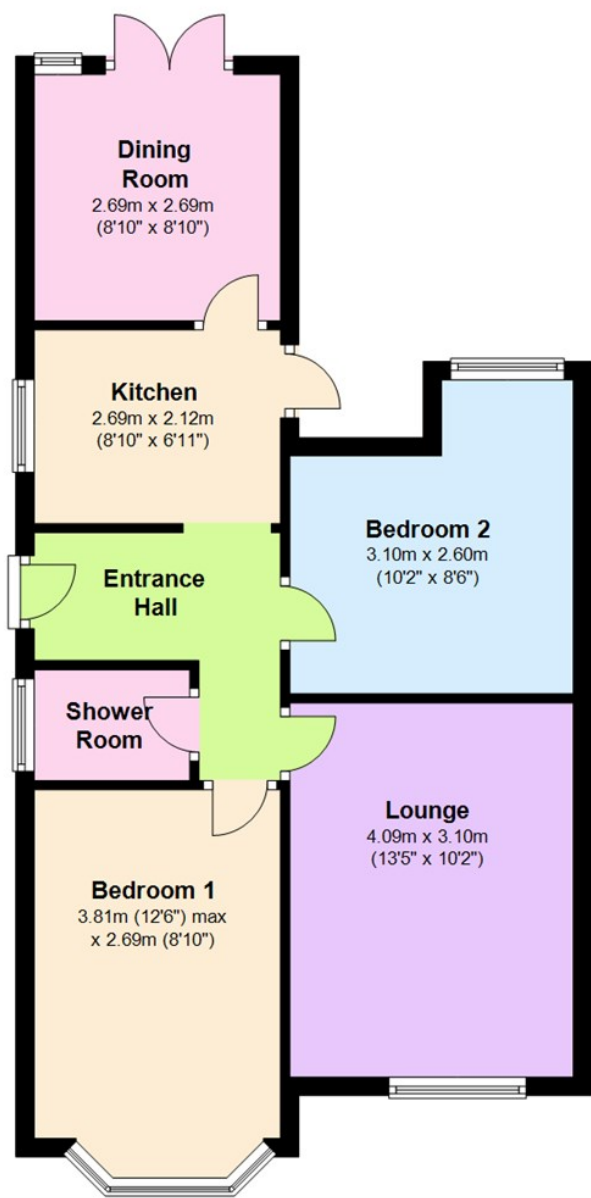

## EPC

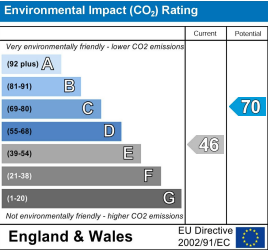
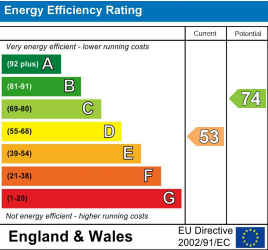

address: 2-4 High Street, Toddington,  
Bedfordshire LU5 6BY  
telephone: 01525 877 300  
email: [lettings@house-hold.co.uk](mailto:lettings@house-hold.co.uk)  
website: [www.house-hold.co.uk](http://www.house-hold.co.uk)

Additional Office: **Dunstable:** 15b High Street  
North - 01582 608 911

## The Property Experts with the Personal Touch

**MISDESCRIPTIIONS ACT:** Household Estate Agents Ltd. For themselves and for the vendors of this property, whose agents they are, give notice that the particulars are set out as a general outline only for the guidance of intended purchasers and do not constitute or constitute part of any offer or contract. All descriptions, dimensions reference to condition and necessary permissions for use and occupation and other details are given without responsibility, and any intending purchasers should not rely upon them as statements or representations of fact but must satisfy themselves by inspection or otherwise as to their correctness. No person in the employment of Household Estate Agents Limited has any authority to give or make any representation or warranty whatsoever in relation to this property.