





- **Spacious Home**
- **Two Box Rooms**
- **Lounge-Diner**
- **Close to Amenities**
- **Four Bedrooms**
- **Sitting Room**
- **Popular location**
- **Viewing Recommended**





Offered for sale this spacious four bedroom home is sure to impress. The property is located within a popular residential area and will appeal to a variety of buyers.

Close to local amenities and just a short walk from the popular Saltwell Park, the property briefly comprises to the ground floor:- entrance hallway, sitting room/bedroom three, spacious lounge/diner, kitchen with fitted units, modern bathroom with shower over the bath and bedroom four. To the first floor there are a further two double bedrooms and two box rooms. The property also benefits from gas central heating and double glazing. Externally there is a private rear yard.

Viewings come highly recommended. For more information and to book your viewing please call our Low Fell sales team.



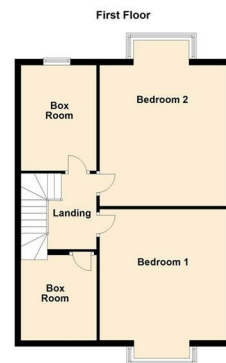

The difference between house and home

You may download, store and use the material for your own personal use and research. You may not republish, retransmit, redistribute or otherwise make the material available to any party or make the same available on any website, online service or bulletin board of your own or of any other party or make the same available in hard copy or in any other media without the website owner's express prior written consent. The website owner's copyright must remain on all reproductions of material taken from this website.



www.janforsterestates.com

Lounge Diner 14'9" x 22'0" (4.52 x 6.71)

Sitting Room/Bedroom Three 14'1" x 13'7" (4.30 x 4.16)

Kitchen 12'2"x 9'6" (3.71x 2.90)

Bedroom One 13'6" x 14'5" (4.12 x 4.41)

Bedroom Two 13'6" x 14'11" (4.12 x 4.56)

Bedroom Four 8'3" x 7'11" (2.53 x 2.42)

Box Room 11'5" x 6'11" (3.48 x 2.11)

Box Room 9'1" x 6'11" (2.77 x 2.11)

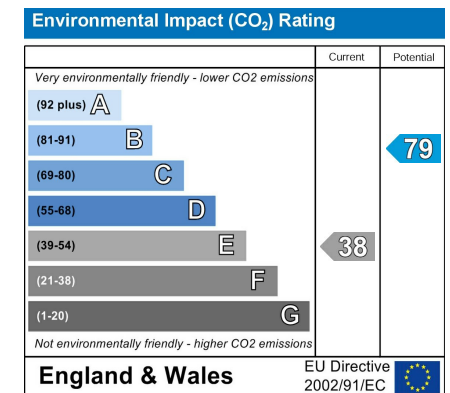
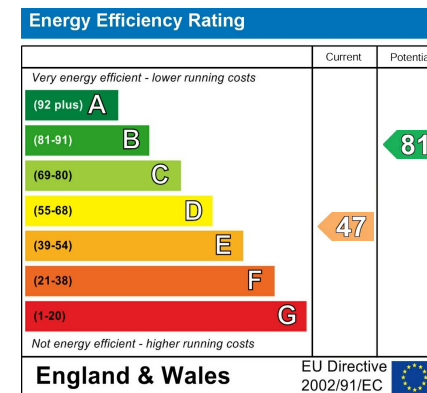

Gosforth 0191 236 2070
 Newcastle 0191 284 4050
 Forest Hall 0191 605 3134
 High Heaton 0191 270 1122
 Low Fell 0191 487 0800
 Tynemouth 0191 257 2000
 Whitley Bay 0191 251 3000
 Property Management Centre 0191 236 2680

