



## SECURE TWO BEDROOM RETIREMENT APARTMENT

Chorleywood Lodge, Chorleywood Lodge Lane, Chorleywood, Hertfordshire WD3 5BY

**ROBSONS**

## CHAIN FREE TWO BEDROOM RETIREMENT APARTMENT

GROUND FLOOR • LIVING ROOM • FITTED  
KITCHEN • TWO BEDROOMS • SHOWER ROOM  
• UNDERFLOOR HEATING • COMMUNAL  
LOUNGE & CONSERVATORY • ON SITE STAFF  
• 24 HOUR EMERGENCY CALL SYSTEM &  
WARDEN CONTROLLED • SET IN 3.645 ACRES  
of LANDSCAPED COMMUNAL GARDENS •  
RESIDENTS & VISITORS CAR PARK • SERVICE  
CHARGE INCLUDES: HEATING, LIGHTING,  
WATER AND BUILDING INSURANCE

A well-presented two bedroom apartment situated in the picturesque village of Chorleywood.

The property comprises a fitted kitchen and living room together with two bedrooms and shower room. The living room leads onto the extensive landscaped communal grounds.

In addition, there is an option to extend the level of care with more optional services provided by the care home eg: catering, laundry and cleaning.

For more information please visit [www.barchester.com](http://www.barchester.com)





Beaumont House lies within a short walk from Chorleywood Common together with the historic 250 acre Chorleywood House Estate, which is an area of outstanding natural beauty with wonderful walks and views over the River Chess.

Chorleywood & Rickmansworth town centres are within reach with their wide choice of boutique shops, coffee houses, restaurants and major supermarkets.

The stations provide a frequent service to London Baker Street and The City as well as the Chiltern Turbo to Marylebone.

Transport links are excellent with junction 18 of the M25 close by with links to the major motorway network and airports.

Guide Price: on Application

Tenure: Leasehold

Local Authority: Three Rivers District Council

Energy Efficiency Rating: Band B



Chorleywood Lodge, Flat 12, Chorleywood Lodge Lane  
Approximate Gross Internal Area  
616 sq ft /57 sq m

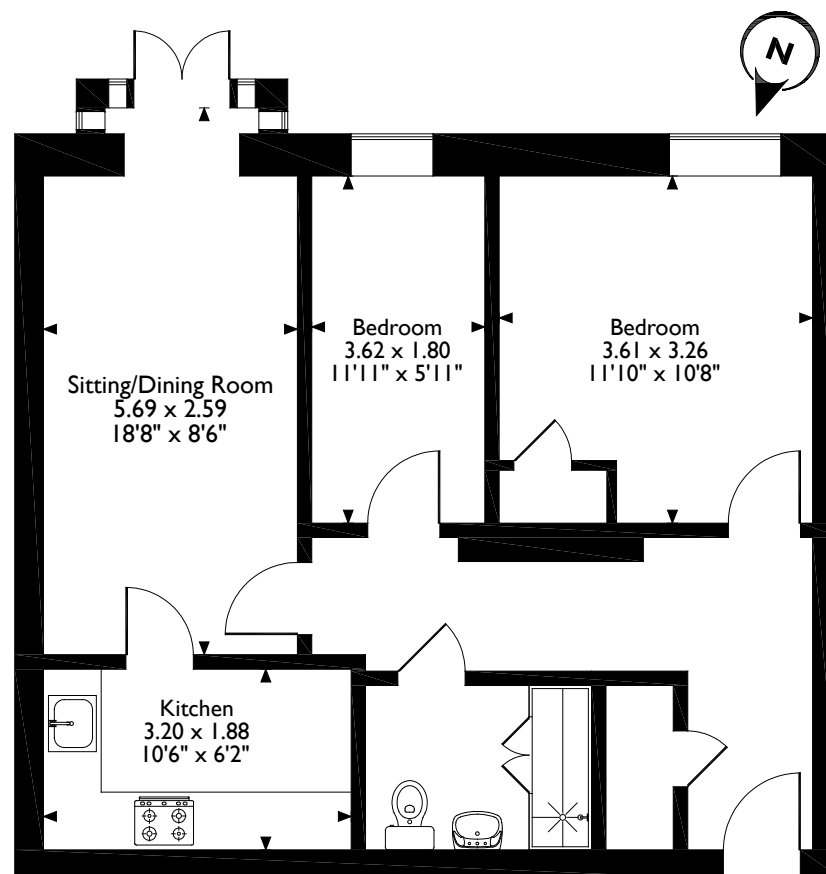

Please note that the location of doors, windows and other items are approximate and this floorplan is to be used for illustrative purposes only. Unauthorized reproduction is prohibited.

**ROBSONS**

2 New Parade, Chorleywood, Hertfordshire, WD3 5NJ

Tel: 01923 285525 [chorleywood@robsonswb.com](mailto:chorleywood@robsonswb.com)

[www.robsonswb.com](http://www.robsonswb.com)

[www.the-londonoffice.co.uk](http://www.the-londonoffice.co.uk)  
40 ST JAMES'S PLACE SW1

Important notice: Robsons, their clients and any joint agents give notice that 1: They are not authorised to make or give any representations or warranties in relation to the property either here or elsewhere, either on their own behalf or on behalf of their client or otherwise. They assume no responsibility for any statement that may be made in these particulars. These particulars do not form part of any offer or contract and must not be relied upon as statements or representations of fact. 2: Any areas, measurements or distances are approximate. Plot sizes and dimensions are taken from Promap and are approximate. The text, photographs and plans are for guidance only and are not necessarily comprehensive. It should not be assumed that the property has all necessary planning, building regulation or other consents and Robsons have not tested any services, equipment or facilities. Purchasers must satisfy themselves by inspection or otherwise.