



Everything you need to know about:

Luckhurst Road,
WILLESBOROUGH, Willesborough,
Ashford, TN24 0UL



rightmove
find your happy

onTheMarket.com





Introduction



The Property



Property Prices



Local Authority



Transport Links

Education



Health



Local Amenities



Local Policing



Census





An invaluable insight into your new home

This Location Information brochure offers an informed overview of **Luckhurst Road** as a potential new home, along with essential material about its surrounding area and its local community. It provides a valuable insight for any prospective owner or tenant.

We wanted to provide you with information that you can absorb quickly, so we have presented it as visually as possible, making use of maps, icons, tables, graphs and charts. Overall, the brochure contains information about:

- **The Property** - including property details, floor plans, room details, photographs and Energy Performance Certificate.
- **Transport** - including locations of bus and coach stops, railway stations and ferry ports.
- **Health** - including locations, contact details and organisational information on the nearest GPs, pharmacies, hospitals and dentists.
- **Local Policing** - including locations, contact details and information about local community policing and the nearest police station, as well as police officers assigned to the area.
- **Education** - including locations of infant, primary and secondary schools and Key Performance Indicators (KPIs) for each key stage.
- **Local Amenities** - including locations of local services and facilities - everything from convenience stores to leisure centres, golf courses, theatres and DIY centres.
- **Census** - We have given a breakdown of the local community's age, employment and educational statistics.





LUCKHURST ROAD, WILLESBOROUGH £280,000



x3
Bedrooms



x2
Living Rooms



x1
Bathrooms

Where you are

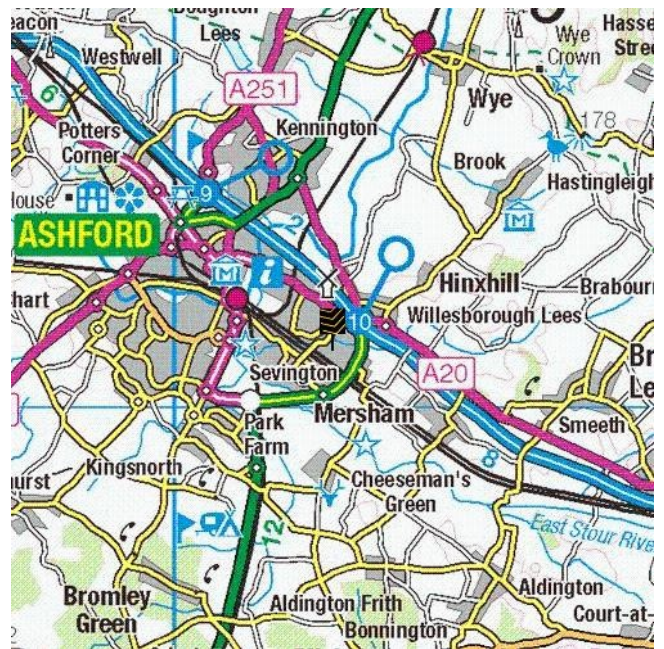

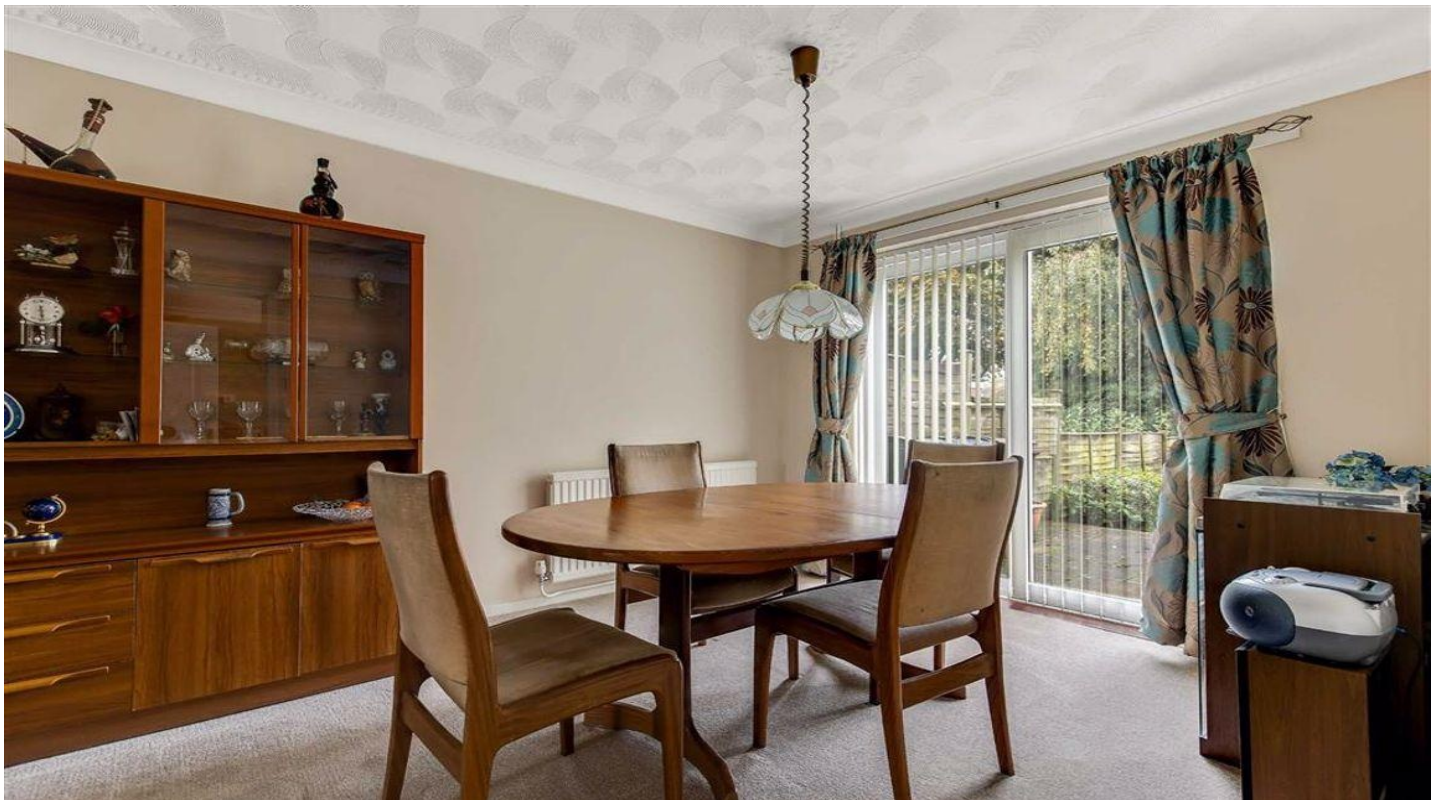



Ideally located for local schools and transport links is this semi detached home, in the same ownership for the last 41 years. The pleasantly appointed accommodation comprises an entrance porch and hall, sitting room, dining room, kitchen and cloakroom with three bedrooms and bathroom to the first floor. The rear garden is enclosed with the property benefitting from gas central heating, double glazing, driveway and garage.

- **Front Porch** - Double glazed with casement door to:
- **Entrance Hall** - Stairs to first floor with double glazed feature window to side, coved ceiling, radiator, small under stairs storage cupboard housing consumer unit and further large storage cupboard.
- **Downstairs Cloakroom** - Low level WC, wall mounted hand basin, tiled wall finish, double glazed window to side.
- **Kitchen** - Double glazed window to side, double glazed casement door to rear, fitted wall and base units with oak effect fronted cupboards, stainless steel 1½ bowl sink with mixer tap and drainer unit, plumbing and space for washing machine, double low level electric oven and four ring induction, cupboard housing gas fired boiler (installed 2016).
3.30m x 2.29m (10'10 x 7'6)
- **Sitting Room** - Double glazed window to front, radiator, TV aerial point, wall mounted gas fire.
4.22m x 3.18m (13'10 x 10'5)
- **Dining Room** - Open arch through from the lounge. Double glazed sliding patio doors to rear, radiator.
4.14m x 2.77m (13'7 x 9'1)
- **First floor:** -
- **Landing** - Loft access with ladder, large storage cupboard at the top of the stairs, double glazed window to side, doors to:
- **Bedroom One** - Double glazed window to front, radiator, coved ceiling, built in wardrobe.
4.29m x 2.95m (14'1 x 9'8)
- **Bedroom Two** - Double glazed window to rear, radiator, coved ceiling, built in wardrobes, large storage cupboard.
3.33m x 3.15m (10'11 x 10'4)
- **Bedroom Three** - Double glazed window to front, radiator, built in storage cupboard.
2.08m x 2.03m +door recess (6'10 x 6'8 + door recess)
- **Bathroom/WC** - Double glazed frosted window to rear, modern white suite comprising panelled bath with electric shower over, low level WC, pedestal hand basin, tiled wall finish, chrome heated towel rail, extractor fan.
1.88m x 1.85m (6'2 x 6'1)
- **Rear Garden** - Mainly laid to lawn with paved patio seating area, panel enclosed fencing, side gated access, outside lighting.
- **Garage** - With up and over door.
- **Tenure** - Freehold.
- **Services** - All mains services connected.
- **Council Tax** - Ashford Borough Council Tax Band: D

- - You may download, store and use the material for your own personal use and research. You may not republish, retransmit, redistribute or otherwise make the material available to any party or make the same available on any website, online service or bulletin board of your own or of any other party or make the same available in hard copy or in any other media without the website owner's express prior written consent. The website owner's copyright must remain on all reproductions of material taken from this website.



Gould Harrison 1 Middle Row, High Street, Ashford, TN24 8SQ **01233 646411**

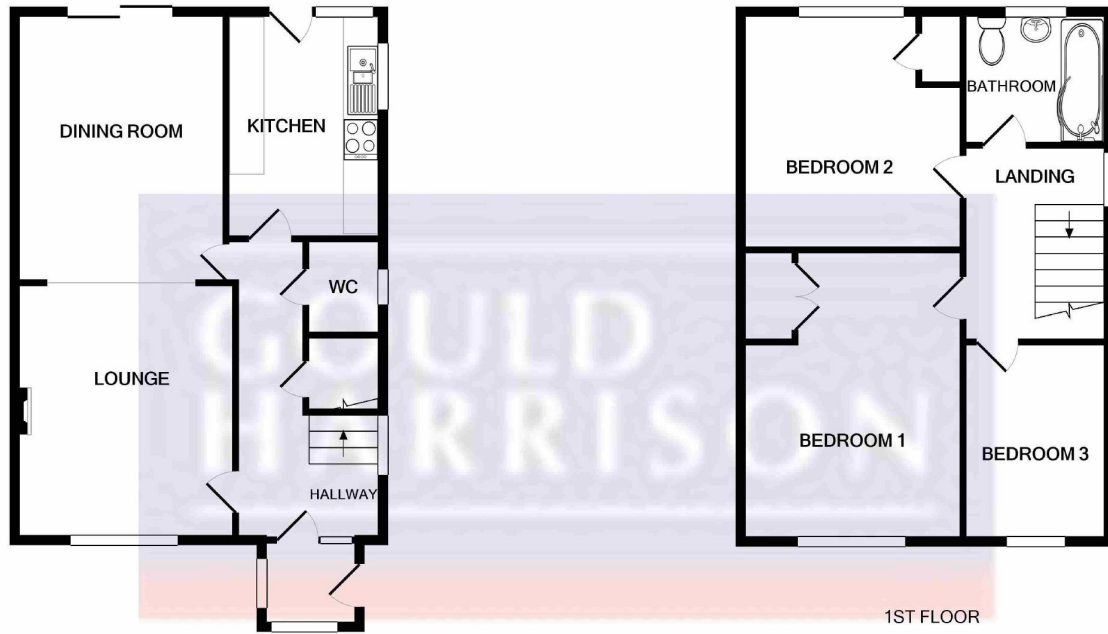

GROUND FLOOR

1ST FLOOR

Whilst every attempt has been made to ensure the accuracy of the floor plan contained here, measurements of doors, windows, rooms and any other items are approximate and no responsibility is taken for any error, omission, or mis-statement. This plan is for illustrative purposes only and should be used as such by any prospective purchaser. The services, systems and appliances shown have not been tested and no guarantee as to their operability or efficiency can be given
 Made with Metropix ©2019



Gould Harrison 1 Middle Row, High Street, Ashford, TN24 8SQ 01233 646411



**GOULD
HARRISON**

Everything you want
to know about
local property prices



How does **Luckhurst Road** compare to the **county** and **national average**?

Whether you are selling, buying, letting or renting it is always useful to know the prices that local properties have recently sold for. The table below contains local, average and national sold prices for the period 1/7/2016 to 31/1/2017 for all types of property allowing you to get a sense of the current market conditions.

Post code / National	Detached	Semi-detached	Terraced	Flats/Maisonettes
TN24	£378474	£268736	£208720	£120597
National	£388720	£242324	£232459	£275086

Data produced by Land Registry © Crown copyright 2014.

This data covers the transactions received at Land Registry in the period 1/1/2010 to 31/1/2017. © Crown copyright 2014.



Gould Harrison 1 Middle Row, High Street, Ashford, TN24 8SQ **01233 646411**



Everything you want
to know about
local authorities



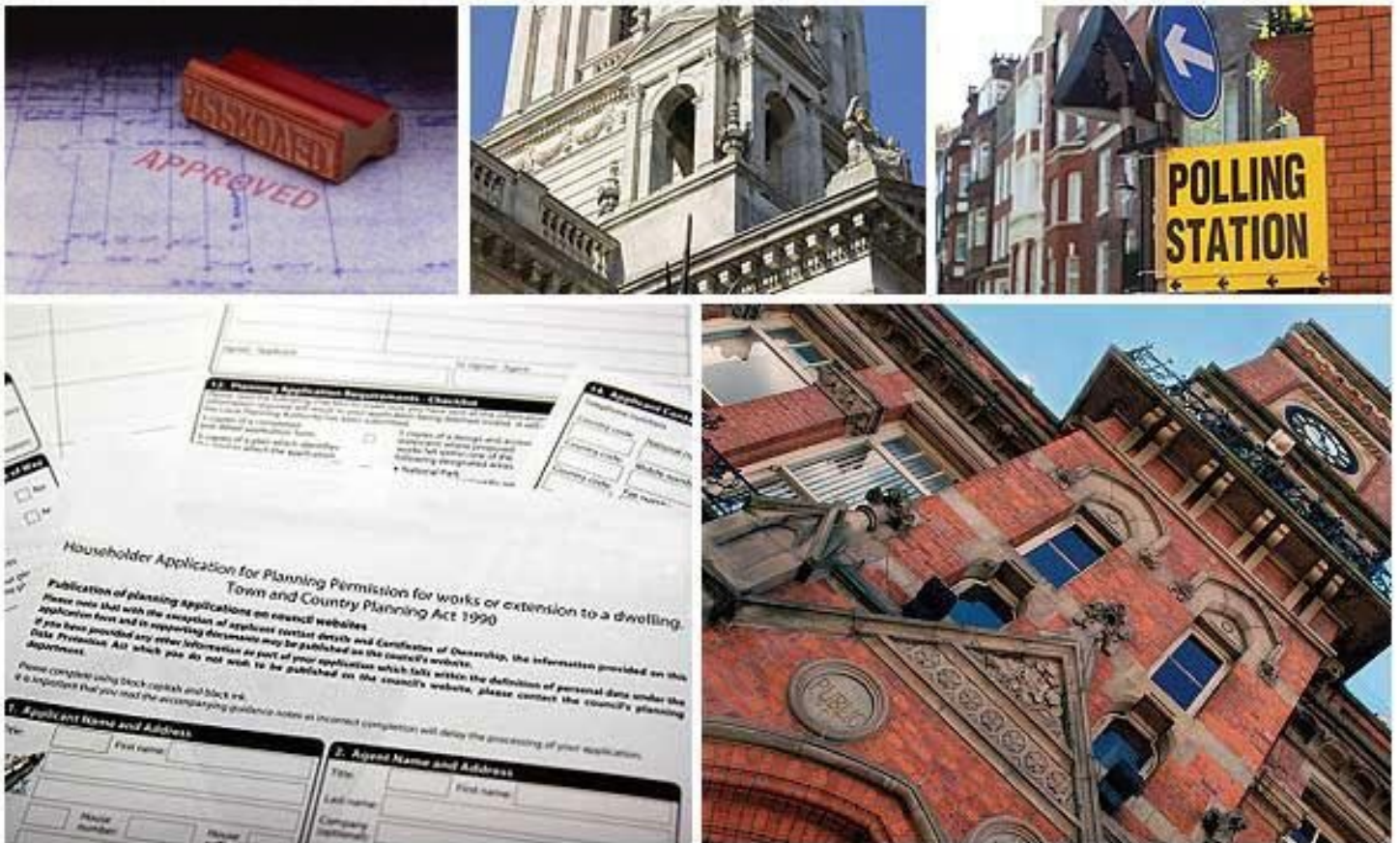

Get to know your local authorities

Local government directly affects quality of life, particularly when it comes to council tax, planning, waste disposal and the impact of local policies. You may want to investigate how this is likely to affect you if you decide to move. There are nearly 400 local authorities in England, with five different types of local government structure. These can be broadly divided into **single-tier** and **two-tier authorities**. Single-tier authorities are **Metropolitan Authorities**, **London Boroughs** and **Unitary** or **Shire Authorities**. Two-tier authorities have both a **County Council**, and a **District Council** or **City Council**. There are also around 10,000 parish and town councils, effectively creating an additional tier in some areas - mostly, but not exclusively, in rural areas. The National Association of Local Councils (NALC) represents and works on behalf of these community councils and is a useful contact point.

The local authority locations and contact details for **Luckhurst Road** are:

Shire / County / District	Website	Address	Contact details
Ashford Borough Council (Shire District)	http://www.ashford.gov.uk	Tannery Lane, Ashford, Kent, TN23 1PL	t: 01233 637311 f: 01233 645654 e: enquiries@ashford.gov.uk
Kent County Council (Shire County)	http://www.kent.gov.uk	Maidstone, Kent, ME14 1XQ	t: 0845 8247247 f: 01622 759905 e: county.hall@kent.gov.uk

Disclaimer: The information displayed above has been obtained using the property's postcode in proximity to its local authority. It is recommended that this information is independently verified.



Everything you want
to know about
transport links





Become familiar with public transport links

Being able to choose to travel by public transport is important for many reasons. It helps to reduce congestion, provides access to work and education, and facilitates use of health and leisure facilities. If you or your family members travel abroad, access to the nearest ferry terminals is also likely to be a significant factor in choosing a new property.

Using the maps below, you can pinpoint the precise locations of transport links for **Luckhurst Road**. Tables for each type of transport indicate the property's distance from the nearest bus stops, railway stations, coach stops and ferry terminals (providing that these facilities are within the scale proximity of the maps.)

Transport Links

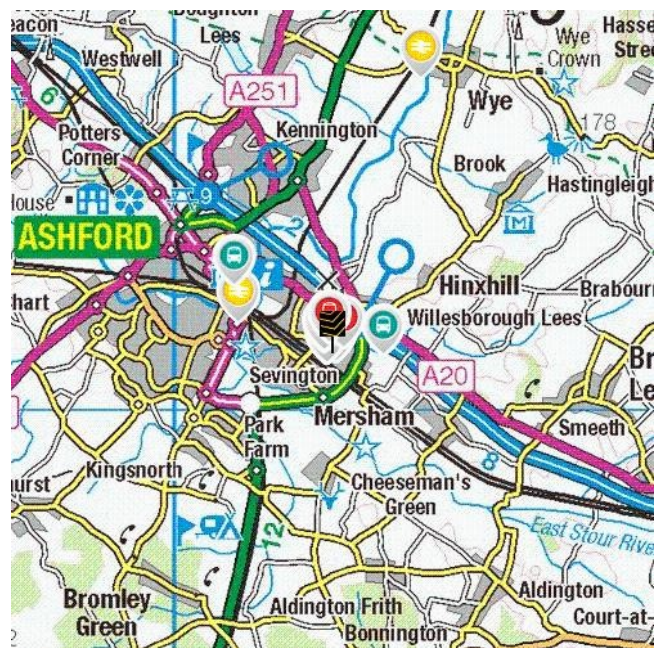

	Airports	Approx Distance
	Lydd London Ashford Airport	12.66 miles
	London Southend Airport	31.0 miles
	Biggin Hill Airport	39.91 miles
	London City Airport	44.68 miles
	London Gatwick Airport	46.14 miles
	Ferry ports	Approx Distance
	Folkestone Eurotunnel Terminal	9.78 miles
	Dover Western Docks Ferry Terminal	17.96 miles
	Dover Eastern Docks Ferry Terminal	18.44 miles
	Ramsgate Ferry Terminal	25.75 miles
	Gravesend Pier	31.4 miles
	Tilbury Ferry Terminal	31.7 miles
	Burnham on Crouch Ferry Landing	33.85 miles
	Wallasea Island Ferry Landing	33.89 miles

Disclaimer: The information represented in this section has been sourced from the Department of Transport's Open Data and is based on the property's postcode. It is recommended that this information is independently verified.



Gould Harrison 1 Middle Row, High Street, Ashford, TN24 8SQ **01233 646411**

	Train Stations	Approx Distance
	Ashford International Rail Station	1.21 miles
	Wye Rail Station	3.53 miles
	Ham Street Rail Station	5.15 miles
	Westenhanger Rail Station	6.57 miles
	Pluckley Rail Station	6.83 miles
	Charing (Kent) Rail Station	6.9 miles
	Sandling Rail Station	7.8 miles
	Appledore (Kent) Rail Station	8.06 miles
	Bus Stops	Approx Distance
	Julien Place	0.06 miles
	Knott Crescent	0.06 miles
	Boys Hall Road	0.09 miles
	Boys Hall Road	0.1 miles
	Park Place	0.13 miles
	Park Place	0.13 miles
	Hayward Close	0.17 miles
	Church Road Post Office	0.18 miles
	Coach Stops	Approx Distance
	Willesborough (Ashford Kt): Hythe Rd. Coach Stop	0.61 miles
	Ashford (Kent): Town Centre Coach Stops	1.46 miles
	Sellindge (Kent): Ashford Rd Coach Stop	5.16 miles
	Newingreen (Kent): Ashford Rd Coach Stop	6.77 miles
	Hythe (Kent) Coach Stop	8.94 miles
	Seabrook (Kent): Seabrook Rd Coach Stop	10.44 miles
	Sandgate: High Street Coach Stop	11.38 miles
	Canterbury: Park & Ride New Dover Rd Coach Stop	12.22 miles

Disclaimer: The information represented in this section has been sourced from the Department of Transport's Open Data and is based on the property's postcode. It is recommended that this information is independently verified.

**GOULD
HARRISON**



**GOULD
HARRISON**

Everything you want
to know about
local schools



How are local schools performing?

If schools are important to you, then this section sets out the published Key Performance Indicators for schools near to your prospective new home. Key Performance Indicators look primarily at how well pupils perform in their tests and examinations, as well as some other measures like attendance.

If you want to know more about a particular school or college, you can also visit the Ofsted website <http://www.ofsted.gov.uk/inspection-reports/find-inspection-report>

Local Schools

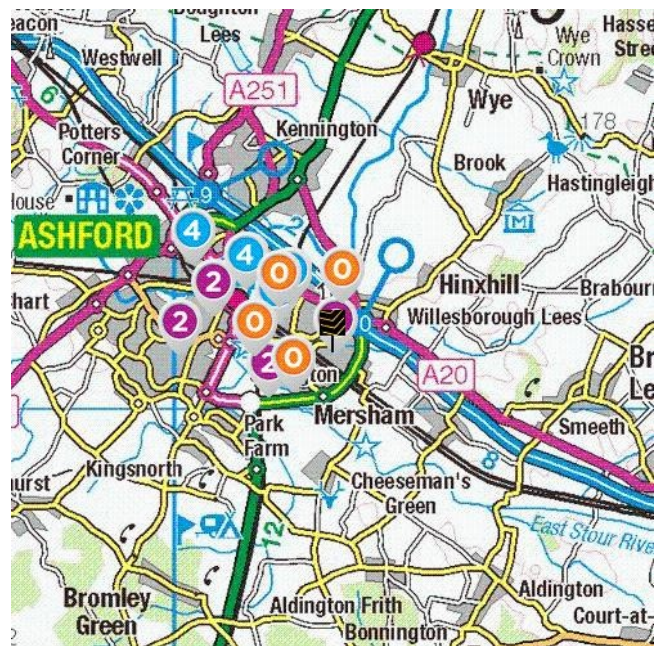

The next page shows tables and charts divided into Key Stages and a list of respective schools local to **Luckhurst Road**. There are four main age-related Key Stages defined as:



Special schools are marked with this icon

Key Stage	Definition
Key Stage 0	Marker / indicator - no legal definition
Key Stage 1	Fits broadly with the first stage of education, i.e. ages 5-7.
Key Stage 2	Fits the later stage of primary education, often known as junior schools, i.e. ages 8-11. This takes pupils up to the standardised break at age 11 after which pupils generally change schools and transfer to secondary education.
Key Stage 3	Secondary education split between key stages 3 and 4, with key stage 3 covering ages 11-13.
Key Stage 4	Key Stage 4 (ages 14-16) covers the two year period of study for GCSE level examinations.
Key Stage 5	Beyond key stage 4 is 16+ or Sixth Form provision, sometimes unofficially referred to as Key Stage 5.

	Key Stage 0 - Name and Address	Approx Distance
	<p>Name: Canterbury House Nursery Address: 59-61 Canterbury Road, ASHFORD, Kent, TN24 0BH</p>	0.62 miles
	<p>Name: Ashford Play Nursery Address: The Old Chapel, ASHFORD, Kent, TN24 0NS</p>	0.69 miles
	<p>Name: Rainbow Childrens Nursery Address: 207 Hythe Road, ASHFORD, Kent, TN24 8PL</p>	0.9 miles
	<p>Name: Cherrytree Nursery School Ltd Address: Wainwright Place, ASHFORD, Kent, TN24 0PF</p>	0.94 miles

Disclaimer: The information represented in this section has been sourced from Experian and is based on the property's postcode.



Gould Harrison 1 Middle Row, High Street, Ashford, TN24 8SQ **01233 646411**

	Key Stage 2 - Information	Approx Distance
	<p>Name: Willesborough Junior School Address: Highfield Road, Ashford, TN24 0JU Contact Number: 0123 3620405 Age Range: 7-11 yrs Local Education Authority: Kent Religious Character: None</p>	0.08 miles
	<p>Name: East Stour Primary School Address: Earlsworth Road, Ashford, TN24 0DW Contact Number: 0123 3630820 Age Range: 3-11 yrs Local Education Authority: Kent Religious Character: Does not apply</p>	0.9 miles
	<p>Name: Victoria Road Primary School Address: Victoria Road, Ashford, TN23 7HQ Contact Number: 0123 3620044 Age Range: 5-11 yrs Local Education Authority: Kent Religious Character: Does not apply</p>	1.52 miles
	<p>Name: St Simon of England Roman Catholic Primary School - Ashford Address: Noakes Meadow, Ashford, TN23 4RB Contact Number: 0123 3623199 Age Range: 5-11 yrs Local Education Authority: Kent Religious Character: Roman Catholic</p>	1.83 miles

Disclaimer: The information represented in this section has been sourced from the Department of Education's 2017 results data set and is based on the property's postcode.



Gould Harrison 1 Middle Row, High Street, Ashford, TN24 8SQ **01233 646411**

Reading, Writing and Maths

	Name	Expected	Higher
2	Willesborough Junior School	51.0 %	2.0 %
	East Stour Primary School	48.0 %	0.0 %
	Victoria Road Primary School	76.0 %	3.0 %
	St Simon of England Roman Catholic Primary School - Ashford	72.0 %	0.0 %
	Kent	59.0 %	6.0 %
	National	53.0 %	5.0 %

Primary Progress Measures

As well as actual pupil performance in tests and exams an important Key Performance Indicator is that of progress measures that compare the actual achievements of other pupils nationally with similar prior attainment. Any increase in attainment achieved by each pupil will be reflected in the schools progress scores. They are fairer to schools in challenging circumstances, as they recognise a school that is doing a good job with an intake with poor prior attainment.

Progress Measures for 2017

	Name	Progress Measures 2017		
2	Willesborough Junior School	Maths PM -1.6 Lower -2.6 Upper -0.6	Reading PM -1.5 Lower -0.4 Upper N/A	Writing PM 0.3 Lower -0.8 Upper 1.4
	East Stour Primary School	Maths PM 2.7 Lower 1.0 Upper 4.4	Reading PM 1.4 Lower 3.3 Upper N/A	Writing PM 1.3 Lower -0.5 Upper 3.1
	Victoria Road Primary School	Maths PM -1.5 Lower -3.5 Upper 0.5	Reading PM -2.0 Lower 0.3 Upper N/A	Writing PM 1.4 Lower -0.8 Upper 3.6
	St Simon of England Roman Catholic Primary School - Ashford	Maths PM 0.9 Lower -1.1 Upper 2.9	Reading PM 0.0 Lower 2.3 Upper N/A	Writing PM -0.4 Lower -2.6 Upper 1.8

Disclaimer: The information represented in this section has been sourced from the Department of Education's 2017 results data set and is based on the property's postcode.



	Key Stage 4 - Information	Approx Distance
	<p>Name: The North School Address: Essella Road, Ashford, TN24 8AL Contact Number: 0123 3614600 Age Range: 11-19 yrs Local Education Authority: Kent Religious Character: Does not apply</p>	0.81 miles
	<p>Name: The Norton Knatchbull School Address: Hythe Road, Ashford, TN24 0QJ Contact Number: 0123 3620045 Age Range: 11-18 yrs Local Education Authority: Kent Religious Character: None Admission Policy: Selective</p>	0.84 miles
	<p>Name: Ashford School Address: East Hill, Ashford, TN24 8PB Contact Number: 0123 3625171 Age Range: 0-18 yrs Local Education Authority: Kent Religious Character: Christian Admission Policy: Not applicable</p>	1.35 miles
	<p>Name: Highworth Grammar School Address: Quantock Drive, Ashford, TN24 8UD Contact Number: 0123 3624910 Age Range: 11-18 yrs Local Education Authority: Kent Religious Character: Does not apply Admission Policy: Selective</p>	2.03 miles

Disclaimer: The information represented in this section has been sourced from the Department of Education's 2017 results data set and is based on the property's postcode.



Percentage of pupils achieving 5+ A*-C/9-4 or equivalents including 9-4 in both English and mathematics GCSEs

	Name	2017	2016	2015	2014
	The North School	45.0 %	44.0 %	24.0 %	36.0 %
	The Norton Knatchbull School	96.0 %	97.0 %	95.0 %	93.0 %
	Ashford School	0.0 %	0.0 %	0.0 %	0.0 %
	Highworth Grammar School	98.0 %	98.0 %	98.0 %	97.0 %
	Kent	59.9 %	59.0 %	57.4 %	58.1 %
	National	56.6 %	53.5 %	53.8 %	53.4 %

Disclaimer: The information represented in this section has been sourced from the Department of Education's 2017 results data set and is based on the property's postcode.

Average number of GCSE entries per pupil

	Name	Number
	The North School	9.3
	The Norton Knatchbull School	9.7
	Ashford School	6.0
	Highworth Grammar School	9.8
	Kent	8.5
	National	8.2

Disclaimer: The information represented in this section has been sourced from the Department of Education's 2017 results data set and is based on the property's postcode.



Gould Harrison 1 Middle Row, High Street, Ashford, TN24 8SQ **01233 646411**

	Key Stage 5 - Information	Approx Distance
	Name: The North School Address: Essella Road, Ashford, TN24 8AL Contact Number: 0123 3614600 Age Range: 11-19 yrs Local Education Authority: Kent Religious Character: Does not apply	0.81 miles
	Name: The North School Address: Essella Road, Ashford, TN24 8AL Contact Number: 0123 3614600 Age Range: 11-19 yrs Local Education Authority: Kent Religious Character: Does not apply	0.81 miles
	Name: The Norton Knatchbull School Address: Hythe Road, Ashford, TN24 0QJ Contact Number: 0123 3620045 Age Range: 11-18 yrs Local Education Authority: Kent Religious Character: None Admission Policy: Selective	0.84 miles
	Name: Ashford School Address: East Hill, Ashford, TN24 8PB Contact Number: 0123 3625171 Age Range: 0-18 yrs Local Education Authority: Kent Religious Character: Christian Admission Policy: Not applicable	1.35 miles

Disclaimer: The information represented in this section has been sourced from the Department of Education's 2017 results data set and is based on the property's postcode.



Percentage of A level students achieving at least three levels at grades AAB or better, at least two of which are in facilitating subjects

	Name	%
	The North School	0.0 %
	The North School	N/A
	The Norton Knatchbull School	9.9 %
	Ashford School	44.3 %
	Kent	15.3 %
	National	17.0 %

Disclaimer: The information represented in this section has been sourced from the Department of Education's 2017 results data set and is based on the property's postcode.

As well as actual pupil performance in tests and exams, an important Key Performance Indicator is that of Value Added. When pupils start a school, they all have varying levels of ability and social advantage. A school's Value Added score measures how much progress they have made from the beginning to the end of their compulsory secondary education (i.e. between the end of Key Stage 2 and the end of Key Stage 4). It is a quick measurement of the effect of a school on its pupils.

	Name	Value Added
	The North School	0.4
	The North School	N/A
	The Norton Knatchbull School	0.0
	Ashford School	0.4



Gould Harrison 1 Middle Row, High Street, Ashford, TN24 8SQ 01233 646411



Everything you want
to know about
local health services



How local are the health services?

We all want good access to local health facilities, wherever we live. To see how well **Luckhurst Road** is served, we have set out below the exact locations of hospitals, Accident & Emergency centres, GPs, pharmacies, dentists, out-of-hours medical care and walk-in clinics. Where it's available, you will find more detailed information, including the names of practitioners and their contact details.

Hospitals		Approx Distance
	William Harvey Hospital (ashford), Kennington Road, Ashford, Kent, TN24 0LZ	0.7 miles
A&E		Approx Distance
	William Harvey Hospital (ashford), Kennington Road, Ashford, Kent, TN24 0LZ	0.7 miles
Walk-in Clinics		Approx Distance
	Willesborough Health Centre, The Willesborough Health Cntr, Ashford Kent, TN24 0HZ	0.13 miles

Disclaimer: The information represented in this section has been sourced from the Department of Health's Open Data and is based on the property's postcode.

	GPs	Approx Distance
	WILLESBOROUGH HEALTH CTR., WILLESBOROUGH HEALTH CTR., KENT, TN24 0HZ	0.13 miles
	SYDENHAM HOUSE, SYDENHAM HOUSE MED CENTRE, KENT, TN24 8DN	1.14 miles
	NORTH STREET SURGERY, NORTH STREET SURGERY, KENT, TN24 8JR	1.54 miles
	MUSGROVE PARK MEDICAL CENTRE, MUSGROVE PARK MEDICAL CTR, KENT, TN23 7SP	1.56 miles

Disclaimer: The information represented in this section has been sourced from the Department of Health's Open Data and is based on the property's postcode.

	Dental Surgeons	Approx Distance
	Mp Jones, Romney House, ASHFORD, Kent, TN24 0RW	0.67 miles
	Sunnyside Dental Practice, Elwick Road, ASHFORD, Kent, TN23 1NN	1.4 miles
	Leafield Dental Surgery, Church Road, ASHFORD, Kent, TN23 1RD	1.42 miles
	Oradent, 169 Beaver Road, ASHFORD, Kent, TN23 7SG	1.42 miles
	Ashford Dental Access Centre, Vicarage Lane Clinic, ASHFORD, Kent, TN23 1NJ	1.44 miles

Disclaimer: The information represented in this section has been sourced from Experian and is based on the property's postcode.



Gould Harrison 1 Middle Row, High Street, Ashford, TN24 8SQ **01233 646411**





Everything you want
to know about
local amenities





What about local amenities?

There are a number of local amenities on offer in the area around **Luckhurst Road**. The tables below give the addresses of local shops, restaurants, pubs, gyms and even golf clubs.

	Local Grocers and Convenience Stores	Approx Distance
	M & S Latestop, 90 Hunter Avenue, ASHFORD, Kent, TN24 0HG	0.54 miles
	Costcutter, East Stour Filling Station, ASHFORD, Kent, TN24 8AH	0.92 miles
	One Stop Community Stores Ltd, 3 George Williams Way, ASHFORD, Kent, TN24 9RZ	1.6 miles
	One Stop Community Stores Ltd, 39-41 Court Wurtin Beaver Lane, ASHFORD, Kent, TN23 5NH	1.74 miles
	Costcutter, 101-103 Beaver Lane, ASHFORD, Kent, TN23 5NU	1.87 miles
	Supermarkets	Approx Distance
	The Co-operative Food, 83 Hunter Avenue, ASHFORD, Kent, TN24 0HG	0.54 miles
	Tesco Extra, Hythe Road, ASHFORD, Kent, TN24 0YE	0.57 miles
	Tesco Stores, Mace Lane, ASHFORD, Kent, TN24 8DN	1.15 miles
	Tesco Superstore, Moatfield Meadow, ASHFORD, Kent, TN23 3LU	1.85 miles
	The Co-operative Food, 98 Faversham Road, ASHFORD, Kent, TN24 9DE	2.08 miles

Disclaimer: The information represented in this section has been sourced from Experian and is based on the property/s postcode.

	Nightclubs	Approx Distance
	Club Chemistry, 15 Station Road East, CANTERBURY, Kent, CT1 2RB	12.12 miles
	Steinbeck and Shaw, St George's Place, CANTERBURY, Kent, CT1 2JT	12.49 miles
	Club Horizon, 48 Ferry Road, RYE, East Sussex, TN31 7DN	14.86 miles
	Coffee Romba, Gabriels Hill, MAIDSTONE, Kent, ME15 6JJ	18.85 miles
	Beluga, 73 Bank Street, MAIDSTONE, Kent, ME14 1SN	18.96 miles
	Pubs / Bars / Inns	Approx Distance
	Hooden On The Hill, Silver Hill Road, ASHFORD, Kent, TN24 0NY	0.49 miles
	The Blacksmith's Arms, 84 The Street, ASHFORD, Kent, TN24 0NA	0.51 miles
	The Albion, 2 Albion Place, ASHFORD, Kent, TN24 0BU	0.53 miles
	The Windmill Inn, 278 Hythe Road, ASHFORD, Kent, TN24 0QR	0.64 miles
	The French Connection, Hall Avenue, ASHFORD, Kent, TN24 0GA	0.64 miles
	Wine Bars	Approx Distance
	Lime's Lounge, 13 Rosemary Lane, CANTERBURY, Kent, CT1 2PN	12.23 miles
	Alberry's Wine Bar, 38 St Margarets Street, CANTERBURY, Kent, CT1 2TY	12.37 miles
	Bramley's, 15 Orange Street, CANTERBURY, Kent, CT1 2JA	12.56 miles
	Ampersand Design Cafe, 46 Tontine Street, FOLKESTONE, Kent, CT20 1JU	12.83 miles
	Deco 5, 15-17 Oxford Street, WHITSTABLE, Kent, CT5 1DB	16.04 miles
	Restaurants	Approx Distance
	Table Table, French Connection Hall Avenue, ASHFORD, Kent, TN24 0GN	0.65 miles
	McDonald's Restaurants Ltd, The Parade, ASHFORD, Kent, TN24 0HT	0.74 miles
	Wagamama, Ashford Designer Outlet, ASHFORD, Kent, TN24 0SD	1.01 miles
	McDonald's Restaurants, Kimberley Way, ASHFORD, Kent, TN24 0SD	1.01 miles
	Pizza Express, Unit 85-86, ASHFORD, Kent, TN24 0SD	1.01 miles
	Golf Club / Courses / Professionals	Approx Distance
	Ashford Golf Club, Sandyhurst Lane, Ashford, Kent, TN25 4NT	3.12 miles
	Great Chart Golf & Leisure, Bridge Farm, ASHFORD, Kent, TN23 3BW	4.32 miles
	Etchingill Golf, Canterbury Road, FOLKESTONE, Kent, CT18 8FA	8.35 miles
	Tenterden Golf Club, Woodchurch Road, TENTERDEN, Kent, TN30 7DR	9.44 miles
	Sene Valley Golf Club, Blackhouse Hill, FOLKESTONE, Kent, CT18 8BL	9.56 miles

Disclaimer: The information represented in this section has been sourced from Experian and is based on the property's postcode.

**GOULD
HARRISON**

	Places of Worship	Approx Distance
	St Mary The Virgin C Of E Church, 66 Church Road, ASHFORD, Kent, TN24 0JG	0.19 miles
	Willesborough Baptist Church, Hythe Road, ASHFORD, Kent, TN24 0QR	0.64 miles
	Ashford Baptist Church, Station Road, ASHFORD, Kent, TN23 1PS	1.41 miles
	Christ Church C Of E Church, Beaver Road, ASHFORD, Kent, TN23 7SR	1.41 miles
	St Mary The Virgin Ashford, The College, ASHFORD, Kent, TN23 1QG	1.5 miles
	Banks / Financial Institutions	Approx Distance
	Natw est, 20 High Street, ASHFORD, Kent, TN24 8SH	1.46 miles
	Hsbc Bank Plc, 39 High Street, ASHFORD, Kent, TN24 8TG	1.48 miles
	The Co-operative Bank, 21 Bank Street, ASHFORD, Kent, TN23 1DG	1.54 miles
	Santander, 60-62 High Street, ASHFORD, Kent, TN24 8SZ	1.54 miles
	Tsb, 17 Bank Street, ASHFORD, Kent, TN23 1DF	1.55 miles
	DIY Stores	Approx Distance
	Wickes Building Supplies Ltd, Foster Road, ASHFORD, Kent, TN24 0SH	0.3 miles
	Homebase Ltd, Unit 2, ASHFORD, Kent, TN24 0SG	0.47 miles
	The Flat Pack Man, 28 Low er Denmark Road, ASHFORD, Kent, TN23 7SY	1.31 miles
	B & Q Plc, Norman Road, ASHFORD, Kent, TN23 7DG	1.39 miles
	Hinges & Brackets, 107 Beaver Road, ASHFORD, Kent, TN23 7SG	1.42 miles
	Hotels	Approx Distance
	Holiday Inn, Canterbury Road, ASHFORD, Kent, TN24 8QQ	1.7 miles
	The Conningbrook Hotel - Shepherd Neame Pubs, Canterbury Road, ASHFORD, Kent, TN24 9QR	2.05 miles
	Travelodge, Eureka Leisure Park, ASHFORD, Kent, TN25 4BN	2.15 miles
	Ashford International Hotel, Simone Weil Avenue, ASHFORD, Kent, TN24 8UX	2.15 miles
	Premier Inn, Maidstone Road, ASHFORD, Kent, TN26 1AP	4.93 miles
	Theatres / Concert Halls	Approx Distance
	Fhods, The Tow er Theatre, FOLKESTONE, Kent, CT20 3HL	10.84 miles
	Arden Theatre, Leslie Smith Drive, FAVERSHAM, Kent, ME13 8PW	12.32 miles
	The Marlow e Theatre, The Friars, Canterbury, Kent, CT1 2AS	12.56 miles
	Playhouse Theatre, 104 High Street, WHITSTABLE, Kent, CT5 1AZ	16.16 miles
	Haslet Theatre, Earl Street, MAIDSTONE, Kent, ME14 1PL	18.99 miles

Disclaimer: The information represented in this section has been sourced from Experian and is based on the property/s postcode.

**GOULD
HARRISON**

	Cinemas	Approx Distance
	Cine world, Eureka Leisure Park, ASHFORD, Kent, TN25 4BN	2.15 miles
	The Royal Cinema, 9 Market Place, FAVERSHAM, Kent, ME13 7AG	12.38 miles
	Odeon Cinemas Ltd, 45 St Georges Place, CANTERBURY, Kent, CT1 1UP	12.46 miles
	The Silver Screen Cinema, The Tow n Hall, FOLKESTONE, Kent, CT20 1DY	12.72 miles
	Gulbenkian Cinema, Gulbenkian Theatre, CANTERBURY, Kent, CT2 7NB	13.29 miles
	Leisure Centres	Approx Distance
	The Stour Centre, Station Approach, ASHFORD, Kent, TN23 1ET	1.18 miles
	Ashford International Sports & Social Club Ltd, 181 Beaver Road, ASHFORD, Kent, TN23 7SG	1.42 miles
	Kingsnorth Recreation Centre, Field View, ASHFORD, Kent, TN23 3NZ	2.0 miles
	Tenterden Leisure Centre Trust, Recreation Ground Road, TENTERDEN, Kent, TN30 6RA	10.36 miles
	Folkestone Sports Centre Trust Ltd, Radnor Park Avenue, FOLKESTONE, Kent, CT19 5HX	12.05 miles
	Newsagents	Approx Distance
	South Willesborough New sagents, 63 Gladstone Road, ASHFORD, Kent, TN24 0BZ	0.55 miles
	Raj's New sagents Ltd, 79 Hythe Road, ASHFORD, Kent, TN24 8PH	1.11 miles
	Lucky Star, 27A Bank Street, ASHFORD, Kent, TN23 1DG	1.54 miles
	Dog World, Williamson House, ASHFORD, Kent, TN23 6LW	1.55 miles
	County Square, 28A County Square, ASHFORD, Kent, TN23 1AE	1.59 miles
	Post Offices	Approx Distance
	Willesborough Post Office, 65 Church Road, ASHFORD, Kent, TN24 0JZ	0.16 miles
	North Willesboroughs Post Office, 104 Albemarle Road, ASHFORD, Kent, TN24 0HN	0.46 miles
	New tow n Stores & Post Office, 20 New tow n Green, ASHFORD, Kent, TN24 0PE	0.84 miles
	Post Office Ltd, Tufton Street, ASHFORD, Kent, TN23 1AA	1.58 miles
	Mersham Stores & Post Office, 8 The Street, ASHFORD, Kent, TN25 6NA	1.7 miles

Disclaimer: The information represented in this section has been sourced from Experian and is based on the property/s postcode.

**GOULD
HARRISON**

Gould Harrison 1 Middle Row, High Street, Ashford, TN24 8SQ **01233 646411**



**GOULD
HARRISON**

Everything you want
to know about
local policing



Understanding who polices your neighbourhood

When you move to a new area, you want to know the arrangements for local community policing. See below for essential information about police services near to **Luckhurst Road**. We have included location and contact details for the police station and wherever possible, details of police officers assigned to the area.

Your policing neighbourhood

The name of your policing neighbourhood is **Ashford - Highfield** and it has a population of **2537**.

Highfield ward is an urban area with more than 1,000 households.

Your Local Policing Team

Name	Rank	Tel No.	E-mail
Jasmine Bloomfield	Sergeant	101	
Gavin Hart	Sergeant	101	
Kim Cameron	Sergeant	101	
Lee Sinden	PCSO	101	

Disclaimer: The information represented in this section has been sourced from data.police.uk.

Locations of Interest

Ashford Police Station
 station
 Tufton Street, Ashford

9am - 5pm Monday to Saturday (excluding bank holidays)

Disclaimer: The information represented in this section has been sourced from data.police.uk.



Gould Harrison 1 Middle Row, High Street, Ashford, TN24 8SQ **01233 646411**

The logo for Gould Harrison, featuring the company name in white, uppercase letters on a dark blue rectangular background with a red horizontal bar at the bottom.

GOULD
HARRISON

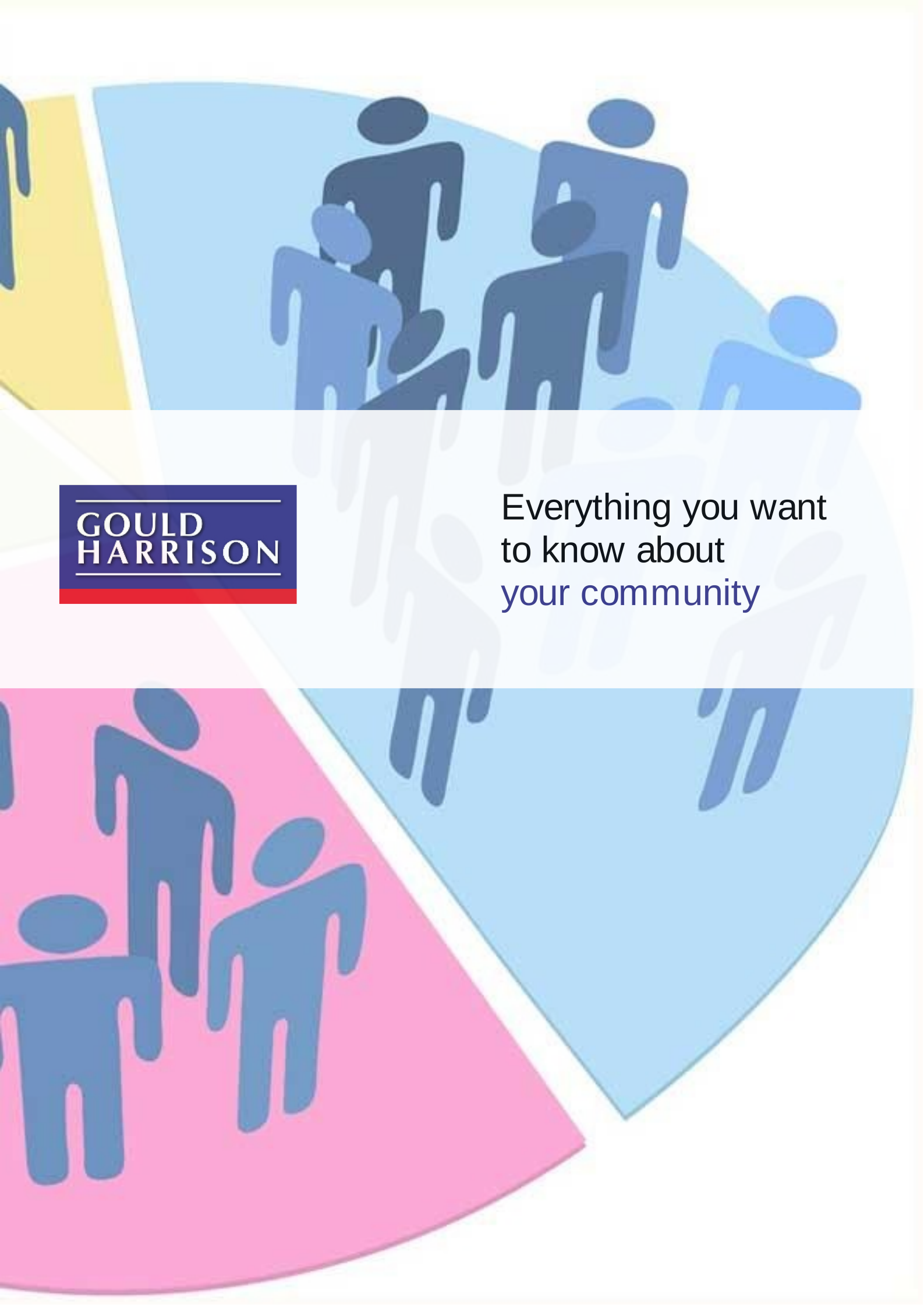
A graphic background consisting of several overlapping, semi-circular segments in shades of blue, pink, and yellow. Each segment contains stylized human figures in various colors (dark blue, light blue, pink) representing a diverse community.

Everything you want
to know about
your community



Understanding the demographics of the local community

Census statistics can be used to build up a detailed snapshot of the population and its composition. We can see how the population is differentiated by age, employment status, education, and so on at a particular point in time. In this section we have extracted information specific to the local area for **Luckhurst Road** and compared it with information for all citizens of the UK so that you can better understand the character of your prospective local community.

The below tables allow you to make a comparison between your prospective local vicinity (Output Area) and National results. An Output Area is the lowest geographical level that census statistics are provided. They are formed from adjacent postcodes with the minimum size being 40 residential households up to a recommended size of 125 households. Urban/rural mixes are avoided where possible.

Age Profile

The below table provides an age breakdown of the local population which will help give you an understanding of how your prospective new area's age distribution compares against the national average.

	Output Area	National
0-4	5.18% (20)	5.96% (2926238)
5-14	13.73% (53)	12.93% (6351576)
15-24	12.44% (48)	12.18% (5985323)
25-34	11.66% (45)	14.36% (7054271)
35-44	15.8% (61)	14.94% (7341900)
45-54	17.1% (66)	13.22% (6494262)
55-64	6.99% (27)	10.54% (5177261)
65-74	4.66% (18)	8.35% (4102841)
75-84	3.89% (15)	5.6% (2751135)
>85	8.55% (33)	1.94% (954024)

Education Profile

The below table provides an education breakdown of the local population which will help give you an understanding of how your prospective new area's educational profile compares against the county and national average. The levels used are designed as:

- **Level 1** - 1-4 O Levels/CSE/GCSEs (any grades), Entry Level, Foundation Diploma, NVQ level 1, Foundation GNVQ, Basic/Essential Skills
- **Level 2** - 5+ O Level (Passes)/CSEs (Grade 1)/GCSEs (Grades A*-C), School Certificate, 1 A Level/2-3 AS Levels/VCEs, Intermediate/Higher Diploma, Intermediate Diploma, NVQ level 2, Intermediate GNVQ, City and Guilds Craft, BTEC First/General Diploma, RSA Diploma Apprenticeship
- **Level 3** - 2+ A Levels/VCEs, 4+ AS Levels, Higher School Certificate, Progression/Advanced Diploma, NVQ Level 3; Advanced GNVQ, City and Guilds Advanced Craft, ONC, OND, BTEC National, RSA Advanced Diploma
- **Level 4+** - Degree (for example BA, BSc), Higher Degree (for example MA, PhD, PGCE), NVQ Level 4-5, HNC, HND, RSA Higher Diploma, BTEC Higher level, Foundation degree, Professional qualifications (for example teaching, nursing, accountancy)

	Output Area	National
None	19.85% (52)	28.85% (10251674)
Level 1	22.52% (59)	16.63% (5909093)
Level 2	26.34% (69)	19.36% (6877530)
Level 3	8.78% (23)	8.34% (2962282)
Level 4 or 5	15.65% (41)	19.9% (7072052)
Unknown	6.87% (18)	6.92% (2459460)

Disclaimer: The information represented in this section has been sourced from The Office for National Statistics.

Employment Profile

The below table provides an employment breakdown of the local population which will help give you an understanding of how your prospective new area's employment compares against the county and national average.

	Output Area	National
Employee part time	15.27% (40)	11.81% (4196041)
Employee full time	49.62% (130)	40.81% (14499241)
Self employed part time	1.15% (3)	1.95% (694033)
Self employed full time	6.11% (16)	6.36% (2260955)
Unemployed	3.05% (8)	3.35% (1188855)
Full time students	4.58% (12)	2.58% (917582)
Student	2.67% (7)	4.67% (1660564)
Retired	7.25% (19)	13.54% (4811595)
Looking after home family	4.96% (13)	6.52% (2316229)
Permanently sick/disabled	5.34% (14)	5.3% (1884901)
Other	0.0% (0)	3.1% (1102095)

Disclaimer: The information represented in this section has been sourced from The Office for National Statistics.

**GOULD
HARRISON**

