



- End Of Terrace
- Parking

### Entrance Porch

Wooden front door. Window to side aspect. Door to lounge.

### Lounge 15'7 x 11'6 (4.75m x 3.51m)

Upvc double glazed window to front aspect. Door to kitchen. Stairs to landing. Radiator.

### Kitchen 11'7 x 8'1 (3.53m x 2.46m)

Upvc double glazed window and door to rear aspect. Range of base and wall units. Built in electric oven and hob and extractor fan. Part tiled walls. Sink and mixer tap. Wall mounted boiler.

### Landing

Doors to all rooms. Loft access.

### Bedroom One 11'9 x 10'1 (3.58m x 3.07m)

Upvc double glazed window to the front aspect. Radiator. Built in wardrobes.

### Bedroom Two 11'6 x 7'1 (3.51m x 2.16m)

Upvc double glazed window to rear aspect. Radiator.

### Bathroom

- Garage
- Laid to Lawn Garden

Upvc double glazed window to side aspect. Panelled bath with mixer tap. Part tiled walls. Pedestal sink and low level wc.

### To Front

Laid to lawn. Side access.

### To Rear

Fence surround. Laid to lawn. Patio.

### Garage

- Large Lounge
- Upvc Double Glazing

Parking for two vehicles in front. Up and over garage door.

### DIRECTIONS

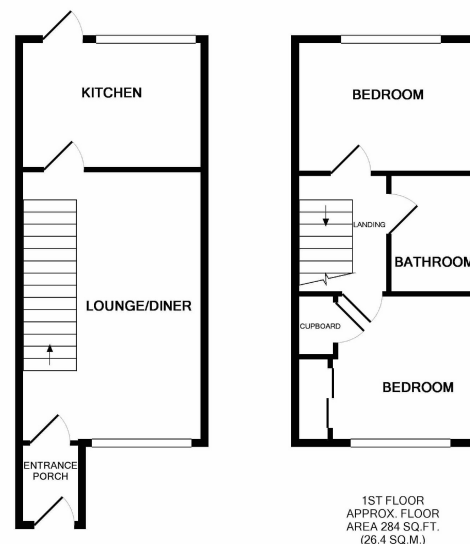
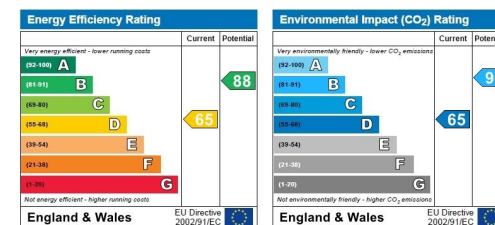

GROUND FLOOR  
APPROX. FLOOR  
AREA 304 SQ.FT.  
(28.2 SQ.M.)

TOTAL APPROX. FLOOR AREA 587 SQ.FT. (54.6 SQ.M.)

Whilst every attempt has been made to ensure the accuracy of the floor plan contained here, measurements of doors, windows, rooms and any other items are approximate and no responsibility is taken for any error, omission, or mis-statement. This plan is for illustrative purposes only and should be used as such by any prospective purchaser. The services, systems and appliances shown have not been tested and no guarantee as to their operability or efficiency can be given.

Made with Metropix ©2019