

Manor Court, 33 51 Manor Drive, Chorlton, M21 7JU



£75,000

******FOR SALE WITH 75% EQUITY Over 55's retirement apartment. ******

An attractive top floor apartment located on a quiet road, well placed for both Chorlton and Didsbury centres. Accommodation comprises briefly: communal lobby and hallway with lift to upper floors, private hallway, lounge/diner with balcony, fitted kitchen, two good sized bedrooms, bathroom. heating is via night storage heating and double glazing is installed. Well presented throughout.

There are attractive communal gardens and a private residents' car park is provided. Viewing of this splendid property is highly recommended. NO CHAIN

Communal Entrance

Stairs and lift to upper floors.

Entrance Hall

Cylinder and airing cupboard with shelving, night storage heater, intercom entry phone.

Lounge/Diner 14'0 x 13'4

Double glazed doors opening on to the balcony and overlooking the front gardens, warden call pull cord, night storage heater, archway too:

Kitchen 9'2 x 6'1

Fitted with base and wall mounted units, space for electric cooker with extractor hood over, single drainer sink unit with mixer tap, plumbing for washing machine, part tiled walls, double glazed window, space for fridge/freezer, electric light.

Bedroom One 13'7 x 8'9

Double glazed windows to the rear, night storage heater, built in wardrobe with mirrored doors.

Bedroom Two 9'11 x 6'4

Double glazed window with views over the rear, electric wall heater, built in wardrobe with sliding mirrored doors.

Bathroom 7'9 x 6'1

Fitted with a three piece suite comprising: panelled bath with electric shower, wash hand basin, low level wc, extractor fan, electric wall heater. Window to side aspect.

Externally

Attractive communal gardens to the front and rear of the property being mainly laid to lawn with established borders containing a variety of shrubs and flowering plants, paved patio and sitting areas.

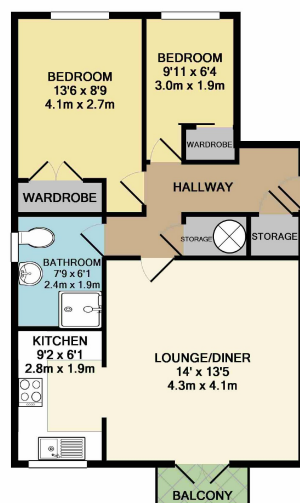

TOTAL APPROX. FLOOR AREA 553 SQ.FT. (51.4 SQ.M.)
Measurements are approximate. Not to scale. Illustrative purposes only.
Made with Metropix ©2019



CHORLTON Tel: 0161 860 4444 **DIDSBURY** Tel: 0161 445 4480 **DISLEY** Tel: 01663 767878 **GLOSSOP** Tel: 01457 858 888
HALE Tel: 0161 929 9797 **MACCLESFIELD** Tel: 01625 434 000 **MANCHESTER** Tel: 0161 833 9499 **NORTHERN QUARTER** Tel: 0161 833 9499
SALE Tel: 0161 962 2828 **SALFORD** Tel: 0161 833 9499 **WILMSLOW** Tel: 01625 532 000 **WHITHINGTON** Tel: 0161 438 2414



These particulars are believed to be accurate but they are not guaranteed and do not form a contract. Neither Jordan Fishwick nor the vendor or lessor accept any responsibility in respect of these particulars, which are not intended to be statements or representations of fact and any intending purchaser or lessee must satisfy himself by inspection or otherwise as to the correctness of each of the statements contained in these particulars.