



James *J* Laurence<sup>TM</sup>  
Sales and Lettings

APT 101, HEMISPHERE THE BOULEVARD, EDGBASTON, B5  
7SU  
ASKING PRICE OF £145,000





A superb first floor one bedroom apartment in the much sought after Hemisphere development.

The property boasts large picture windows and features under floor heating, nice touches in such a property, with accommodation benefitting from an open plan fitted kitchen/living area-completed with appliances of four ring hob, oven, fridge/freezer, washing machine and dishwasher, a modern bathroom, spacious bedroom with fitted wardrobe and the luxury of secure underground parking space.

Offered with no upward chain.



The development itself boasts the benefit of an on-site concierge, secure intercom access and an allocated underground parking space in a gated car park. Shopping amenities and the leisure facilities of Cannon Hill Park, as well as the MAC theatre, Edgbaston Cricket Ground and the Edgbaston Priory Club are all within a short walking distance, as well as there being fantastic transport and road links to the city centre provided by nearby Pershore and Bristol Roads, as well as the nearby University train station.

Hemisphere is ideally situated for working professionals desiring a short commute to Birmingham city centre, Queen Elizabeth hospital, Birmingham University and medical quarter, make it a property that is not to be missed for first time buyers, but it would also make the perfect investment for the savvy investor wishing to take advantage of the buoyant local marketplace.

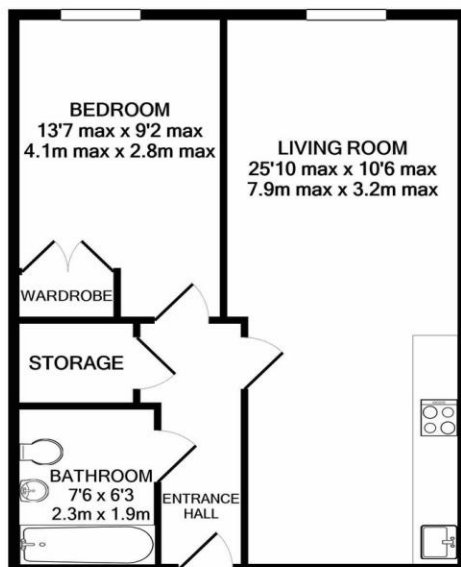

TOTAL APPROX. FLOOR AREA 501 SQ.FT. (46.5 SQ.M.)

Whilst every attempt has been made to ensure the accuracy of the floor plan contained here, measurements of doors, windows, rooms and any other items are approximate and no responsibility is taken for any error, omission, or mis-statement. This plan is for illustrative purposes only and should be used as such by any prospective purchaser. The services, systems and appliances shown have not been tested and no guarantee as to their operability or efficiency can be given

Made with Metropix ©2019