



3 BATHURST STREET,  
HYDE PARK, W2  
£875 Per week Fees Apply

T. +44 (0) 20 7935 0011  
E. [enquire@napierwatt.co.uk](mailto:enquire@napierwatt.co.uk)  
[WWW.NAPIERWATT.CO.UK](http://WWW.NAPIERWATT.CO.UK)

**NAPIER WATT**  
PROPERTY CONSULTANTS

A modern, split level (1st and 2nd floor three bedroom, three bathroom fully furnished flat with three bathrooms (two ensuite). The property offers 979 sqft / 90 sqm of accommodation and comprises a large open plan reception/kitchen and further benefits include a terrace. Conveniently placed opposite Lancaster Gate Hotel and the Tube Station. Independent gas central heating system.

Available from 05/02/18

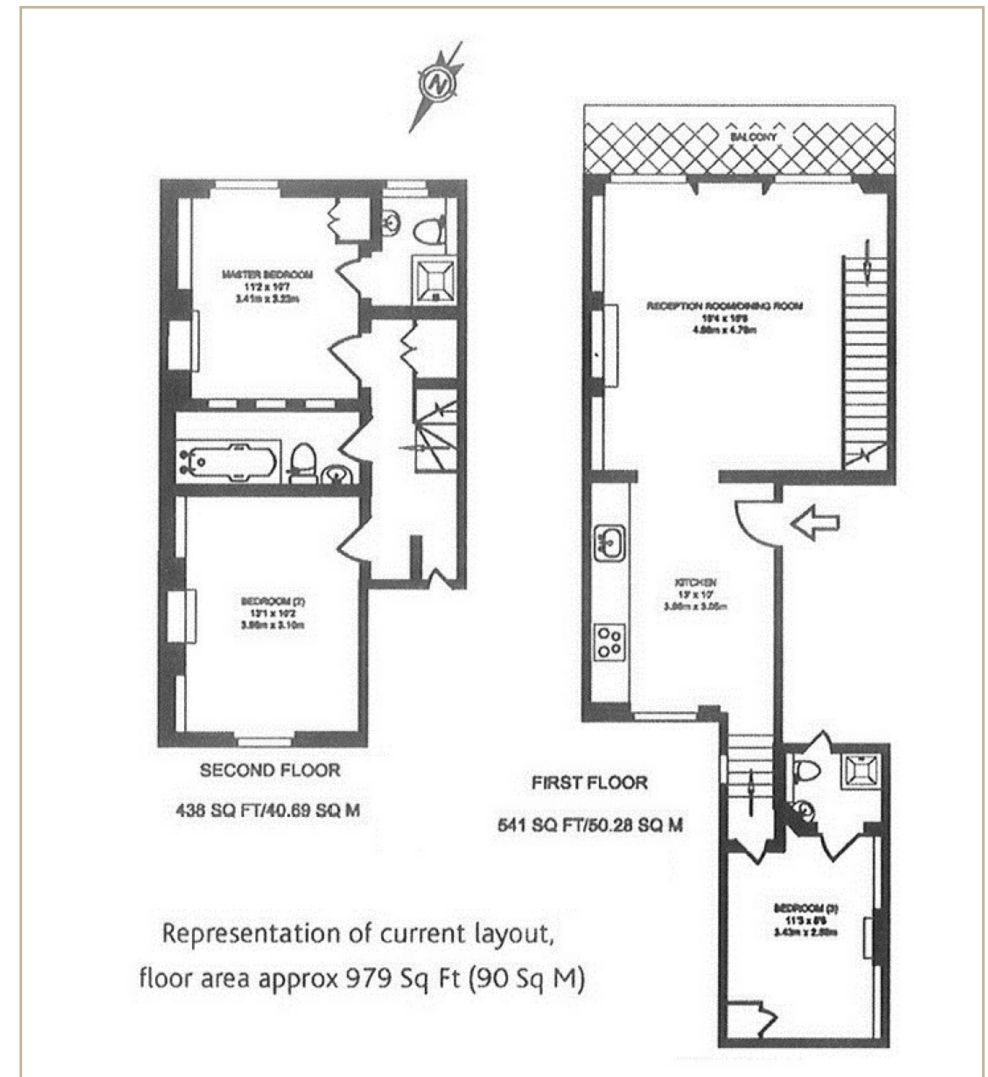

## Terms

Additional costs will apply for; referencing (£36 per person & guarantor); administration

**For Clarification** we wish to inform prospective purchasers that we have prepared these sales particulars as a general guide. We have not carried out a survey, nor tested the services, appliances and specific fittings. Room sizes are approximate and rounded: they are taken between internal wall surfaces and therefore include cupboards/shelves, etc. Accordingly, they should not be relied upon for carpets and furnishings. Formal notice is given that all fixtures and fittings, carpeting, curtains/blinds and kitchen equipment, whether fitted or not, are deemed to be removable by the vendor unless specifically itemised within these sales particulars.

T. +44 (0) 20 7935 0011  
E. [enquire@napierwatt.co.uk](mailto:enquire@napierwatt.co.uk)  
[WWW.NAPIERWATT.CO.UK](http://WWW.NAPIERWATT.CO.UK)

**NAPIER WATT**  
PROPERTY CONSULTANTS